

SPECIFICATION & FEATURES

90 DEG ANGLE EMT CONDUIT ELBOW

DESCRIPTION:

90 deg EMT elbow is manufactured from prime EMT conduit in accordance with the latest specifications and standards of ANSI C80.3 (UL797). The interior and exterior surface of elbows are free from defect with a smooth welded seam, and also are thoroughly and evenly coated with zinc using hot dip galvanizing process. Elbows are produced in normal trade sizes from 1/2" to 4" and used to connect the EMT conduit to change the way of the EMT conduit.



CERTIFICATION:

UL file E358011, Conforms to UL 514B



FEATURES:

- Galvanized Steel
- Meet UL 797 and ANSI C80.3

LINE DRAWINGS:

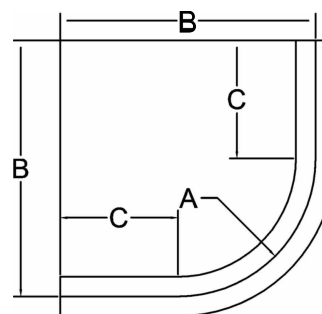

CONFIGURATION DATA:

Part No.	Trade Size	A (in)	B (in)	C (in)	Std.Pkg.
EEL90-50	1/2"	4.02	6.87	2.85	50
EEL90-75	3/4"	4.49	7.40	2.92	50
EEL90-100	1"	5.75	8.74	2.99	25
EEL90-125	1-1/4"	7.24	10.56	3.32	20
EEL90-150	1-1/2"	8.27	11.91	3.64	15
EEL90-200	2"	9.49	13.73	4.24	10
EEL90-250	2-1/2"	10.51	15.75	5.24	Bulk
EEL90-300	3"	12.99	19.13	6.14	Bulk
EEL90-350	3-1/2"	15.00	21.73	6.73	Bulk
EEL90-400	4"	15.98	23.10	7.12	Bulk

