

# DEWALT®

## ANCHORS & FASTENERS

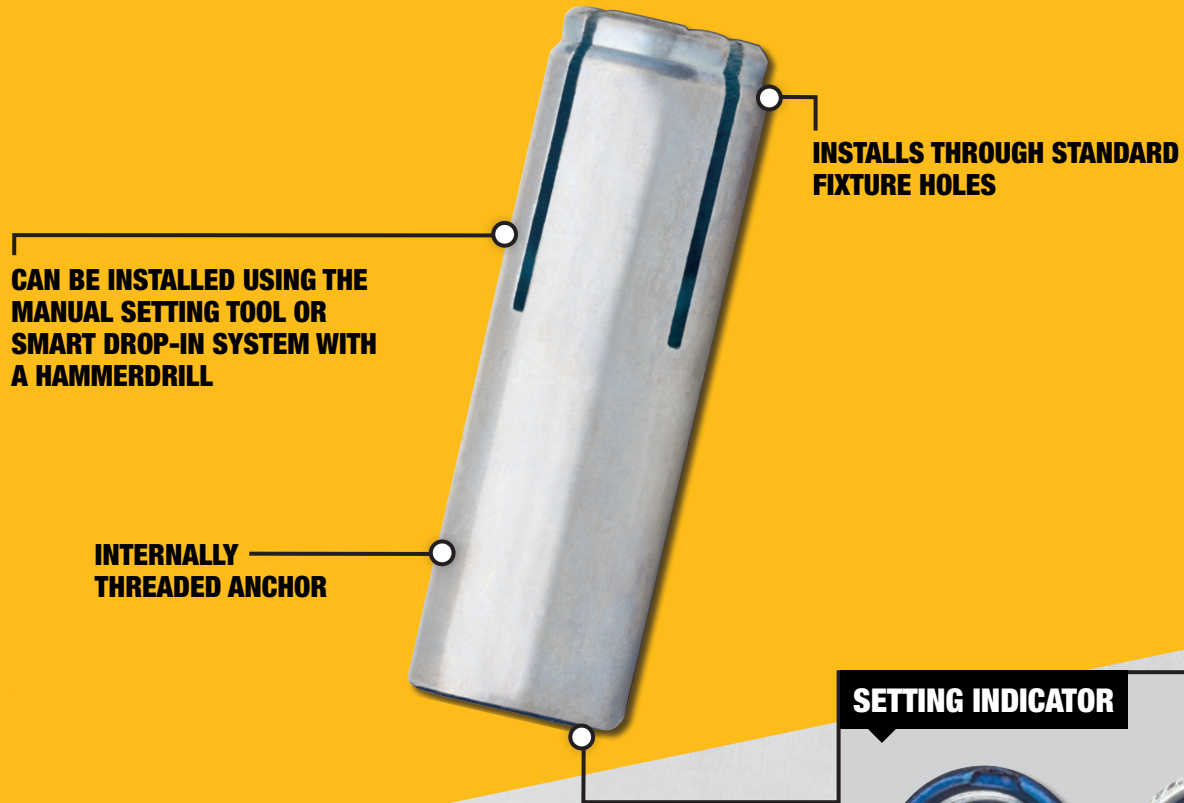

CAN BE INSTALLED USING THE  
MANUAL SETTING TOOL OR  
SMART DROP-IN SYSTEM WITH  
A HAMMERDRILL

INSTALLS THROUGH STANDARD  
FIXTURE HOLES

INTERNALLY  
THREADED ANCHOR

### SETTING INDICATOR

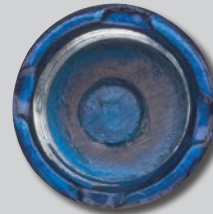

Before Setting



Properly Set

UNIQUE CROWN DESIGN CONFIRMS  
ANCHOR HAS BEEN PROPERLY SET WITH  
THE SETTING SYSTEM

### APPROVALS



Full FM & UL listings:  
[www.DEWALT.com](http://www.DEWALT.com)

### BASE MATERIALS



Normal  
Weight  
Concrete

### TYPICAL APPLICATIONS

- › Suspending conduit
- › Fire sprinkler
- › Cable trays and strut
- › Concrete formwork
- › Pipe supports
- › Suspended lighting

## INTERNALLY THREADED EXPANSION ANCHOR

## Smart DI™ System

### SMART DROP-IN

| CAT #  | ANCHOR SIZE | CTN | MSTR |
|--------|-------------|-----|------|
| 6304SD | 1/4"        | 100 | 1000 |
| 6306SD | 3/8"        | 50  | 500  |
| 6308SD | 1/2"        | 50  | 300  |

### DROP-IN TOOL

| CAT #   | SIZE | CTN | MSTR |
|---------|------|-----|------|
| 00425SD | 1/4" | 1   | 6    |
| 00427SD | 3/8" | 1   | 6    |
| 00429SD | 1/2" | 1   | 6    |

### DRILL

| CAT #   | SIZE                     | CTN | MSTR |
|---------|--------------------------|-----|------|
| 00391SD | 3/8" (for 1/4" Smart DI) | 1   | 12   |
| 00397SD | 1/2" (for 3/8" Smart DI) | 1   | 12   |
| 00410SD | 5/8" (for 1/2" Smart DI) | 1   | 12   |

### REPLACEMENT PARTS

| CAT #   | FITS TOOL | KIT CONTENTS                       |
|---------|-----------|------------------------------------|
| 00426SD | 00425SD   | Rubber Spring Plug, 2 Guide Screws |
| 00428SD | 00427SD   | Rubber Spring Plug, 2 Guide Screws |
| 00430SD | 00430SD   | Rubber Spring Plug, 2 Guide Screws |



## RELATED PRODUCTS



**DCH293R2DH**  
20V MAX\* XR® SDS PLUS  
ROTARY HAMMER W/DUST  
COLLECTION



**DCH273P2DH0**  
20V MAX\* XR® SDS PLUS ROTARY  
HAMMER W/ON-BOARD DUST  
EXTRACTOR



**HOLLOW DRILL BIT**  
SDS PLUS AND  
SDS MAX CARBIDE



**DWV012**  
10-GALLON HEPA/RRP  
WET/DRY DUST EXTRACTOR

\*For 20V MAX\* Maximum initial battery voltage (measured without a workload) is 20 volts. Nominal voltage is 18.

**1-800-4-DEWALT**

**www.DEWALT.com**

Copyright ©2021 DEWALT. The following are trademarks for one or more DEWALT power tools, accessories, anchors and concrete adhesives: The yellow and black color scheme; the "D"-shaped air intake grill; the array of pyramids on the handgrip; the kit box configuration; and the array of lozenge-shaped humps on the surface of the tool.

ICDWSMRTDISS