

Galvanized Rigid Conduit

YARD-LIGHT ELBOWS

TRADE SIZE	PIECES		WEIGHT LBS.		DIMENSIONS (REFER TO DIAGRAM) IN.				
	Per ctn.	Per 100	Per ctn.	A	B	C	D	E	
½	50	150	38	4	18	6 ¾	2 ¾	14	
¾	40	202	51	4 ½	18	6 ¾	2 ¼	13 ½	
1	25	316	79	5 ¾	18	8 ⅝	2 ⅞	12 ¼	
1¼	10	477	48	7 ¼	19 ¼	10 ¼	3 ¼	12 ¼	
1½	Bulk	609	—	8 ¼	20 ½	11 ⅝	3 ⅝	12 ¼	
2	Bulk	911	—	9 ½	21 ½	14 ½	5	12	
2½	Bulk	1530	—	10 ½	22 ½	16	5 ½	12	
3	Bulk	2279	—	13	25	19 ¼	6 ¼	12	
3½	Bulk	3082	—	15	27	22 ¾	7 ¾	12	
4	Bulk	3799	—	16	28	24	8	12	

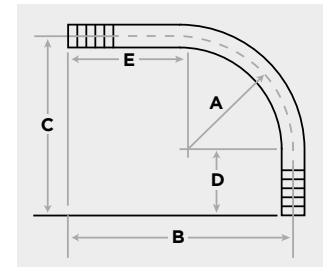

Tested and Certified for Safety
Our galvanized steel rigid elbows, couplings and nipples comply with the following standard: CSA C22.2 No. 45.1-07, to which it is Certified.



Tested and Listed for Safety
Our galvanized steel rigid elbows, couplings and nipples comply with the following standards: ANSI C80.1, federal specification WW-C-581 class 1 type A and UL-6, to which it is Listed.

Galvanized Rigid Conduit/IMC

SPEEDCOUPLE 90° ELBOWS

TRADE SIZE	MIN. RADIUS in.	OFFSET	STRAIGHT	WEIGHT PER ELBOW	WEIGHT PER ELBOW WITH COUPLING	STANDARD CARTON QTY.
				Each	Each	
2	9.5	14.54	5.04	6.70	7.58	5
2½	10.5	17.00	6.50	12.00	13.76	Bulk
3	13	19.67	6.67	19.00	20.98	Bulk
3½	15	22.72	7.72	28.00	30.65	Bulk
4	16	23.94	7.94	31.00	34.09	Bulk
5	24	34.90	10.90	68.00	71.97	Bulk

Note: SpeedCouple elbows shall be listed to UL standards UL-6 (elbow) and UL-514B (coupling). Elbows manufactured in accordance with ANSI C80.1.
Standard radius elbows: Available in 90°, 60°, 45°, 30°, 22½°, 15° and 11¼°.
Special radius elbows: Available in 90°, 60°, 45°, 30°, 22½°, 15° and 11¼°.

SPEEDCOUPLE IMC

TRADE SIZE	OD	ID	lbs./ft.	MASTER BUNDLES—10'		
				ft.	pieces	lbs.
2	2.360	2.150	2.42	800	80	1936
2½	2.857	2.557	4.28	400	40	1712
3	3.476	3.176	5.26	300	30	1578
3½	3.971	3.671	6.12	250	25	1530
4	4.466	4.166	6.82	200	20	1364

Note: SpeedCouple IMC shall be listed to UL standards UL-1242 (elbow) and UL-514B (coupling). Elbows manufactured in accordance with ANSI C80.6.

Aluminum Rigid Conduit

90° ELBOWS

TRADE SIZE	RADIUS** in.	OFFSET FIG. 1	STRAIGHT FIG. 2	WEIGHT* LBS.		STANDARD CARTON QTY.
				Per 100	Per ctn.	
½	4	6 ¾	1 ½	26	13	50
¾	4 ½	7 ⅞	1 ½	40	20	50
1	5 ¾	9 ½	1 ⅞	72	18	25
1¼	7 ¼	11 ⅝	2	105	21	20
1½	8 ¼	12 ⅜	2	153	23	15
2	9 ½	15 ½	2	210	21	10
2½*	10 ½	19 ¼	3	500	Bulk	Bulk
3*	13	21 ½	3 ⅞	800	Bulk	Bulk
3½*	15	24 ½	3 ¼	900	Bulk	Bulk
4*	16	25 ½	3 ⅞	1200	Bulk	Bulk
5*	24	37 ⅜	3 ⅝	2400	Bulk	Bulk
6*	30	49 ½	3 ¾	3800	Bulk	Bulk

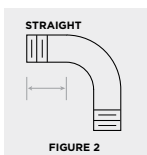
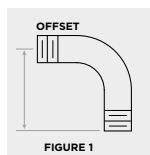

* Trade sizes 2½ and larger shipped in palletized cartons or bulk. Palletized and bulk elbows supplied with a thread protector on each end and UL and CSA label affixed.

** Minimum dimension per UL-6A.

COUPLINGS

TRADE SIZE	OUTSIDE DIAMETER in.	UL MIN. LENGTH* in.	WEIGHT LBS.		STANDARD CARTON QTY.
			Per 100	Per ctn.	
½	1.078	1 ⅝	6	6	100
¾	1.328	1 41/64	9	5	50
1	1.562	1 31/32	13	4	30
1¼	1.953	2 1/32	19	5	25
1½	2.219	2 1/16	23	6	25
2	2.750	2 ⅝	35	7	20
2½	3.281	3 ⅜	68	16	24
3	3.812	3 ⅜	91	15	16
3½	4.438	3 13/32	108	13	12
4	5.000	3 33/64	142	14	10
5	6.219	3 61/64	242	—	Bulk
6	7.312	4 ¼	320	—	Bulk

Couplings manufactured to UL-6A specifications.
*Minimum dimension per UL-6A.