

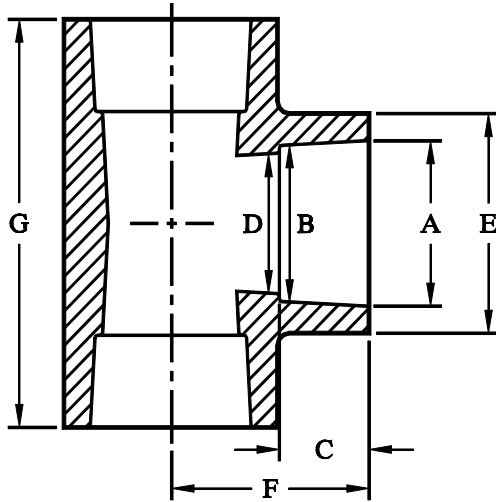

GEORG FISCHER  
PIPING SYSTEMS

GEORG FISCHER CENTRAL PLASTICS

39605 Independence, Shawnee, OK, 74804 | 1.800.654.3872 | www.gfcp.com



NOMINAL SIZE	A DIAMETER	B DIAMETER	C DEPTH	D I.D.	E O.D.	F LENGTH	G O.A.L.
1/2" CTS	.585 <sup>+0.010</sup> <sub>-.007</sub>	.575 <sup>+0.010</sup> <sub>-.007</sub>	.637	.524 ±.015	1.177 ±.032	1.31	2.63
	14.86 mm	14.61 mm	16.18 mm	13.31 mm	29.90 mm	33.3 mm	66.8 mm
1/2" IPS	.810 <sup>+0.005</sup> <sub>-.010</sub>	.804 <sup>+0.005</sup> <sub>-.026</sub>	.648	.694 ±.015	1.196 ±.032	1.31	2.66
	20.57 mm	20.42 mm	16.46 mm	17.63 mm	30.38 mm	33.3 mm	67.6 mm
3/4" IPS	1.020 ±.008	1.012 <sup>+0.008</sup> <sub>-.012</sub>	.732	.870 ±.015	1.493 ±.032	1.63	3.25
	25.91 mm	25.70 mm	18.59 mm	22.10 mm	37.92 mm	41.4 mm	82.6 mm
1" CTS	1.075 ±.008	1.070 <sup>+0.008</sup> <sub>-.012</sub>	.911	.892 ±.015	1.500 ±.032	1.63	3.26
	27.31 mm	27.18 mm	23.14 mm	22.66 mm	38.10 mm	41.4 mm	82.8 mm
1" IPS	1.275 ±.008	1.267 <sup>+0.008</sup> <sub>-.012</sub>	.755	1.128 ±.015	1.849 ±.032	1.69	3.41
	32.39 mm	32.18 mm	19.18 mm	28.65 mm	46.96 mm	43.0 mm	86.6 mm
1 1/4" IPS	1.620 ±.008	1.612 <sup>+0.008</sup> <sub>-.016</sub>	.982	1.452 ±.015	2.300 ±.032	2.10	4.22
	41.15 mm	40.94 mm	24.94 mm	36.88 mm	58.42 mm	53.3 mm	107.2 mm
1 1/2" IPS	1.860 ±.010	1.849 <sup>+0.010</sup> <sub>-.020</sub>	.970	1.717 ±.015	2.650 ±.032	2.34	4.67
	47.24 mm	46.96 mm	24.64 mm	43.61 mm	67.31 mm	59.4 mm	118.6 mm
2" IPS	2.335 ±.010	2.324 <sup>+0.010</sup> <sub>-.020</sub>	.971	2.135 ±.015	3.265 ±.020	2.78	5.40
	59.31 mm	59.03 mm	24.66 mm	54.23 mm	82.93 mm	70.6 mm	137.2 mm
3" IPS	3.455 ±.015	3.439 <sup>+0.015</sup> <sub>-.025</sub>	1.192	3.212 ±.130	5.250 ±.130	4.20	8.28
	87.76 mm	87.35 mm	30.28 mm	81.58 mm	133.35 mm	106.7 mm	210.3 mm
4" IPS	4.450 ±.015	4.434 ±.005	1.334	4.268 ±.130	6.525 ±.130	5.64	11.14
	113.03 mm	112.62 mm	33.88 mm	108.41 mm	165.74 mm	143.3 mm	283.0 mm