

GE
Industrial Solutions

Definite Purpose Contactors

25-40 FLA Standard





Overview

GE's full complement of definite purpose contactors (20A-150A) are utilized in a variety of industrial electric equipment. These include heating, ventilating, air conditioning, refrigeration, food processing and agricultural, in addition to numerous other applications. The new feature rich 25-40A, 3-pole version has the great performance you have come to expect from GE. All definite purpose components by GE meet industry standards including ARI780, UL, CSA and CE.

Features

- 25A, 30A, 40A FLA rated, 2, 3 & 4 Poles
- Optimal performance with double E magnet assembly
- Visual on/off status indication
- Variety of terminal choices allows diverse applications
- Universal mounting plates and DIN-rail options make change outs simple
- Snap-on accessories make modifications quick and easy
- Starters are available with Class 10 and Class 20 overloads
- Two-speed controllers incorporate a compact, integrated interlock

Ordering Information - DP Contactor



Select options in 7 through 11 for Standard Configurations

7	Ampere Rating
B	25A
C	30A
D	40A

8	Number of Poles
2	2 Poles
3	3 Poles
4	4 Poles

9	Contactors Coil Voltage
A	110-120V 60Hz
	110V 50Hz
B	208-240V 60Hz
	220V 50Hz
C	440-480V 60Hz
	380-415V 50Hz
D	575-600V 60Hz
	550V 50Hz
E	12V 50/60 Hz
F	277V 60Hz
H	24V 50/60Hz

10	Line Terminal
A	Binding Screw w/QC
B	Lug w/ Slotted Screw w/QC
C	Binding Screw
D	Lug with Slotted Screw
L	Sems Clamp w/QC ¹
M	Sems Clamp ¹
N	Lug w/ Hex Head Screw
P	Lug w/ Hex Head Screw w/QC

11	Load Terminal ²
A	Binding Screw w/QC
B	Lug w/ Slotted Screw w/QC
C	Binding Screw
D	Lug with Slotted Screw
L	Sems Clamp w/QC ¹
M	Sems Clamp ¹
N	Lug w/ Hex Head Screw
P	Lug w/ Hex Head Screw w/QC

¹Not available in 40 FLA

²To mount overload relay on contactor load terminal:
 - Select option "M", Sems Clamp for 25/30amp
 - Select option "D", Lug with Slotted Screw for 40amp

Add Options 12 through 16 for Customized Configurations

12	Auxiliary Contacts	Left	Right	Front
A	-	-	-	-
B	250 V	1 SPDT	-	-
C	250 V	-	1 SPDT	-
D	250 V	2 SPDT	-	-
E	250 V	-	2 SPDT	-
F	250 V	1 SPDT	1 SPDT	-
G	250 V	2 SPDT	2 SPDT	-
H	600 V	1 NO-NC	-	-
J	600 V	-	1 NO-NC	-
K	600 V	1 NO-NC	1 NO-NC	-
L	600 V	2 NO	-	-
M	600 V	-	2 NO	-
N	600 V	2 NO	2 NO	-
P	600 V	1 NO-NC	2 NO	-
Q	600 V	2 NO	1 NO-NC	-
R	600 V	-	-	1 NO
S	600 V	-	-	1 NC
T	600 V	-	-	1 NO-NC

13	Modification
0	None
1	Coil Rotated with Coil Terminals Down
3	DIN Rail Mounting Provision
4	Coil Rotated with Coil Terminals Down and DIN Rail Mounting Provision
5	Dummy Quick Connect Tabs on Coil
6	Coil Rotated with Coil Terminals Down and Dummy Quick Connect Tabs on Coil
8	Dummy Quick Connect Tabs on Coil and DIN Rail Mounting Provision
9	Coil Rotated with Coil Terminals Down and DIN Rail Mounting Provision and Dummy Quick Connect Tabs on Coil

14	Terminal Marking
A	Standard Terminal Marking
B	Inverse Terminal Marking
C	Reverse Terminal Marking
D	Without Terminal Marking

15	Special Marking
A	None
*	Customer Specific options assigned by Factory

16	Packaging
A	Single Pack
P	Bulk Pack - Minimum order quantity 96 pieces with multiples of 8 pieces

Ordering Bulk Packs? Just add A0AAP to the Standard Product Number.

Complete Product Numbers:

11 digits for Standard

16 digits for Customized

Omit digit 12 through 16, if the selection is "A0AAA"

DP Contactors Standard Product Numbers

FLA Amps	Coil Voltage	Terminals	Product No. 2 Pole	Product No. 3 Pole	Product No. 4 Pole
25A	24VAC	Binding Screw with QC	CR553AB2HAA	CR553AB3HAA	CR553AB4HAA
		Lug w/Slotted Screw w/QC	CR553AB2HBB	CR553AB3HBB	CR553AB4HBB
	110-120VAC	Binding Screw with QC	CR553AB2AAA	CR553AB3AAA	CR553AB4AAA
		Lug w/Slotted Screw w/QC	CR553AB2ABB	CR553AB3ABB	CR553AB4ABB
	208 - 240V	Binding Screw with QC	CR553AB2BAA	CR553AB3BAA	CR553AB4BAA
		Lug w/Slotted Screw w/QC	CR553AB2BBB	CR553AB3BBB	CR553AB4BBB
	277V	Binding Screw with QC	CR553AB2FAA	CR553AB3FAA	CR553AB4FAA
		Lug w/Slotted Screw w/QC	CR553AB2FBB	CR553AB3FBB	CR553AB4FBB

FLA Amps	Coil Voltage	Terminals	Product No. 2 Pole	Product No. 3 Pole	Product No. 4 Pole
30A	24VAC	Binding Screw with QC	CR553AC2HAA	CR553AC3HAA	CR553AC4HAA
		Lug w/Slotted Screw w/QC	CR553AC2HBB	CR553AC3HBB	CR553AC4HBB
	110-120VAC	Binding Screw with QC	CR553AC2AAA	CR553AC3AAA	CR553AC4AAA
		Lug w/Slotted Screw w/QC	CR553AC2ABB	CR553AC3ABB	CR553AC4ABB
	208 - 240V	Binding Screw with QC	CR553AC2BAA	CR553AC3BAA	CR553AC4BAA
		Lug w/Slotted Screw w/QC	CR553AC2BBB	CR553AC3BBB	CR553AC4BBB
	277V	Binding Screw with QC	CR553AC2FAA	CR553AC3FAA	CR553AC4FAA
		Lug w/Slotted Screw w/QC	CR553AC2FBB	CR553AC3FBB	CR553AC4FBB

FLA Amps	Coil Voltage	Terminals	Product No. 2 Pole	Product No. 3 Pole	Product No. 4 Pole
40A	24VAC	Binding Screw with QC	CR553AD2HAA	CR553AD3HAA	CR553AD4HAA
		Lug w/Slotted Screw w/QC	CR553AD2HBB	CR553AD3HBB	CR553AD4HBB
	110-120VAC	Binding Screw with QC	CR553AD2AAA	CR553AD3AAA	CR553AD4AAA
		Lug w/Slotted Screw w/QC	CR553AD2ABB	CR553AD3ABB	CR553AD4ABB
	208 - 240V	Binding Screw with QC	CR553AD2BAA	CR553AD3BAA	CR553AD4BAA
		Lug w/Slotted Screw w/QC	CR553AD2BBB	CR553AD3BBB	CR553AD4BBB
	277V	Binding Screw with QC	CR553AD2FAA	CR553AD3FAA	CR553AD4FAA
		Lug w/Slotted Screw w/QC	CR553AD2FBB	CR553AD3FBB	CR553AD4FBB



25A



30A



40A

Technical Data

- Ambient Operating Temperature: -25° C to 40° C
- Power Terminal
 - Pressure Type: 16-8 AWG, Torque: 20 in-lbs
 - Lug Type: 14-4 AWG, Torque: 40 in-lbs
- Coil Terminal
 - Pressure Type: 18-12 AWG, Torque: 10 in-lbs
- #6-32 Screws and Double 0.250 Quick Connect Terminals
- Coil is rated Class B (130° C) Insulation System

Standards and Listings

- UL60947-4-1a, UL File E1811 
- RoHS / REACH certified



25A with Overload Relay

Contact Data

FLA, A	Resistive amp per pole	Voltage, V	LRA, A	Single Phase (hp)	Three Phase (hp)
25	35	120	150	2	-
		240	150	3	7.5
		480	125	-	10
		600	100	-	10
30	40	120	180	2	-
		240	180	5	10
		480	150	-	15
		600	120	-	15
40	50	120	240	3	-
		240	240	7.5	10
		480	200	-	20
		600	160	-	20

Coil Data

Nominal Coil voltage VAC	Frequency	FLA	Poles	12	24	110-120	208-240	277	440-480	550-600
Maximum pickup voltage	60Hz	25 / 30 / 40A	2, 3 & 4	9.6	18	88	177	220	352	440
Drop-out voltage range		25 / 30 / 40A	2, 3 & 4	4.2	6 - 15	20 - 70	50 - 165	65 - 185	150 - 270	192 - 336
Nominal inrush VA	60Hz	25 / 30 A	2, 3	44	44	44	44	44	44	44
		40 A	3	100	100	100	100	100	100	100
		25 / 30 / 40A	4	100	100	100	100	100	100	100
	50Hz	25 / 30 A	2, 3	53	53	53	53	-	53	53
		40 A	3	120	120	120	120	-	120	120
		25 / 30 / 40A	4	120	120	120	120	-	120	120
Nominal sealed VA	60Hz	25 / 30 A	2, 3	5.6	5.6	5.6	5.6	5.6	5.6	5.6
		40 A	3	9.5	9.5	9.5	9.5	9.5	9.5	9.5
		25 / 30 / 40A	4	9.5	9.5	9.5	9.5	9.5	9.5	9.5
	50Hz	25 / 30 A	2, 3	6.8	6.8	6.8	6.8	-	6.8	6.8
		40 A	3	11.4	11.4	11.4	11.4	-	11.4	11.4
		25 / 30 / 40A	4	11.4	11.4	11.4	11.4	-	11.4	11.4

Accessories - Overload¹

Class 10 - Overload

Current Range	Maximum Fuse	Maximum Circuit Breaker Rating Amps	Product Number
0.16-0.26	1	15	RT1B
0.25-0.41	1	15	RT1C
0.4-0.65	3	15	RT1D
0.65-1.1	6	15	RT1F
1-1.5	6	15	RT1G
1.3-1.9	6	15	RT1H
1.8-2.7	10	15	RT1J
2.5-4.1	15	15	RT1K
4-6.3	20	15	RT1L
5.5-8.5	25	15	RT1M
8.0-12.0	40	30	RT1N
10.0-16.0	50	35	RT1P
14.5-18	60	40	RT1S
17.5-22	70	50	RT1T
21-26	80	60	RT1U
25-32	100	80	RT1V
30-40	100	80	RT1W

¹Factory assembled DP starters (CR554 series) are available. Please refer to the Control catalog, GEP-1260 for more information.

Class 20 - Overload

Current Range	Maximum Fuse	Maximum Circuit Breaker Rating Amps	Product Number
2.5-4.1	15	15	RT12K
4-6.3	20	15	RT12L
5.5-8.5	25	15	RT12M
8.0-12.0	40	30	RT12N
10.0-16.0	50	35	RT12P
14.5-18	60	40	RT12S
17.5-22	70	50	RT12T
21-26	80	60	RT12U
25-32	100	80	RT12V
30-40	100	80	RT12W

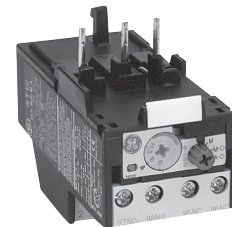

Overload Relay

Accessories – Auxiliary Contact Kits

Type	Mounting	Circuit	Product Number	Rating
250 VAC Auxiliary Contact	Side	1 SPDT	CR553XC211	11 A, 1/3 HP at 250 VAC; 1/2 A at 125 VDC; 1/4 A at 250 VDC
	Side	2 SPDT	CR553XC222	
600 VAC Auxiliary Contact	Front	1 NO	BCLF10	A600, Q600 Pilot Duty
	Front	1 NC	BCLF01	
	Side	1 NO, 1 NC	BCLL11	
	Side	2 NO	BCLL20	
Mechanical Interlock ²	-	2 NC	BEL02 includes 2 built-in NC contacts	A600, Q600 Pilot Duty

²Factory assembled DP 2-speed contactors (CR555 series) are available. Please refer to the Control catalog, GEP-1260 for more information.

Spare Coils

Coil Voltage	Product Number	
	2/3 Pole 25-30FLA	2/3 Pole 40FLA 4 Pole 25-40FLA
110-120V 50/60Hz	CRDB1AA	CRDB3AA
208-240V 50/60Hz	CRDB1AB	CRDB3AB
440-480V 60Hz	CRDB1AC	CRDB3AC
380-415V 50Hz		
550-600V 50/60Hz	CRDB1AD	CRDB3AD
12V 50/60Hz	CRDB1AE	CRDB3AE
277V 60Hz	CRDB1AF	CRDB3AF
24V 50/60Hz	CRDB1AH	CRDB3AH

Enclosure Kits NEMA Type 1

Contactor Prefix	Device	Rating	Product Number
CR553A	DP Contactors	25A-40A, 2-4 Pole	CR553XE1A
CR554A	DP Starters	25A-30A	CR553XE1A
CR554A	DP Starters	40A	CR553XE1B



250V Auxiliary Contact Kits



Side-Mount 600V Auxiliary Contact Block



Front-Mount 600V Auxiliary Contact Block

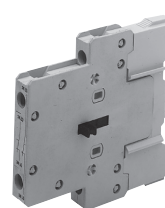

Mechanical Interlock



Enclosure Kit

Outline Drawings

Approximate Dimensions in (mm)

Mounting Dimensions

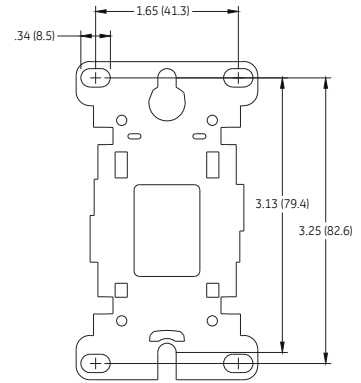
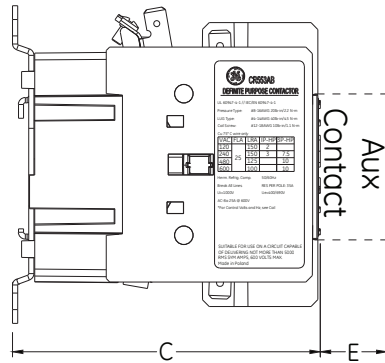
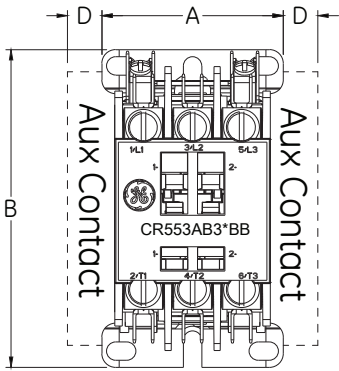

Amp	Poles	A	B	C	D		E
					250V	600V	
25, 30Amp	2, 3	2.07 (53)	3.75 (96)	3.50 (89)	0.55 (14)	0.28 (7)	1.1 (28)
40 Amp	2, 3	2.24 (57)	3.75 (96)	4.02 (102)	0.71 (18)	0.43 (11)	1.1 (28)
25 / 30 / 40Amp	4	2.24 (57)	4.00 (101)	4.02 (102)	0.71 (18)	0.43 (11)	1.1 (28)

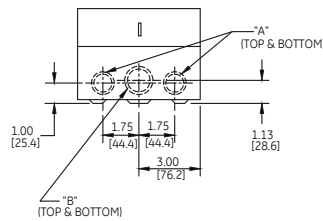
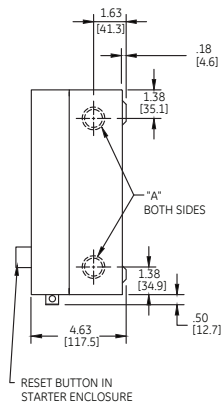
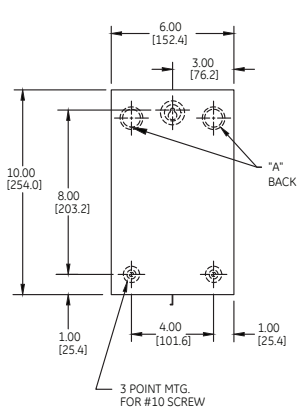

"A" Combination Knockouts For 1/2 OR 3/4-inch Conduit
 "B" Combination Knockouts For 3/4 or 1-Inch Conduit

Enclosure CR553XE1A

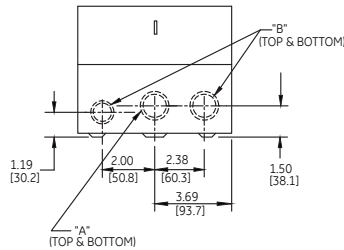
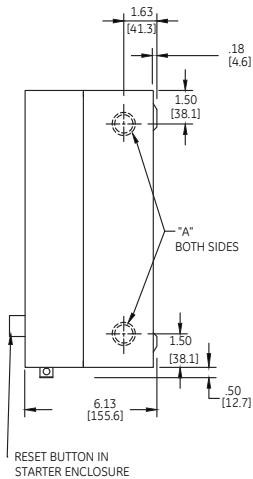
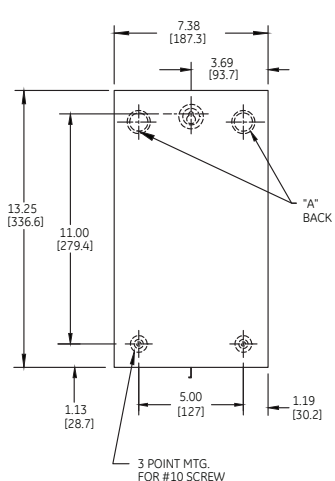

"A" Combination Knockouts For 1/2 OR 3/4-inch Conduit
 "B" Combination Knockouts For 3/4 or 1-Inch Conduit

Enclosure CR553XE1B

Refer to Control Catalog GEP-1260 for detailed DP contactors, assembled DP starters, 2-speed contactor versions.

Visit our Definite Purpose Contactor information page at
www.geindustrial.com/products/contactors/definite-purpose-contactors



GE
Industrial Solutions
41 Woodford Avenue
Plainville, CT 06062
1-800-431-7867
www.geindustrial.com

Information provided is subject to change without notice. Please verify all details with GE. All values are design or typical values when measured under laboratory conditions, and GE makes no warranty or guarantee, express or implied, that such performance will be obtained under end-use conditions.
©2015, General Electric Company and/or its affiliates. All rights reserved.

8.15 DET-833C