

FEATURES

A high performance 6" LED luminaire, engineered for New Construction, Remodel or Retrofit to accommodate insulated or dropped ceiling installations. It is easily installed and is supplied with a remote driver. It's small aperture and shallow depth make it an ideal choice for unlimited applications.

LUMENS	700, 900
CCT	27K, 30K, 35K, 40K, 50K
CRI	90+
COLOR QUALITY	3 Step MacAdam Ellipses
TRIM	Bronze, Black, Chrome, Copper, Satin Nickel
FINISH	White
DIMMING	DIMTR (Triac)
LIFETIME	50,000 Hours

- Dimmable
- ETL Approved and Energy Star Certified
- Air-tight and wet location approved
- Pot light housing is not required even for insulated ceilings
- Fast and easy to install in limited space locations
- External driver factory mounted inside connector box
- New construction rough-in plates and jumper cables available
- Available in 4 Color Temperatures (2700K, 3000K, 4000K and 5000K)
- 50,000 Hours Life
- Ambient Temperature: -40°F (-40°C) To +104°F (+40°C)
- Wattages: 12W and 15W
- Default Driver Voltage: 120V AC 60 Hz (Dimmable)

NOMINAL LUMENS	DELIVERED LUMENS	WATTAGE
700	788	14W
900	1013	15W

Based on 4000K, 90+ CRI. Actual wattage may vary +/- 5%

EXAMPLE: **RL675-900L-DIMTR-120-30K-90-WH-RL675-RT-BZ**

TYPE	LUMEN	CCT	CRI	FINISH	RING TRIM	OPTIONS
RL675	<input type="checkbox"/> 700L-DIMTR-120 <input type="checkbox"/> 900L-DIMTR-120	<input type="checkbox"/> 27K <input type="checkbox"/> 30K <input type="checkbox"/> 35K <input type="checkbox"/> 40K <input type="checkbox"/> 50K	<input type="checkbox"/> 90+	<input type="checkbox"/> WH (White)	<input type="checkbox"/> RL675-RT-BZ (Bronze) <input type="checkbox"/> RL675-RT-BK (Black) <input type="checkbox"/> RL675-RT-CH (Chrome) <input type="checkbox"/> RL675-RT-CP (Copper) <input type="checkbox"/> RL675-RT-SN (Satin Nickel)	<input type="checkbox"/> RL-ACC-SLIM-1-10F <input type="checkbox"/> RL-ACC-SLIM-1-20F <input type="checkbox"/> RL-ACC-SLIM-6-Roughplate <input type="checkbox"/> RL-UNV-4/5/6



OPTIONS



RL-ACC-SLIM-1-10F
10-ft long extension



RL-ACC-SLIM-1-20F
20-ft long extension

MOUNTING

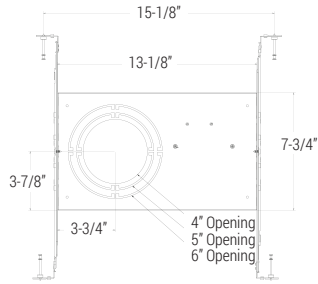
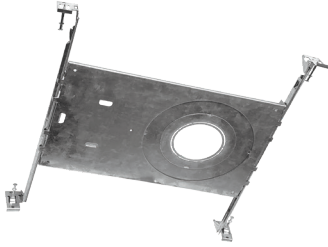

RL-UNV-4/5/6
Multi- size: 4", 5", 6"
new construction pre-mounting plate with collar for use with screw down "C" style remodel housings

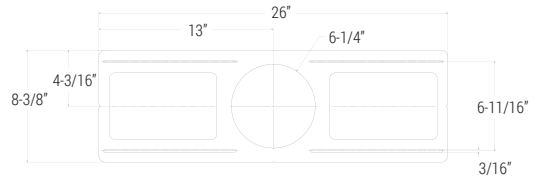

RL-ACC-SLIM-6-ROUGHPLATE
The MP3 is a 6" new construction pre-mounting plate with collar for use with screw down "C" style remodel housings

COLOR INSERTS



RL675-RT-BZ
(Bronze)



RL675-RT-BK
(Black)



RL675-RT-CH
(Chrome)



RL675-RT-CP
(Copper)



RL675-RT-SN
(Satin Nickel)

RL675-700L-DIMTR-120-35K-90-BK

TEST NO.: **EL09051928**

INPUT WATTS: **14.3065** LUMENS: **789** CRI: **90** EFFICACY: **55** CCT: **3500K** SPACING CRITERIA: **1.18**

Candle Power Distribution (Candelas)

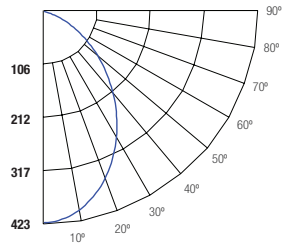

Zonal Lumens Summary

Zone	Lumens	%Lamp	%Fixt
0-20	148.51	18.80	18.80
0-30	301.08	38.20	38.20
0-40	465.01	59.00	59.00
0-60	716.44	90.90	90.90
0-80	787.77	99.90	99.90
0-90	787.80	99.90	99.90

Luminance (Average candela/M²)

Angle in Degrees	Average		
	0°	45°	90°
45	87858	90162	94045
55	66339	69264	73710
65	41179	44953	50339
75	8570	12644	19481
85	79	79	79

Lumens Per Zone

Zone	Lumens
0-10	39.59
10-20	108.92
20-30	152.57
30-40	163.93
40-50	145.43
50-60	105.99
60-70	57.59
70-80	13.74
80-90	0.03

Candela Tabulation

0	5	15	25	35	45	55	65	75	85	90
0	422.31	417.51	384.07	326.78	255.88	181.49	111.16	50.84	6.48	0.02
5	417.51	384.07	326.78	255.88	181.49	111.16	50.84	6.48	0.02	0.03
15	384.07	326.78	255.88	181.49	111.16	50.84	6.48	0.02	0.03	
25	326.78	255.88	181.49	111.16	50.84	6.48	0.02	0.03		
35	255.88	181.49	111.16	50.84	6.48	0.02	0.03			
45	181.49	111.16	50.84	6.48	0.02	0.03				
55	111.16	50.84	6.48	0.02	0.03					
65	50.84	6.48	0.02	0.03						
75	6.48	0.02	0.03							
85	0.02	0.03								
90	0.03									

Coefficients of Utilization - Zonal Cavity Method
Effective Floor Cavity Reflectance 0.20

ROOM CAVITY RATIO	RC		80%				70%				50%				30%				10%				0%			
	RW	70%	50%	30%	10%	70%	50%	30%	10%	50%	30%	10%	50%	30%	10%	50%	30%	10%	50%	30%	10%	0%				
0	119	119	119	119	119	116	116	116	116	111	111	111	106	106	106	102	102	102	100	100	100	100				
1	111	107	104	101	101	109	105	102	99	101	98	96	97	95	93	94	92	91	91	89	89	89				
2	103	96	90	86	86	100	94	89	85	91	86	83	88	84	81	85	82	79	77	77	77	77				
3	95	86	79	74	74	93	85	78	73	82	76	72	79	74	71	77	73	69	67	67	67	67				
4	88	78	70	64	64	86	76	69	64	74	68	63	72	66	62	70	65	61	59	59	59	59				
5	82	70	62	56	56	80	69	62	56	67	61	56	65	59	55	63	58	54	53	53	53	53				
6	76	64	56	50	50	74	63	55	50	61	55	50	60	54	49	58	53	49	47	47	47	47				
7	71	58	51	45	45	69	58	50	45	56	49	45	55	49	44	54	48	44	42	42	42	42				
8	66	54	46	41	41	65	53	46	41	52	45	40	51	45	40	50	44	40	38	38	38	38				
9	62	50	42	37	37	61	49	42	37	48	41	37	47	41	37	46	40	36	35	35	35	35				
10	58	46	39	34	34	57	46	39	34	45	38	34	44	38	34	43	37	33	32	32	32	32				

Cone of Light

(FT) Distance to Plane	(FC) Initial Footcandle at Nadir	(FT) Beam Vert. Spread	(FT) Beam Horiz. Spread
2	106	3.6	3.6
4	26.4	7.2	7.2
6	11.7	10.8	10.8
8	6.6	14.4	14.3
10	4.22	18	17.9
12	2.93	21.6	21.5

BEAM DIA. MEASURED AT 50% OF NADIR F.C.

RL675-900L-DIMTR-120-30K-90-SN

TEST NO.: **EL11191959**

INPUT WATTS: **14.8543** LUMENS: **1014** CRI: **90** EFFICACY: **68** CCT: **3000K** SPACING CRITERIA: **1.18**

Candle Power Distribution (Candelas)

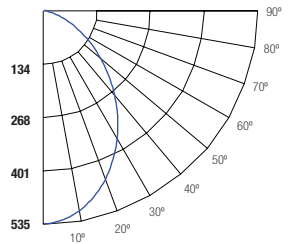

Zonal Lumens Summary

Zone	Lumens	%Lamp	%Fixt
0-20	187.79	18.50	18.50
0-30	381.22	37.60	37.60
0-40	589.93	58.20	58.20
0-60	914.52	90.20	90.20
0-80	1012.64	99.90	99.90
0-90	1012.67	99.90	99.90

Luminance (Average candela/M²)

Angle in Degrees	Average		
	0°	45°	90°
45	111235	113558	119222
55	85078	88283	94806
65	55774	59816	67089
75	15143	19548	29996
85	79	79	79

Lumens Per Zone

Zone	Lumens
0-10	50.04
10-20	137.75
20-30	193.42
30-40	208.72
40-50	186.64
50-60	137.95
60-70	77.72
70-80	20.40
80-90	0.03

Candela Tabulation

0	5	15	25	35	45	55	65	75	85	90
0	533.67	526.77	483.20	411.02	322.37	229.78	142.56	68.86	11.45	0.02
5	526.77	483.20	411.02	322.37	229.78	142.56	68.86	11.45	0.02	0.03
15	483.20	411.02	322.37	229.78	142.56	68.86	11.45	0.02	0.03	
25	411.02	322.37	229.78	142.56	68.86	11.45	0.02	0.03		
35	322.37	229.78	142.56	68.86	11.45	0.02	0.03			
45	229.78	142.56	68.86	11.45	0.02	0.03				
55	142.56	68.86	11.45	0.02	0.03					
65	68.86	11.45	0.02	0.03						
75	11.45	0.02	0.03							
85	0.02	0.03								
90	0.03									

Coefficients of Utilization - Zonal Cavity Method
Effective Floor Cavity Reflectance 0.20

ROOM CAVITY RATIO	RC		80%				70%				50%				30%				10%				0%			
	RW	70%	50%	30%	10%	70%	50%	30%	10%	50%	30%	10%	50%	30%	10%	50%	30%	10%	50%	30%	10%	0%				
0	119	119	119	119	119	116	116	116	116	111	111	111	106	106	106	102	102	102	100	100	100	100				
1	111	107	104	101	101	108	105	102	99	101	98	96	97	95	93	93	92	90	90	88	88	88				
2	103	96	90	85	85	100	94	89	84	91	86	82	87	84	81	84	81	79	77	77	77	77				
3	95	86	79	73	73	92	84	78	73	81	76	71	79	74	70	76	72	69	67	67	67	67				
4	88	77	69	64	64	85	76	69	63	73	67	62	71	66	62	69	65	61	59	59	59	59				
5	81	70	62	56	56	79	69	61	56	67	60	55	65	59	55	63	58	54	52	52	52	52				
6	75	64	55	50	50	74	63	55	49	61	54	49	59	53	49	58	52	48	46	46	46	46				
7	70	58	50	45	45	69	57	50	44	56	49	44	54	48	44	53	48	43	42	42	42	42				
8	66	53	46	40	40	64	53	45	40	51	45	40	50	44	40	49	44	39	38	38	38	38				
9	62	49	42	37	37	60	49	41	37	48	41	36	47	41	36	46	40	36	34	34	34	34				
10	58	46	38	34	34	57	45	38	33	44	38	33	43	37	33	43	37	33	31	31	31	31				

Cone of Light

(FT) Distance to Plane	(FC) Initial Footcandle at Nadir	(FT) Beam Vert. Spread	(FT) Beam Horiz. Spread
2	133	3.6	3.6
4	33.4	7.3	7.3
6	14.8	10.9	10.9
8	8.34	14.5	14.6
10	5.34	18.2	18.2
12	3.71	21.8	21.8

BEAM DIA. MEASURED AT 50% OF NADIR F.C.