

MIXING VALVES



"Apollo" Valves
manufactured in the USA
by CONBRACO Industries





A history of **Quality, Service** and **Innovation**

Now in its ninth decade, Conbraco Industries, Inc. is a leading manufacturer of flow control products for U.S. and international markets. The company's headquarters is based in Matthews, North Carolina with manufacturing plants and foundries located in Pageland and Conway, South Carolina.

Conbraco has a history of new product development and innovation that dates back to the company's inception in 1928. Today, the Conbraco line of products is marketed under the "Apollo Valves" brand and includes: ball valves, butterfly valves, backflow prevention devices, water pressure reducing valves, mixing valves, safety relief valves, water gauges, strainers, vacuum breakers, valve actuators and more.

Conbraco's vertically integrated manufacturing ensures a consistency of production, testing, quality and availability. It's your assurance that Conbraco flow control products will deliver long term performance advantages. All Conbraco plants are registered to ISO 9001:2008 quality standards.

The Conbraco line continues to expand - with new products, designs and advanced materials - to better serve the needs of our customers in the chemical processing, pulp and paper, petroleum, residential and commercial plumbing and heating markets, as well as manufacturing and other markets.



PAGELAND, SC
Bronze Foundry and Manufacturing Plant



PAGELAND, SC
Final Assembly and Distribution Center



CONWAY, SC
Steel Foundry and Manufacturing Plant



MATTHEWS, NC
Corporate Headquarters



Throughout this catalog, products that have a Lead Free* option will be identified with this logo.



* LEAD FREE: The wetted surfaces of this product shall contain no more than 0.25% lead by weighted average. Complies with CA AB1953, VT Act 193, MD HB372, LA HB471 and Federal Public Law 111-380.

APOLLO MIXING VALVES ...

Your Best Choice For Value And Protection

No matter how big or small your job, you can trust Apollo® thermostatic mixing valves to provide all the value and Code-compliant performance you're looking for.

Conserving energy and assuring safe use of our water systems by those who depend on them has grown increasingly important in recent years. Government at every level is working with our industry to enhance and improve the safety of our hot water supplies. This brochure addresses the use of Apollo® mixing valves to protect water users and extend energy efficiency.

A PROPER BALANCE

Maintaining proper water temperature in hot water supply systems is critical. Water stored and delivered at too high a temperature puts users at risk of scalding. But maintaining water at too low a temperature presents other risks. It can turn a tank or piping system into a breeding ground for bacteria – potentially harmful to water users young and old. Delivering water at the optimum temperature is exactly what our Apollo® thermostatic mixing valves are designed to do.

FOR EVERY JOB

Our Apollo® family of mixing valves includes ASSE certified products to meet all your point-of-source and point-of-use requirements. We also offer a full range of non-ASSE models designed specifically for the higher temperatures associated with hydronic and radiant heating systems. And they're built to resist corrosion. All valves feature a high-copper-content all bronze body and heavy duty stainless steel springs. Our mixing valves offer fingertip control of water temperatures up to 180°F and the convenience of easy in-line servicing.



TABLE OF CONTENTS

| | |
|---|--------------|
| Introduction | 3 |
| Hydronic Tempering Valves | |
| 34-200 Series | 5 |
| Point of Source ASSE 1017 Mixing Valves | |
| 34A Series | 6-7 |
| 34A-H Series | 6-7 |
| Commercial High Capacity Mixing Valves | |
| 34C Series | 8 |
| 34C High Temperature..... | 8 |
| Point of Use ASSE 1070/1017 Mixing Valves | |
| 34B Series | 9-10 |
| 34D "Mini" Series | 11 |
| Hi/Lo Mixing Valve - ASSE 1069/1017 | |
| 34HL Series | 12-13 |
| Emergency Eye Wash/Face Wash | |
| Mixing Valve 34E..... | 14-15 |
| Mixing Valves Application Chart | 16-17 |
| Typical Mixing Valve Piping Schematic..... | 18 |

HYDRONIC TEMPERING VALVES

34-200 SERIES



The Apollo® Model TV (34-200 Series) thermostatic mixing valve provides non-ASSE extension of water heater capacity and hot water temperature control in hydronic heating systems. Available in low or high temperature options for floor or baseboard applications.

FEATURES

- Low temperature range 85°-120°F (-L1 suffix)
- High temperature range 120°-180°F (-01 suffix)
- Stainless steel spring
- Corrosion resistant bronze body
- Thermoplastic shuttle assembly
- Solder connections are standard
- In-line repairable
- Fingertip temperature control
- **Made in USA - ARRA compliant**

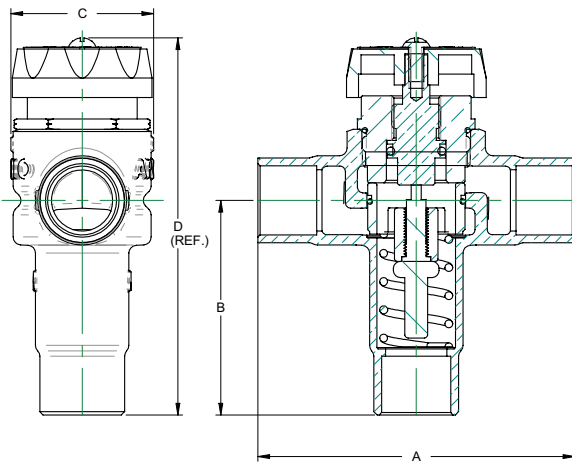

| Part No. Low Temp 85° - 120° F | Part No. High Temp 120° - 180° F | Connection | Size (in.) | Dimensions | | Weight Lbs. |
|--------------------------------------|--|------------|---------------|------------|-------|----------------|
| | | | | Height | Width | |
| 34203L1 | 3420301 | Solder | 1/2 | 4.45 | 3.75 | 1.4 |
| 34204L1 | 3420401 | Solder | 3/4 | 4.47 | 4.00 | 1.5 |

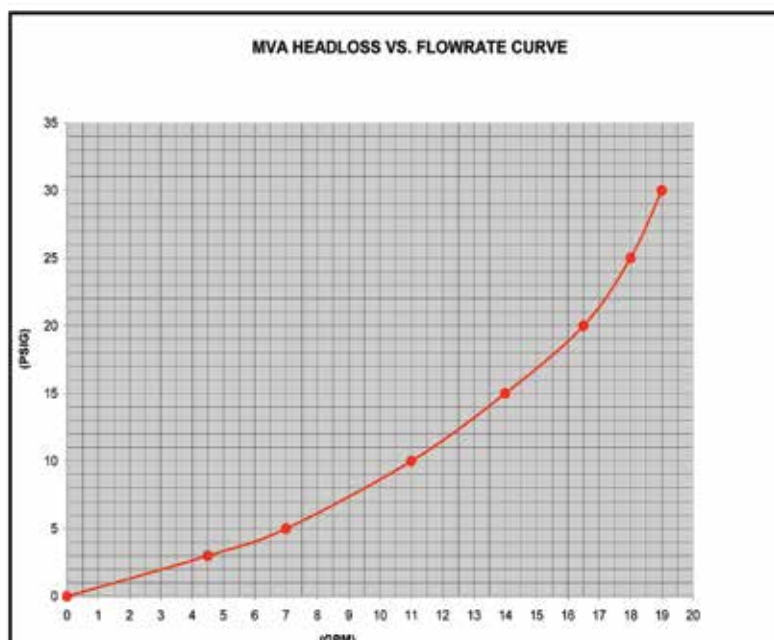

ASSE 1017 Point of Source Mixing Valves

MVA (34A) Series/MVAH Hydronic Series



The Apollo MVA thermostatic master mixing valves are designed for ASSE 1017 "point of source" applications. They provide reliable hot water temperature control of potable and hydronic hot water distribution systems.

FEATURES

- Superior thermostatic element technology for optimal performance, reliability and accuracy
- Integral inlet strainers and check valves are standard to protect against cross-flow and foreign particles in the piping system
- Thermostat over-temperature control
- Maximum temperature limit option
- Fingertip temperature control
- Cold or hot water supply failure shut-off protection
- Multiple connection options to fit your specific needs
- High temperature version for hydronic/radiant heating applications
- Standard materials of construction meet the requirements of the EPA Safe Drinking Water Act
- Lead free option available - specify model 34ALF
- **Made in USA - ARRA compliant**

APPROVALS

- ASSE 1017 - Temperature Actuated Mixing Valve for Hot Water Distribution Systems
- CSA B125.3 - Plumbing Supply Fittings

PERFORMANCE RATING

- | | |
|--|-------------------------|
| • Maximum working pressure | 150 psig (1034 kPa) |
| • Maximum working temperature | 210°F (99°C) |
| • Cold water inlet temperature range | 39-80°F (4 - 27°C) |
| • Hot water inlet temperature range | 120 - 200°F (49 - 82°C) |
| • Minimum flow rate | 1/2 gpm (1.9 lpm) |
| • Mixed water temperature range | 130 - 180°F (54 - 82°C) |
| • Mixed water temperature tolerance | ±5°F (1.7°C) |
| • Cv rating | 3.9 |
| • Flow rate at 30 psid(138kPa) | 19 gpm (64 lpm) |
| • Maximum pressure differential between hot & cold | 25% |

MATERIAL

- | | |
|----------|---|
| Body: | ASTM B584 Bronze |
| Shuttle: | Noryl® Modified PPO (Polyphenylene Oxide) |
| Sensor: | Copper/Wax filled |
| O-ring: | Chloramine Resistant EPDM |
| Spring: | ASTM A313 Stainless Steel |
| Cap: | ABS (Acrylonitrile Butadiene Styrene) |

OPTIONS

Max Temperature Adjustment Setting (B suffix)

Preset to 120°F maximum temperature

High Temp Range (H) Radiant Heat Application

120°F-180°F (Not ASSE Certified)

See 34A-H submittal sheet

Lead Free construction certified 0.25% lead max.

Model 34ALF

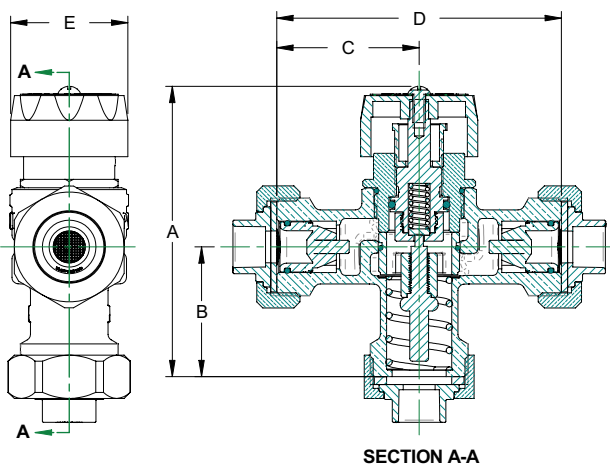

MIXING VALVES

ASSE 1017 Point of Source Mixing Valves*

MVA (34A) Series/MVAH Hydronic Series

| Model Number | Lead Free Model# | Order Number | Lead Free Order # | Connection Type | Dimensions (in.) | | | | | | Unit Wt. (lbs) |
|--------------|------------------|--------------|-------------------|-----------------|------------------|------|------|------|------|------|----------------|
| | | | | | A | B | C | D | E | F | |
| MVA12 | MVA12-LF | 34A213T | 34ALF213T | 1/2" FNPT | 3.73 | 2.11 | 2.28 | 4.56 | 1.87 | 0.73 | 2.8 |
| MVA34 | MVA34-LF | 34A214T | 34ALF214T | 3/4" FNPT | | | | | | 0.77 | 2.8 |
| MVA1 | MVA1-LF | 34A215T | 34ALF215T | 1" FNPT | | | | | 2.12 | 0.94 | 2.9 |
| MVAS12 | MVAS12-LF | 34A213S | 34ALF213S | 1/2" Solder | 3.73 | 2.11 | 2.28 | 4.56 | 1.87 | 0.81 | 2.5 |
| MVAS34 | MVAS34-LF | 34A214S | 34ALF214S | 3/4" Solder | | | | | | 0.81 | 2.6 |
| MVAS1 | MVAS1-LF | 34A215S | 34ALF215S | 1" Solder | | | | | 2.12 | 0.94 | 2.7 |
| MVAC12 | MVAC12-LF | 34A213C | 34ALF213C | 1/2" CPVC | 3.73 | 2.11 | 2.28 | 4.56 | 1.87 | 0.58 | 2.4 |
| MVAC34 | MVAC34-LF | 34A214C | 34ALF214C | 3/4" CPVC | | | | | | 0.80 | 2.4 |
| MVAC1 | MVAC1-LF | 34A215C | 34ALF215C | 1" CPVC | | | | | 2.12 | 1.09 | 2.5 |
| MVAX12 | MVAX12-LF | 34A213X | 34ALF213X | 1/2" PEX | 3.73 | 2.11 | 2.28 | 4.56 | 1.87 | 0.83 | 2.5 |
| MVAX34 | MVAX34-LF | 34A214X | 34ALF214X | 3/4" PEX | | | | | | 0.83 | 2.6 |
| MVAX1 | MVAX1-LF | 34A215X | 34ALF215X | 1" PEX | | | | | 2.12 | 1.04 | 2.7 |

| Size & Connection | Standard 85° - 120°F | | | | 120°F Adjustment Limit Stop | | | | High Temp (120°F-180°F)* | |
|-------------------|----------------------|--------------|-------------------|-------------------|-----------------------------|--------------|-------------------|-------------------|--------------------------|--------------|
| | Order Number | Model Number | Lead Free Order # | Lead Free Model # | Order Number | Model Number | Lead Free Order # | Lead Free Model # | Order Number | Model Number |
| 1/2" FNPT | 34A213T | MVA12 | 34ALF213T | MVA12-LF | 34A213BT | MVAB12 | 34ALF213BT | MVAB12-LF | 34A213HT | MVAH12 |
| 3/4" FNPT | 34A214T | MVA34 | 34ALF214T | MVA34-LF | 34A214BT | MVAB34 | 34ALF214BT | MVAB34-LF | 34A214HT | MVAH34 |
| 1" FNPT | 34A215T | MVA1 | 34ALF215T | MVA1-LF | 34A215BT | MVAB1 | 34ALF215BT | MVAB1-LF | 34A215HT | MVAH1 |
| 1/2" Solder | 34A213S | MVAS12 | 34ALF213S | MVAS12-LF | 34A213BS | MVABS12 | 34ALF213BS | MVABS12-LF | 34A213HS | MVAHS12 |
| 3/4" Solder | 34A214S | MVAS34 | 34ALF214S | MVAS34-LF | 34A214BS | MVABS34 | 34ALF214BS | MVABS34-LF | 34A214HS | MVAHS34 |
| 1" Solder | 34A215S | MVAS1 | 34ALF215S | MVAS1-LF | 34A215BS | MVABS1 | 34ALF215BS | MVABS1-LF | 34A215HS | MVAHS1 |
| 1/2" CPVC | 34A213C | MVAC12 | 34ALF213C | MVAC12-LF | 34A213BC | MVABC12 | 34ALF213BC | MVABC12-LF | 34A213HC | MVAHC12 |
| 3/4" CPVC | 34A214C | MVAC34 | 34ALF214C | MVAC34-LF | 34A214BC | MVABC34 | 34ALF214BC | MVABC34-LF | 34A214HC | MVAHC34 |
| 1" CPVC | 34A215C | MVAC1 | 34ALF215C | MVAC1-LF | 34A215BC | MVABC1 | 34ALF215BC | MVABC1-LF | 34A215HC | MVAHC1 |
| 1/2" PEX | 34A213X | MVAX12 | 34ALF213X | MVAX12-LF | 34A213BX | MVABX12 | 34ALF213BX | MVABX12-LF | 34A213HX | MVAHX12 |
| 3/4" PEX | 34A214X | MVAX34 | 34ALF214X | MVAX34-LF | 34A214BX | MVABX34 | 34ALF214BX | MVABX34-LF | 34A214HX | MVAHX34 |
| 1" PEX | 34A215X | MVAX1 | 34ALF215X | MVAX1-LF | 34A215BX | MVABX1 | 34ALF215BX | MVABX1-LF | 34A215HX | MVAHX1 |

* Hydronic models 34A-H/MVAH not covered by ASSE Standards.

MVA Headloss VS. Flow Rate Curve

FLOW CURVE

Flow curve is based on the following: Cold and hot water inlet pressures at 45 psig; cold water supply temperature at 55 ±5°F; hot water supply temperature at 140 ±5°F; and mixed water temperature at 105 ±5°F.

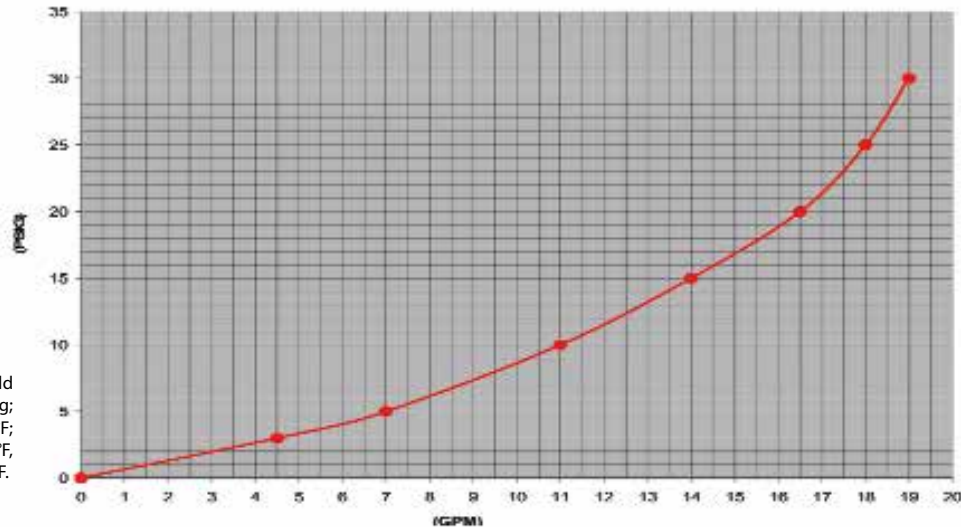

Commercial High Capacity Mixing Valves

MVC (34C Series)



3/4" - 1"

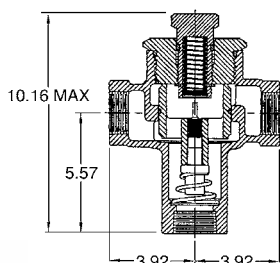

34C-104/34C-105

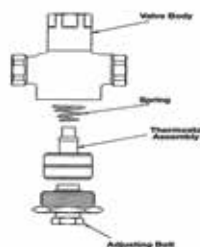

1-1/4" - 2"

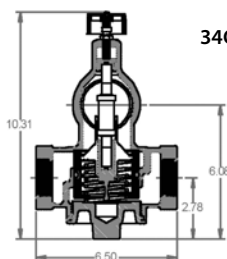
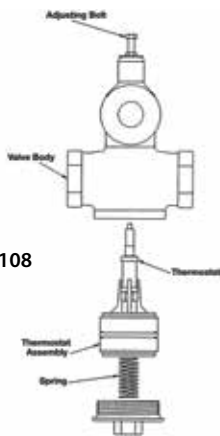

34C-106/34C-108

ORDERING NUMBERS

| Size (in.) | Part No. Standard Temp. 90° - 140° F | Part No. High Temp. 130° - 180° F |
|------------|--|---|
| 3/4 | 34C-104-01 | 34C-104-H1 |
| 1 | 34C-105-01 | 34C-105-H1 |
| 1-1/4 | 34C-106-01 | 34C-106-H1 |
| 1-1/2 | 34C-107-01 | 34C-107-H1 |
| 2 | 34C-108-01 | 34C-108-H1 |

The Apollo® Model MVC (34C Series) ASSE 1017 listed, high-capacity mixing valves are thermostatically controlled regulating valves designed for use in large commercial and institutional "point of source" and hydronic hot water systems or applications. Simple adjustment of water temperature from 90°-140°F or 130°-180°F.

FEATURES

- Sizes 3/4", 1", 1-1/4", 1-1/2", 2" FNPT
- Standard temp range 90°-140°F (-01 suffix)
- High temp range 130°-180°F (use suffix "H1") for hydronic/radiant heating systems
- Highest flow rates in its class, up to 165 gpm
- Threaded connections
- All-bronze and stainless steel construction
- Patented design for easy in-line maintenance
- Supply pressures to 150 psig
- U.S. Patent #6,328,219
- ASSE 1017 listed
- CSA B125.3 "Plumbing Fittings"
- **Made in USA - ARRA compliant**

SPECIAL FEATURES

Selected Apollo 34C mixing valves feature a two-piece shuttle with integral over-travel spring so they're smaller and easier to install than other high-capacity valves. Plus their patented snap-fit element retainer and shuttle with special finger-grip pads assure easy removal and servicing without the need for special tools.

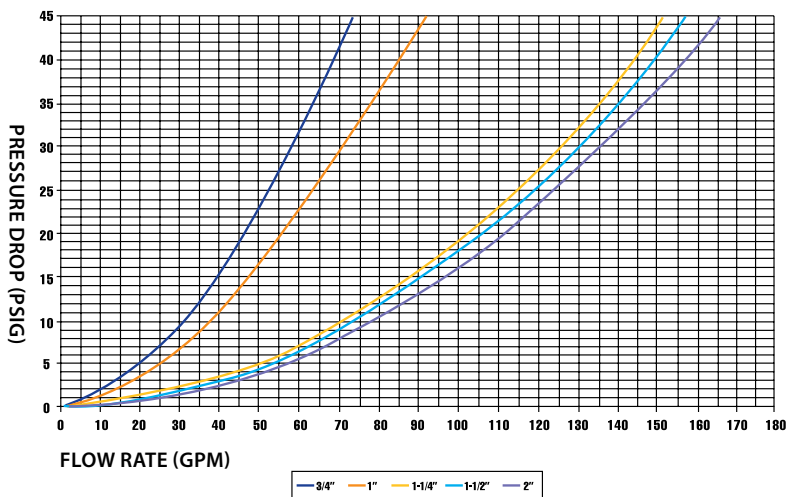

ASSE 1070/1017 Point of Use Mixing Valves

MVB (34B Series)



The Apollo® Model “MVB” (34B Series) thermostatic mixing valves are designed to control and limit the volumes of cold and hot water required to deliver mixed water at a predetermined temperature either from the “point of source” or “point of use” application for single or multiple fixtures. **Lead Free** valves are available with various end connections.

FEATURES

- Highest capacity that meets ASSE 1070
- Superior thermostatic element technology for optimum reliability, dependability and accuracy
- Integral strainers and check valves provide protection against cross-flow and foreign particles
- Thermostat over-temperature protection
- Tamper resistant locking cap feature
- Maximum temperature setting adjustment
- Meets the requirements of the EPA Safe Drinking Water Act
- Instantaneous cold or hot water supply failure shut-off protection
- Multiple connection options to fit your specific needs
- Lead free option available - specify model 34BLF
- **Made in USA - ARRA compliant**

APPROVALS

- ASSE 1017 - Temperature Actuated Mixing Valve for Hot Water Distribution Systems
- ASSE 1070 - Water Temperature Limiting Device
- CSA B125.3 - Plumbing Supply Fittings

PERFORMANCE RATING

| | |
|--|-------------------------|
| Maximum supply pressure | 150 psig (1034 kPa) |
| Maximum working temperature | 210°F (99°C) |
| Hot water inlet temperature range | 120 - 180°F (49 - 82°C) |
| Mixed water temperature range | 80 - 120°F (27 - 49°C) |
| Mixed water temperature tolerance | ± 3°F (1.7°C) |
| Minimum flow rate | 1.5 gpm (5.7 lpm) |
| Maximum pressure differential between hot & cold | 25% |
| Minimum inlet/outlet temperature differential | 15°F |

MIXING VALVES

ASSE 1070/1017 Point of Use Mixing Valves

MVB (34B Series) cont.

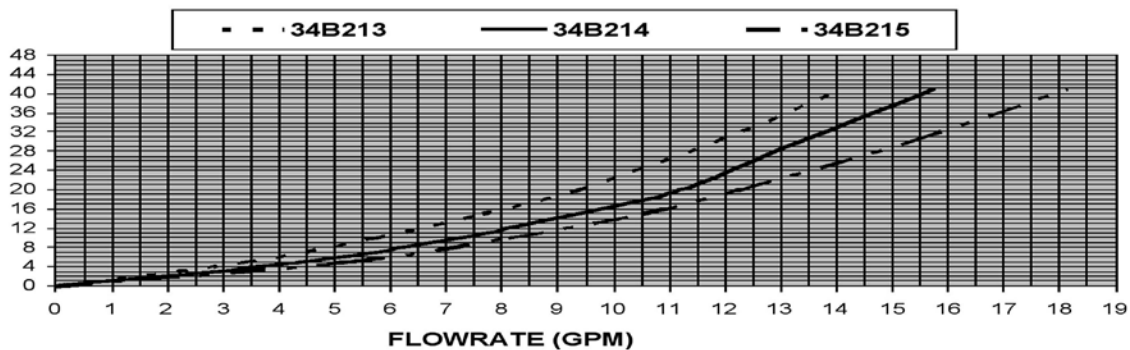
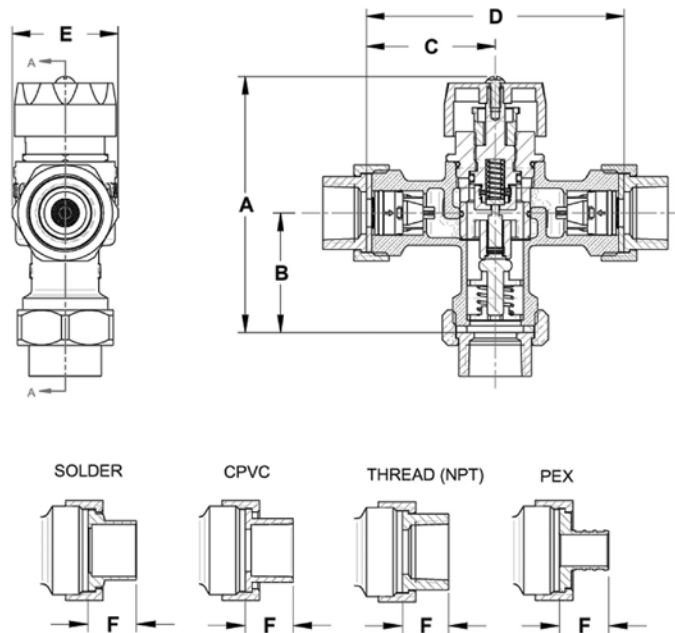

| Model Number | Lead Free Model # | Order Number | Lead Free Order # | Connection Type | A | B | C | D | E | F | Unit Wt. (lbs) |
|--------------|-------------------|--------------|-------------------|-----------------|------|------|------|------|------|------|----------------|
| MVB12 | MVB12-LF | 34B213T | 34BLF213T | 1/2" FNPT | 4.52 | 2.11 | 2.28 | 4.56 | 1.87 | 0.73 | 2.8 |
| MVB34 | MVB34-LF | 34B214T | 34BLF214T | 3/4" FNPT | 4.52 | 2.11 | 2.28 | 4.56 | 1.87 | 0.77 | 2.8 |
| MVB1 | MVB1-LF | 34B215T | 34BLF215T | 1" FNPT | 4.52 | 2.11 | 2.28 | 4.56 | 2.12 | 0.94 | 2.9 |
| MVBS12 | MVBS12-LF | 34B213S | 34BLF213S | 1/2" Solder | 4.52 | 2.11 | 2.28 | 4.56 | 1.87 | 0.81 | 2.5 |
| MVBS34 | MVBS34-LF | 34B214S | 34BLF214S | 3/4" Solder | 4.52 | 2.11 | 2.28 | 4.56 | 1.87 | 0.81 | 2.6 |
| MVBS1 | MVBS1-LF | 34B215S | 34BLF215S | 1" Solder | 4.52 | 2.11 | 2.28 | 4.56 | 2.12 | 0.94 | 2.7 |
| MVBC12 | MVBC12-LF | 34B213C | 34BLF213C | 1/2" CPVC | 4.52 | 2.11 | 2.28 | 4.56 | 1.87 | 0.58 | 2.4 |
| MVBC34 | MVBC34-LF | 34B214C | 34BLF214C | 3/4" CPVC | 4.52 | 2.11 | 2.28 | 4.56 | 1.87 | 0.80 | 2.4 |
| MVBC1 | MVBC1-LF | 34B215C | 34BLF215C | 1" CPVC | 4.52 | 2.11 | 2.28 | 4.56 | 2.12 | 1.09 | 2.5 |
| MVBX12 | MVBX12-LF | 34B213X | 34BLF213X | 1/2" PEX | 4.52 | 2.11 | 2.28 | 4.56 | 1.87 | 0.83 | 2.5 |
| MVBX34 | MVBX34-LF | 34B214X | 34BLF214X | 3/4" PEX | 4.52 | 2.11 | 2.28 | 4.56 | 1.87 | 0.83 | 2.6 |
| MVBX1 | MVBX1-LF | 34B215X | 34BLF215X | 1" PEX | 4.52 | 2.11 | 2.28 | 4.56 | 2.12 | 1.04 | 2.7 |

MIXING VALVES

ASSE 1070 Point of Use “Mini Mixer” Valves

MVD (34D Series)

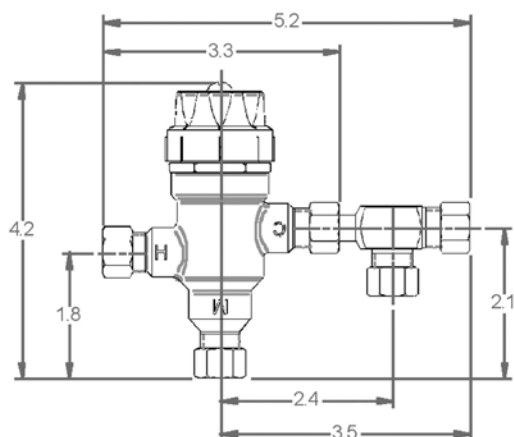

The Apollo® MVD (34D Series) Mini Thermostatic mixing valves are designed for ASSE 1070 “Point of Use” temperature control applications with a single fixture using proven ASTM grade materials. These valves will hold a desired temperature within $\pm 3^{\circ}\text{F}$ and will shut off flow in the event of hot or cold water failure. They come equipped with a tamper-resistant high temperature limit stop to prevent adjustment above 120°F .

FEATURES

- Tamper resistant locking control knob
- Adjustable maximum temperature limit stop
- Crush proof integral check valves
- Hot/cold water failure protection
- Single outlet model for sensor faucets
- Bypass fitting option for dual fixture faucets
- Satin chrome plating option
- 3/8" compression or hose connections
- Mounting bracket included
- Lead free option available - specify model 34DLF
- **Made in the USA - ARRA compliant**

PERFORMANCE RATING

| | |
|---|------------------|
| Outlet temperature range | (85°F - 120°F) |
| Maximum pressure: | 125 psig |
| Maximum inlet temperature: | 210°F |
| Minimum supply pressure | 30 psi (207 kpa) |
| Minimum inlet/outlet temperature differential | 15°F |
| Maximum hot/cold pressure differential | 25% |

APPROVALS

- ASSE 1070 - “Performance Requirements for Water Temperature Limiting Devices
- CSA B125.3 - “Plumbing Fittings”

| Model Number | Lead Free Model # | Order Number | Lead Free Order # | Description | Weight |
|--------------|-------------------|--------------|-------------------|---------------------------|--------|
| MVD | MVD-LF | 34D30201 | 34DLF30201 | 3/8" Single Outlet Bronze | .82 |
| MVDR | MVDR-LF | 34D30217 | 34DLF30217 | 3/8" Single Outlet Chrome | .82 |
| MVDB | MVDB-LF | 34D302B1 | 34DLF302B1 | 3/8" Double Outlet Bronze | 1.0 |
| MVDBR | MVDBR-LF | 34D302B17 | 34DLF302B17 | 3/8" Double Outlet Chrome | 1.0 |

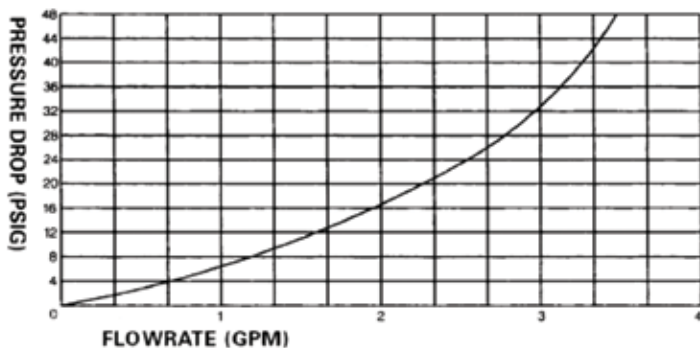

Hi/Lo Mixing Valve – ASSE 1069/1017

34HL Series



The 34HL Mixing Valve uses proven Apollo thermostatic control to produce a consistent mix of water from low through high flow range.

This single assembly controls mixed water temperatures to multiple-outlet shower and sink installations. It's the ideal choice in new construction or retrofits in nursing homes, prisons, hospitals, schools, gymnasiums, airports and other facilities where constant safe water temperature needs to be maintained at several outlets without the use of independent ASSE 1016 shower valves.

FEATURES

- The Apollo 34HL is an advanced Thermostatic Mixing Valve capable of maintaining safe, consistent temperature control of water at low and high flows to within $\pm 3.6^{\circ}\text{F}$.
- The 34HL will provide consistent temperature control at flow rates as high as 60 GPM and as low as 1.5 GPM, including mid-range flow between high and low.
- This high quality Apollo valve performs its function without requiring recirculation pumps like other systems in order to achieve low flow control.
- Integral strainers and checks are provided at the hot and cold supply inlets for greater reliability and performance.
- These cast bronze thermostatic mixing valves are manufactured to the same exacting standards that have made the Apollo name famous for durability and reliability.
- **Made in USA - ARRA compliant**

OPERATION

- The 34HL design is patented with a variable fluid flow assembly and dual thermal actuated controls for either low or high flow conditions.
- The passages are calibrated to control water temperature during all flow conditions without a "dead zone" between low and high flow.
- The 34HL also provides fluid shutoff as required by ASSE 1069 in the case that either the hot or cold supply lines fail (or are shut off for any reason) to prevent scalding.
- The valve can be tamper-resistant to limit the water temperature from exceeding safe conditions as required by ASSE 1069.
- The valve also meets the requirements of ASSE 1017 for Point of Source Applications.

| Product Specifications | |
|-------------------------------------|---------------------|
| Maximum Static Pressure | 150 psig (1034 kpa) |
| Maximum Water Temperature | 200° F (93° C) |
| Minimum Flow ASSE 1069 & 1017 | 1.5 gpm (5.7 lpm) |
| Temperature Adjustment Range | 90° F - 140° F |
| Maximum Inlet Pressure Differential | 30 psi (207kpa) |
| Inlet Connection | 1" NPT |
| Outlet Connection | 1-1/4" NPT |
| Temperature Gauge (1) | 0-200°F |
| Pressure Gauge (3) | 0-160 psi |
| Shipping Weight | 36 lbs |

This device will service end use fixture fittings, including but not limited to, gang showers and sitz baths, by supplying tempered water at a preset temperature through a single supply pipe and will meet ASSE standard 1069-2005. ASSE 1069 devices are designed to reduce the risk of scalding and thermal shock during changes in hot or cold water supply pressure or temperature, or loss of cold water supply.

Hi/Lo Mixing Valve - ASSE 1069/1017

34HL Series

United States Patent US 6,929,188 B2

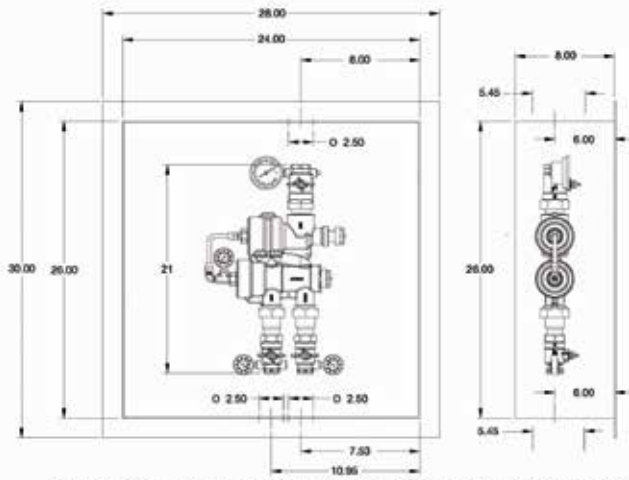

Figure 1: Typical Valve Dimensions with Stainless Steel Recessed Cabinet Option

STANDARD APPROVALS

ASSE 1069-Automatic Temperature Control Mixing Valves

This device will control outlet water temperature to individual or multiple fixtures within 3.6°F to reduce the risk of scalding or thermal shock. This device is intended to be installed where the bather has no access to the temperature adjustment, and where no further mixing occurs downstream of the device.

The Apollo 34HL ATC will meet the performance requirements of ASSE 1069 at flow as low as 1.5 GPM up through maximum flow rate.

ASSE 1017-Temperature Actuated Mixing Valves for Hot Water Distribution Systems

This device will control outlet set water temperature to hot water distribution systems near the hot water source within 3°F below 2 GPM and within 5°F above 5 GPM.

OPTIONS:

- 34HL10517 - Nickel plated automatic temperature controller
- 34HLBOX01 - Cabinet, flush mount, SS
- 34HLBOX02 - Cabinet, flush mount, CS powder coat
- 34HLBOX03 - Cabinet, wall mount, SS
- 34HLBOX04 - Cabinet, wall mount, CS powder coat

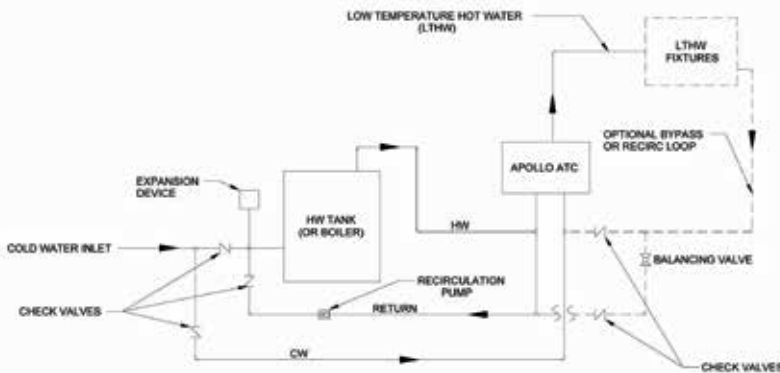

Figure 2: Typical Installation with Optional Recirculation loop

Flow Capacity

| Model | Min. Flow to ASSE 1069 | Pressure Drop Across Valve | | | |
|-----------|------------------------|----------------------------|------------------|------------------|------------------|
| | | 10 psi (69 kpa) | 20 psi (138 kpa) | 30 psi (207 kpa) | 45 psi (310 kpa) |
| 34HL10501 | 1.5 gpm | 22 gpm | 42 gpm | 52 gpm | 60 gpm |
| | 6 lpm | 83 lpm | 159 lpm | 197 lpm | 227 lpm |

Emergency Eye Wash/Face Wash Mixing Valve

MVE (34 E Series)



The Apollo® Model "MVE" (34E Series) emergency mixing valves are designed to control the cold and hot water temperature to deliver tepid water at a predetermined temperature to emergency eyewash/facewash fixtures. The device provides a precise temperature and flow control in the event of cold water, hot water and thermostatic element failures.

FEATURES

- Hot and cold water supply failure protection patented design (US Patent 6,926,20 B2)
- Tepid water temperature limit control and adjustment
- Tepid water temperature adjustment handle with locking mechanism for tamper-resistant protection and inadvertent adjustment
- Integral inlet check valves and strainers to provide protection against cross-flow and foreign particles
- Superior thermostatic element technology for optimum reliability, dependability and accuracy
- Thermostatic element failure and over-travel protection
- High efficiency and positive shut-off check valves
- In-line accessibility and serviceability of failure protection module and mixing valve internal components
- Meets the requirements of the EPA Safe Drinking Water Act
- Corrosion resistant components
- Single cartridge design of failure protection module for easy service and maintenance.
- Integral hot water by-pass
- Positive shutoff of hot supply when cold supply is lost
- Lead free option available - specify model 34ELF
- **Made in USA - ARRA compliant**

APPROVALS

- ASSE 1071 - Temperature Actuated Mixing Valves for Plumbed Emergency Equipment
- ANSI/ISEA Z358.1 2009 Emergency Eyewash & Shower Equipment

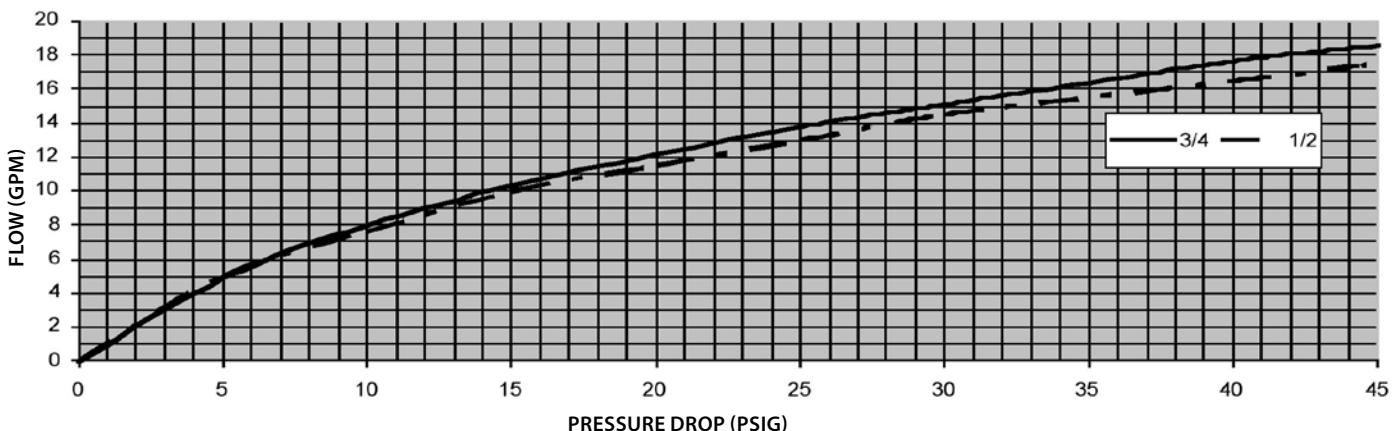

MIXING VALVES

Emergency Eye Wash/Face Wash Mixing Valve

MVE (34E Series)

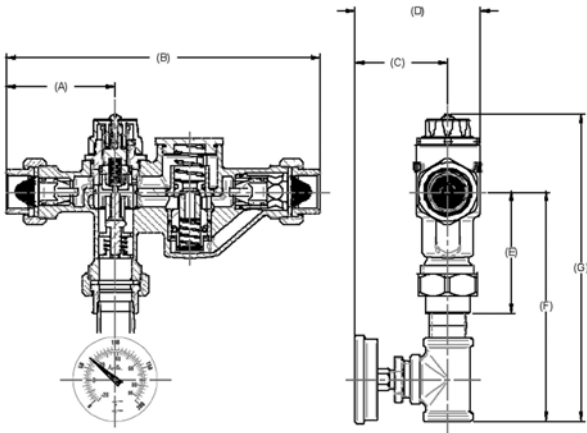

PERFORMANCE RATING

| | |
|---|-------------------------|
| Maximum working pressure | 150 psig (1034 kPa) |
| Hot water inlet temperature range | 120 - 180°F (49 - 82°C) |
| Cold water inlet temperature range | 40 - 70°F (4.4 - 21°C) |
| Tepid water temperature adjustment range | 65 - 95°F (18.3 - 35°C) |
| Mixed water temperature tolerance | ± 5°F (2.8°C) |
| Flow rate @ 30 psig (206.9 kPa) differential | 15 gpm (56.8 lpm) |
| Cold water bypass @ 30 psi (207 kPa) differential | 13.5 gpm (51 lpm) |

(Note: The cold water supply shall be at least 20°F (-6.7°C) lower than the outlet water temperature setting)

| CONNECTION SIZE | | 1/2" THREADED | 1/2" SOLDER | 3/4" THREADED | 3/4" SOLDER |
|---|------------|---------------|-------------|---------------|-------------|
| BASIC VALVE | MODEL # | MVE12 | MVES12 | MVE34 | MVES34 |
| | ORDERING # | 34E103T | 34E103S | 34E104T | 34E104S |
| INCLUDES OUTLET TEMPERATURE GAUGE | MODEL # | MVE12G | MVES12G | MVE34G | MVES34G |
| | ORDERING # | 34E113T | 34E113S | 34E114T | 34E114S |
| INCLUDES OUTLET TEMP. GAUGE AND INLET BALL VALVES | MODEL # | MVE12GB | MVES12GB | MVE34GB | MVES34GB |
| | ORDERING # | 34E123T | 34E123S | 34E124T | 34E124S |
| LEAD FREE BASIC VALVE | MODEL # | MVE12LF | MVES12LF | MVE34LF | MVES34LF |
| | ORDERING # | 34ELF103T | 34ELF103S | 34ELF104T | 34ELF104S |
| DIMENSIONS & WEIGHTS | | | | | |
| A (in.) | | 3.09 | 3.22 | 3.09 | 3.10 |
| B (in.) | | 8.90 | 9.15 | 8.90 | 8.90 |
| C (in.) | | 2.66 | 2.66 | 2.67 | 2.67 |
| D (in.) | | 3.60 | 3.60 | 3.60 | 3.60 |
| E (in.) | | 3.45 | 3.45 | 3.45 | 3.45 |
| F (in.) | | 5.77 | 5.77 | 6.32 | 6.32 |
| G (in.) | | 7.83 | 7.83 | 8.39 | 8.39 |
| UNIT WT. (lbs.) | | 3.94 | 3.73 | 5.13 | 5.07 |

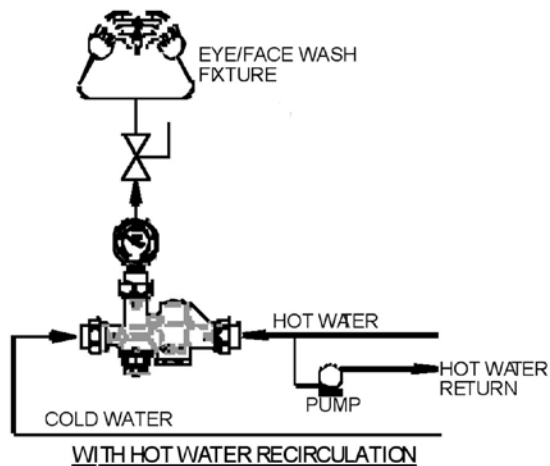
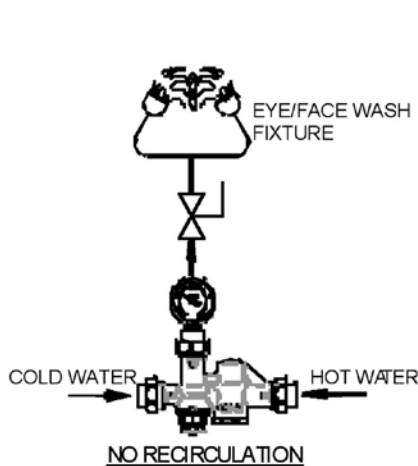

34E TYPICAL INSTALLATIONS

Note: Piping and installation of the device must be in accordance with federal, state, and local plumbing codes.

Note: If the valve is some distance from the hot water source, recirculation is required to keep the hot water supply temperature within the required operational limits.

MIXING VALVES

APOLLO® MIXING VALVES APPLICATION CHART - Point of Source

34-200 Series



Apollo 34 Series mixing valves help extend hot water supply and enhance the life and accuracy of hydronic thermostats in residential and small commercial systems. These valves may be used to increase draw capacity of automatic storage water heaters. They save hot water and energy by automatically regulating the mix of hot water with cold. Water temperatures can be adjusted by simply turning the yellow knob to the desired setting.

- Sizes 1/2", 3/4" solder
- Corrosion resistant bronze body and stainless steel spring
- Easy installation
- For tankless coils, water heaters, boilers and solar energy systems
- Outlet temperatures from 120°F to 130°F (110°F to 150°F optional)

34A-H Series – Radiant Heat



Apollo 34H Series mixing valves are ideal for use with domestic and commercial boilers and all types of radiant systems. They are available in a variety of pipe end connections and are equipped with element over-travel protection. Also the 34H Series mixing valves offer integral checks to prevent cross-connection of temperatures.

- Sizes 1/2", 3/4", 1"
- Maximum rated working pressure 125 psig
- Mixed temperature range is 120°F to 180°F.
- Corrosion resistant cast bronze body
- Union tailpieces and union nuts, standard
- Designed to make maintenance fast and easy
- Glass-filled Noryl® shuttle

34A Series – ASSE 1017



Apollo 34A Series mixing valves provide thermostat control of temperatures in residential, commercial and non-potable hot water systems. They are ASSE 1017 certified and designed for use with water heaters and boilers. During operation, the valve redistributes and extends safe hot water from the heater to various sections of a building's water system. 34A Series mixing valves offer integral checks to prevent cross-connection of temperatures. They also enable the contractor to direct mount the unit to the heater or boiler instead of heat trapping the valve.

- Sizes 1/2", 3/4", 1"
- Highest flow capacity in their class
- Maximum rated working pressure of 125 psig
- Easy temperature control from 85°F to 140°F.
- Corrosion resistant cast bronze body
- Union tailpieces and union nuts, standard
- Easily accessible internals allow in-line servicing
- Glass-filled Noryl® shuttle

34C Series – ASSE 1017



Apollo 34C Series high capacity mixing valves are ASSE 1017 certified. Also available in a high temperature model, these large capacity valves are designed for use in large commercial and institutional hot water systems.

- Sizes 3/4" - 2"
- Industry leading flow rates
- Corrosion resistant cast bronze body
- Stainless steel and thermoplastic internals
- Maximum rated pressure 150 psig
- Controlled temperature range is 90°F to 140°F (130°F to 180°F optional)
- All replaceable parts accessible from single point
- In-line repairable
- Glass-filled Noryl® shuttle

34HL Series – ASSE 1017/ASSE 1069

Hi/Lo Mixer



Apollo 34HL single assembly controls mixed water temperatures to multiple-outlet shower and sink installations. It's the ideal choice in new construction or retrofits in nursing homes, prisons, hospitals, schools, gymnasiums, airports and other facilities where constant safe water temperature needs to be maintained at several outlets without the use of independent ASSE 1016 shower valves.

- Capable of maintaining safe, consistent temperature control of water at low and high flows to within $\pm 3.6^\circ\text{F}$
- Provides consistent temperature control at flow rates as high as 60 GPM and as low as 1.5 GPM, including mid-range flow between high and low
- Performs without requiring recirculation pumps like other systems in order to achieve low flow control
- Integral strainers and checks are provided at the hot and cold supply inlets for greater reliability and performance.
- Manufactured to the same exacting standards that have made the Apollo name famous for durability and reliability
- Units can be mounted in parallel for extra large flow requirements

www.apollovalves.com

Customer Service (704) 841-6000



MIXING VALVES

APOLLO® MIXING VALVES APPLICATION CHART - Point of Use

34D Series – ASSE 1070



Apollo 34D Series thermostatic “Mini Mixer” valves are dual ASSE 1070 certified and designed as the ultimate single fixture valve, with a mixed accuracy of $\pm 2^{\circ}\text{F}$. Two designs are available depending on the application; single outlet design for sensor type faucets and double outlet design for standard connections.

- Compact, space saving design
- $3/8"$ compression x $3/8"$ compression connections
- Factory equipped with integral checks
- Corrosion resistant cast bronze body
- Stainless and thermoplastic internals
- Bypass tee option for cold water connection
- Chrome plating option

34B Series – ASSE 1070/ASSE 1017



Apollo 34B Series thermostatic mixing valves are dual ASSE 1070 and 1017 certified for point-of-use applications and provide enough capacity to protect up to twelve separate fixtures while maintaining an accuracy of $\pm 3^{\circ}\text{F}$. They offer easy adjustment of water temperatures. In accordance with ASSE 1070 standards, Series 34B valves come with maximum set point control features.

- Sizes $1/2"$, $3/4"$, $1"$
- Controlled temperatures from full cold up to 120°F .
- Corrosion resistant bronze body
- Union tailpieces, nuts, standard
- NPT, solder, CPVC and PEX connections
- In-line repairable
- Glass-filled Noryl® shuttle
- Factory equipped with integral checks and strainers
- Locking cap feature

34HL Series – ASSE 1069/ASSE 1017



Hi/Lo Mixer

Apollo 34HL is dual ASSE 1069 and 1017 certified as Point of Source and Point of Use. This thermostatic device will service multiple end-use fixture fittings, including but not limited to, gang showers and sitz baths, by supplying tempered water at a preset temperature through a single supply pipe and will meet ASSE standard 1069-2005. ASSE 1069 devices are designed to reduce the risk of scalding and thermal shock during changes in hot or cold water supply pressure or temperature, or loss of cold water supply.

- Capable of maintaining safe, consistent temperature control of water at low and high flows to within $\pm 3.6^{\circ}\text{F}$
- Provides consistent temperature control at flow rates as high as 60 GPM and as low as 1.5 GPM, including mid-range flow between high and low
- Performs without requiring recirculation pumps like other systems in order to achieve low flow control
- Integral strainers and checks are provided at the hot and cold supply inlets for greater reliability and performance.
- Manufactured to the same exacting standards that have made the Apollo name famous for durability and reliability
- Units can be mounted in parallel for extra large flow requirements
- Cabinets available

34E Series – ASSE 1071



Emergency Eye Wash / Face Wash

Apollo 34E Emergency Mixing Valves are designed to control the cold and hot water temperature to deliver tepid water at a predetermined temperature to emergency eyewash/facewash fixtures. The device provides a precise temperature and flow control in the event of cold water, hot water and thermostatic element failures. Complies with ANSI Z358.1-2009 & ASSE 1071-2008.

- Hot and cold water supply failure protection patented design (US Patent 6,926,20 B2)
- Tepid water temperature limit control and adjustment
- Tepid water temperature adjustment handle with locking mechanism for tamper-resistant protection and inadvertent adjustment
- Integral inlet check valves and strainers to provide protection against cross-flow and foreign particles
- Superior thermostatic element technology for optimum reliability, dependability and accuracy
- Thermostatic element failure and over-travel protection
- High efficiency and positive shut-off check valves
- In-line accessibility and serviceability of failure protection module and mixing valve internal components
- Meets the requirements of the EPA Safe Drinking Water Act
- Corrosion resistant components
- Single cartridge design of failure protection module for easy service and maintenance.

MIXING VALVES

TYPICAL MIXING VALVE PIPING SCHEMATIC

MVA SERIES MVB SERIES MVC SERIES MVHL SERIES

TYPICAL INSTALLATION POINT OF SOURCE (NO RECIRCULATION SYSTEM)

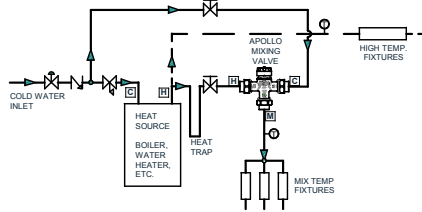

TYPICAL INSTALLATION POINT OF SOURCE (WITH RECIRCULATION SYSTEM)

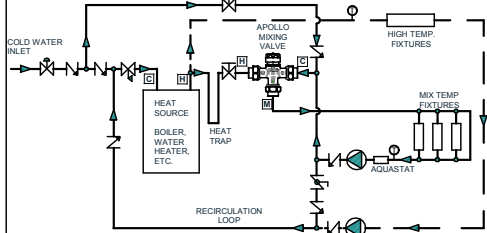

- DIRECTION OF FLOW
- THERMAL EXPANSION RELIEF VALVE OR TANK
- PRESS. REDUCING VLV.
- CHECK VALVE
- BALANCING VALVE
- PUMP
- TEMPERATURE GAUGE
- SHUT-OFF VALVE

MVB SERIES MVD SERIES

TYPICAL INSTALLATION POINT OF USE - STANDARD FAUCET (WITH RECIRCULATION SYSTEM)

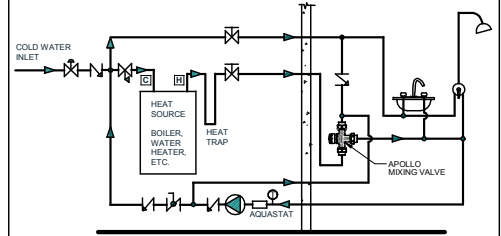

TYPICAL INSTALLATION POINT OF USE - SENSOR FAUCET (WITH RECIRCULATION SYSTEM)

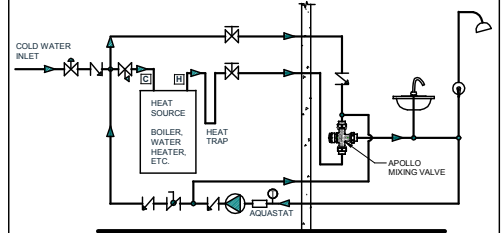

- DIRECTION OF FLOW
- THERMAL EXPANSION RELIEF VALVE OR TANK
- PRESS. REDUCING VLV.
- CHECK VALVE
- BALANCING VALVE
- PUMP
- TEMPERATURE GAUGE
- SHUT-OFF VALVE

TV SERIES MVAH SERIES

TYPICAL INSTALLATION HYDRONIC HEATING SYSTEM (SINGLE LOOP)

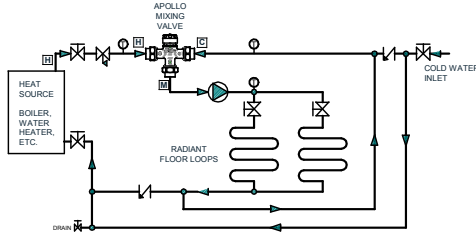

- DIRECTION OF FLOW
- THERMAL EXPANSION RELIEF VALVE OR TANK
- PRESS. REDUCING VLV.
- CHECK VALVE
- PUMP
- TEMPERATURE GAUGE
- SHUT-OFF VALVE

MVE SERIES

TYPICAL INSTALLATION EMERGENCY SYSTEM (EYEWASH/FACEWASH)

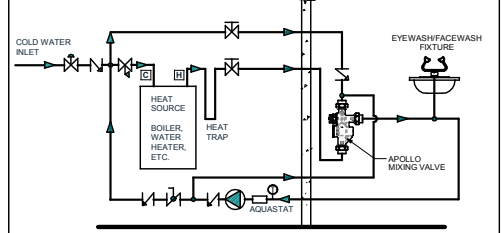

- DIRECTION OF FLOW
- THERMAL EXPANSION RELIEF VALVE OR TANK
- PRESS. REDUCING VLV.
- CHECK VALVE
- BALANCING VALVE
- PUMP
- TEMPERATURE GAUGE
- SHUT-OFF VALVE

OTHER APOLLO LITERATURE FOR YOUR SPECIFICATION LIBRARY



Commercial Products Catalog



Gate, Globe & Check Catalog



Iron Gate, Globe & Check Catalog

TERMS, CONDITIONS & WARRANTY INFORMATION

WARRANTY AND LIMITATIONS OF LIABILITY

Conbraco Industries, Inc. warrants, to its initial purchaser only, that its products which are delivered to this initial purchaser will be of the kind described in the order or price list and will be free of defects in workmanship or material for a period of FIVE years from the date of delivery to you, our initial purchaser. This warranty applies to Apollo brand product with "Made in the USA" markings only.

Should any failure to conform to this warranty appear within FIVE years after the date of the initial delivery to our initial purchaser, Conbraco will, upon written notification thereof and substantiation that the goods have been stored, installed, maintained and operated in accordance with Conbraco's recommendations and standard industry practice, correct such defects by suitable repair or replacement at Conbraco's own expense.

APOLLO INTERNATIONAL PRODUCTS: Conbraco Industries, Inc. warrants its International products, to its initial purchaser only, that its international products which are delivered to this initial purchaser will be of the kind described in the order or price list and will be free of defects in workmanship or material for a period of TWO years from the date of delivery to you, our initial purchaser.

THIS WARRANTY IS EXCLUSIVE AND IS IN LIEU OF ANY IMPLIED WARRANTY OF MERCHANTABILITY, FITNESS FOR A PARTICULAR PURPOSE OR OTHER WARRANTY OF QUALITY, WHETHER EXPRESSED OR IMPLIED, EXCEPT THE WARRANTY OF TITLE AND AGAINST PATENT INFRINGEMENT. Correction of non-conformities, in the manner and for the period of time provided above, shall constitute fulfillment of all liabilities of Conbraco to our initial purchaser, with respect to the goods, whether based on contract, negligence, strict tort or otherwise. It is the intention of Conbraco Industries, Inc. that no warranty of any kind, whether expressed or implied shall pass through our initial purchaser to any other person or corporation.

LIMITATION OF LIABILITY: Conbraco Industries, Inc. SHALL NOT UNDER ANY CIRCUMSTANCES BE LIABLE FOR SPECIAL OR CONSEQUENTIAL DAMAGES SUCH AS, BUT NOT LIMITED TO, DAMAGES OR TO LOSS OF OTHER PROPERTY OR EQUIPMENT, LOSS OF PROFITS OR REVENUE, COST OF CAPITAL, COST OF PURCHASED OR REPLACEMENT GOODS, OR CLAIMS OF CUSTOMERS OF OUR INITIAL PURCHASER. THE REMEDIES OF OUR INITIAL PURCHASER, AND ALL OTHERS, SET FORTH HEREIN, ARE EXCLUSIVE, AND THE LIABILITY OF CONBRACO WITH RESPECT TO SAME SHALL NOT, EXCEPT AS EXPRESSLY PROVIDED HEREIN, EXCEED THE PRICE OF THE GOODS UPON WHICH SUCH LIABILITY IS BASED.

* It is the end user's responsibility to confirm that items intended for use satisfy local codes and standards.



INTERNATIONAL SALES REPS & REGIONAL MANAGERS

| | AREAS COVERED | EMAIL | PHONE | FAX |
|-------------------|--|--------------------------------|-------------------------------------|-------------------|
| INTERNATIONAL | Conbraco International Sales: | | | |
| | Jose Arias | Mexico | jose.arias@conbraco.com | 956-631-4542 |
| | Luis Guzman | Caribbean | luis.guzman@conbraco.com | 787-739-5620 |
| | JR Jefferson | Central & South America | jr.jefferson@conbraco.com | 832-220-3783 |
| | Mike Link | United Kingdom | michael.link@pegler.yorkshire.co.uk | 44-0-1302-560-560 |
| | Luke Liu | China | luke.liu@conbraco.com | 411-869-02498 |
| | Jonathan Yap | Asia Pacific/India | jonathan.yap@conbraco.com | 65-9626-9241 |
| | Pegler Yorkshire Mid East | Europe/Africa/Australia/Israel | Contact Customer Service | 704-841-6000 |
| | | Middle East (except Israel) | pydubai@mailme.ae | 971-4-454-2353 |
| REGIONAL MANAGERS | APOLLO VALVES REGIONAL SALES DIRECTORS | | P.O. BOX 247, Matthews, NC 28106 | |
| | Brian Blalock | East Coast | brian.blalock@conbraco.com | 704-614-3744 |
| | Skip Wilson | West | skip.wilson@conbraco.com | 760-330-3293 |
| | APOLLO VALVES REGIONAL MANAGERS | | | |
| | Kevin Ashworth | Mid Atlantic | kevin.ashworth@conbraco.com | 757-272-6200 |
| | Steve Brown | Northwest | steve.brown@conbraco.com | 425-985-5095 |
| | Andy Fretz | Canada - Commercial | andy.fretz@conbraco.com | 647-281-3161 |
| | Ben Lauletta | Northeast | ben.lauletta@conbraco.com | 518-795-4629 |
| | Sanford Pauly | North Central | sanford.pauly@conbraco.com | 513-716-7772 |
| | Hector Rivera | Florida | hector.rivera@conbraco.com | 786-210-7010 |
| | James Saldivar | South Central - Industrial | james.saldivar@conbraco.com | 832-776-5547 |
| | Nick Shelley | South Central - Commercial | nick.shelley@conbraco.com | 214-790-4157 |
| | Jim Todman | Canada - Industrial | jim.todman@conbraco.com | 905-407-8385 |
| | LASCO FITTINGS IRRIGATION REGIONAL MANAGERS | | P.O. BOX 116, Brownsville, TN 38012 | |
| | David Beyer | Northeast | dbeyer@lascofittings.com | 561-718-9379 |
| | Ron Modugno | West | rmodugno@lascofittings.com | 661-910-5058 |
| | Jimmy White | Central | jwhite@lascofittings.com | 731-234-2372 |
| | Rick Williamson | Southeast | rwilliamson@lascofittings.com | 386-451-2307 |



for additional information, submittal sheets and manuals, visit www.apollovalves.com

Customer Service (704) 841-6000



SALES & CUSTOMER SERVICE:

Phone: (704) 841-6000

Fax: (704) 841-6020

www.apollovalves.com

| | AGENCY | AREAS COVERED | EMAIL | PHONE | FAX |
|----------------------|-------------------------------------|---|---------------------------------|--------------|--------------|
| SOUTHEAST REGION | Mid South Marketing, Inc. | VA/MD/Washington, D.C./WV-East | midsouth7@aol.com | 804-213-3801 | 804-213-3802 |
| | Pro Marketing, Inc. | NC/SC/TN-East | sales@promarketinginc.net | 864-578-4334 | 864-578-4889 |
| | Spirit Group | FL (except Panhandle) | info@spiritgroupinc.com | 407-291-6035 | 407-299-0378 |
| | Valve Pro Sales | AL/FL Panhandle | apollovalves44@yahoo.com | 256-233-7538 | 866-207-6905 |
| | White Wolf Group | GA | info@whitewolfgroupinc.com | 800-401-4870 | 888-908-9372 |
| SOUTHERN REGION | BWC Inc. | LA (Commercial Products) | chuck@bwcassoc.com | 504-734-0229 | 504-734-3711 |
| | Marathon Flow Control | TX, OK, KS except Northeast, LA (Industrial) | sales@marathonflowcontrol.com | 214-201-0100 | 214-201-0104 |
| | Southern Marketing Group | MS/TN-West/AR/Bowie Cty.-TX | SMG49@bellsouth.net | 901-547-0042 | 901-547-0035 |
| MIDWESTERN REGION | FourMation Sales | MN/ND/SD/WI-West | ryan@fourmationsales.com | 763-420-6900 | 763-420-6993 |
| | Marshall-Rodeno Heartland | NE/IA (Except River Counties) | trodeno@marshallrodeno.com | 303-575-6701 | 303-575-6706 |
| | Midwest Spec | KY/OH/PA-West/WV-West | glsales@mwspec.com | 330-538-0406 | 330-538-0410 |
| | New Tech Marketing | Northern-IL/WI-East/IN/MI-UP/IA-River Counties | sales@new-techmarketing.com | 630-378-4300 | 630-378-0343 |
| | New Tech Marketing | MO/Southern IL/Northeast Kansas | ntm112@aol.com | 618-394-0329 | 618-394-0427 |
| | V.E. Sales Co., Inc. | MI (Except Upper Peninsula) | tomv@vesalesinc.com | 586-774-7760 | 586-774-1490 |
| WESTERN REGION | Elmco Duddy | CA - South | tduddy@elmcoduddy.com | 626-333-9942 | 626-855-4811 |
| | Gordon & Associates | WA, OR, AK, Northern counties ID | laura@gordonandassoc.com | 360-566-1470 | 360-566-1478 |
| | HC Fletcher | CA - North (AB 1953 compliant product) | apollosales@hcfletcher.com | 800-432-7047 | 949-660-9072 |
| | Marshall-Rodeno Associated | CO/WY/MT/ID-SE/UT/NV-NE/NM/El Paso-TX | trodeno@marshallrodeno.com | 303-575-6701 | 303-575-6706 |
| | Romatec | CA - North PVF (non AB 1953) | apollo@romatec.com | 877-530-3530 | 661-588-3534 |
| | Southwest Valves | CA (Waterworks and Fire Protection) | d.burell@southwestvalve.com | 559-261-2703 | 559-261-2711 |
| | Southwestern Industrial Sales Co. | AZ/Nevada-SW | eduardop@sw-ind.com | 480-458-5838 | 480-458-5843 |
| | Spec Management Group | HI | msmarch4@cox.net | 949-481-4225 | 949-487-0990 |
| NORTHEAST REGION | Conroy & Griese Sales, Inc. | NY-East/NJ-North | iezzi52@aol.com | 856-663-4440 | 856-663-6644 |
| | Keith Engle & Associates | OEM accounts | keith.enge@verizon.net | 610-827-9560 | 610-827-9561 |
| | Layden Company | NY-Upstate/PA-East/DE/NJ-South | joejr@laydencompany.com | 610-363-6657 | 877-529-3361 |
| | Urell, Inc. | MA/New England States | conbraco@urell.com | 617-923-9500 | 617-926-9414 |
| IRRIGATION ONLY REPS | Active Sales Northwest, Inc. | OR, WA, Western ID | skactive@aol.com | 541-726-0320 | 541-726-1148 |
| | Biz Sales Company | OH, KY, MI, IN, parts of PA, WV, WI | dzavelson@bizpvf.com | 216-595-2888 | 216-595-2899 |
| | Fourmation Sales | MN/ND/SD/WI-West | dean@fourmationsales.com | 763-262-4700 | 763-262-4740 |
| | Jim Benton & Associates | AL, FL Panhandle | jim@bentonandassoc.com | 205-664-1221 | 205-664-1277 |
| | J&J Midwest Sales | NE, IA, MO, KS | john@jandjmidwestsales.com | 314-422-8419 | |
| | Marel Enterprises | New England, NY, DE, MD, VA, DC, parts of PA & WV | marelenterprise@gmail.com | 631-271-1718 | 631-427-8558 |
| | Marshall-Rodeno Associated | CO/WY/MT/ID-SE/UT/NV-NE | trodeno@marshallrodeno.com | 303-575-6701 | 303-575-6706 |
| | NSC Marketing Group Inc. | OK | nsc_tulsa@sbcglobal.net | 918-627-5340 | 918-664-1408 |
| | Pro Marketing, Inc. | NC/SC/TN-East | sales@promarketinginc.net | 864-578-4334 | 864-578-4889 |
| | Southern Marketing Group | MS/TN-West/AR/Bowie Cty.-TX | SMG49@bellsouth.net | 901-547-0042 | 901-547-0035 |
| | Spec Management Group | CA-South | msmarch4@cox.net | 949-481-4225 | 949-487-0990 |
| CANADA | Agences J. Pierre Sylvain, Inc. | Quebec | agencespsylvain@golden.net | 450-655-9588 | 450-641-2737 |
| | Barclay Sales Ltd. | British Columbia | bbarclay@barclaysales.com | 604-945-1010 | 604-945-3030 |
| | Conbraco Industries, Canada | 178 Pennsylvania Ave., Unit 1, Concord, Ontario L4K 4B1 | conbraco.canada@conbraco.com | 905-761-6161 | 905-761-6666 |
| | D & M Mechanical Sales | Ontario/East | don@dandmsales.ca | 613-384-7084 | 613-384-3407 |
| | Dynamic Agencies, Ltd. | Saskatchewan | doug.dynamicage@sasktel.net | 306-343-1901 | 306-343-1901 |
| | J. Levandier Sales, Inc. | Nova Scotia, New Brunswick, Prince Edward Island & Newfoundland | service@jlevandiersales | 506-858-1615 | 506-858-1084 |
| | Kern Industries, Ltd. | Alberta-North | kernind@telusplanet.net | 780-451-2056 | 780-454-6687 |
| | Kern Industries Calgary, Ltd. | Alberta-South | marty.yucytus@kernindustries.ca | 403-730-7791 | 403-239-8179 |
| | Key to the North Sales Agency, Inc. | Ontario-North | hmehe@keytothenorth.ca | 705-524-6714 | 705-566-0148 |
| | Task Controls, Inc. | Ontario | infotoronto@taskcontrols.com | 416-291-3004 | 416-754-3481 |
| | Tom Beggs Agencies Ltd. | Manitoba/NW Ontario | tba@mts.net | 204-953-1900 | 204-774-6915 |