

PRODUCT INFORMATION PACKET

FASCO[®]

Model No:
Catalog No: A170
702111620.BLOWER...1 SPD.
Draft Inducer



Regal and Fasco are trademarks of Regal Beloit Corporation or one of its affiliated companies.
©2019 Regal Beloit Corporation, All Rights Reserved. MC017097E

REGAL[®]



Nameplate Specifications

Voltage	115 V	Motor Type	Shaded Pole
Overload Protector	Thermally	Speed	3400 RPM
Current	2.3 A	Number of Speeds	1
Frequency	60 Hz	Phase	1
Ambient Temperature	40 °C	UL	Yes
Insulation Class	B	CSA	Yes

Technical Specifications

Blower Outlet Shape	Round	Motor Enclosure	Open Fan Cooled
Blower Outlet Flange	No	Bearing Type	Ball
Outline Drawing	OUTLINE	Connection Diagram	CONNECTION

This is an uncontrolled document once printed or downloaded and is subject to change without notice. Date Created: 09/25/2019

NOTES:

1. INSPECTION TEST FIXTURE IS REQUIRED.
2. DESIGNATES LOCATION BACK FROM EXHAUST TO CHECK "X" AND "Y".
3. MAX. DISPLACEMENT OF 1.5 MIL IN THE "X" AND "Y" DIRECTIONS AT FINAL UNIT BALANCE FIXTURE.
4. OVERALL VIBRATION LEVEL TO BE 1.9 MIL/MAX.
5. TAP VACUUM -1.8" MINIMUM WHEN CORRECTED TO STANDARD AIR.
6. PACK 1 PER CONTAINER, 6 CONTAINERS PER LAYER, 3 LAYERS PER PALLET, 18 MAX. PER PALLET, PACKING ASSY. 87855112, PER 88834200 AND 88834408.
7. PACK 1 KIT, PC 386, IN EACH CONTAINER WITH BLOWER.
8. CARTON LABELS MUST ALL FACE ONE DIRECTION TOWARD THE OPEN END OF THE PALLET. SEE 88834408.
9. NO PACKAGING TAPE OVER CARTON LABEL.

THERMALLY PROTECTED
 CLASS "B" INSULATION
 SEALED BALL BEARING
 303 SS SHAFT

APPLICATION:	DIST.	B	LA	FR	A	S	C	E	B	A
CUSTOMER:	FASCO DIST.	PO	21	30	F	06	ET	5	0	0
CUSTOMER PN:	A170	FINISH: BLOWER - FLAT BLACK, MOTOR - FLAT BLACK								

LEAD MATERIAL
 18 GA. 125°C 2/64 INSUL
 EPDM, BLACK AND WHITE
 8.00/6.00 [203.20/152.40]
 W/ MSPADE TERMS.
 AMP 2-520102-2

GROUND LEAD MATERIAL
 18 GA. 125°C 2/64 INSUL
 X-LINKED POLY. GRN/YEL
 10.50/6.50 [266.70/165.10]
 W/ RING TERM.
 AMP 60700-2

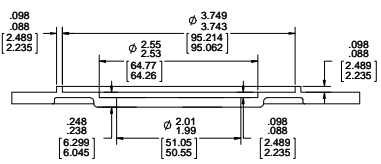
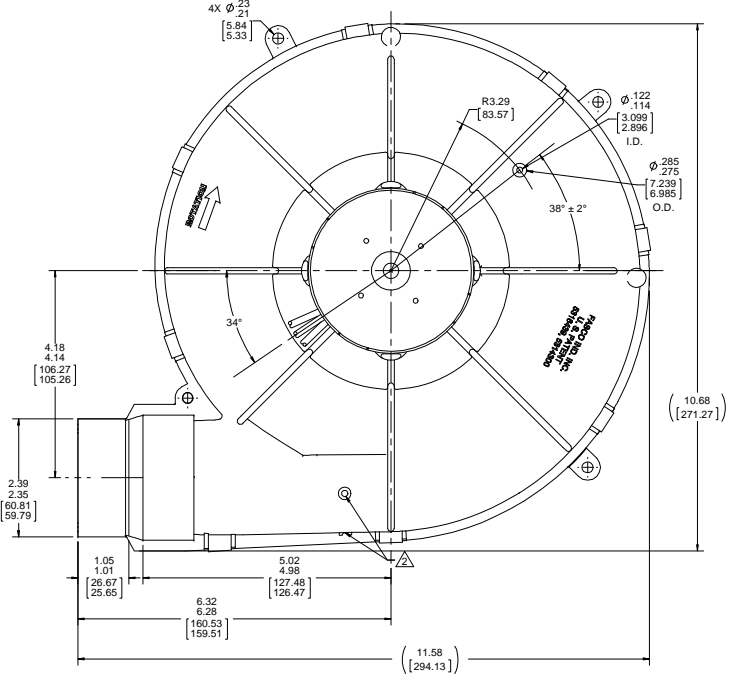
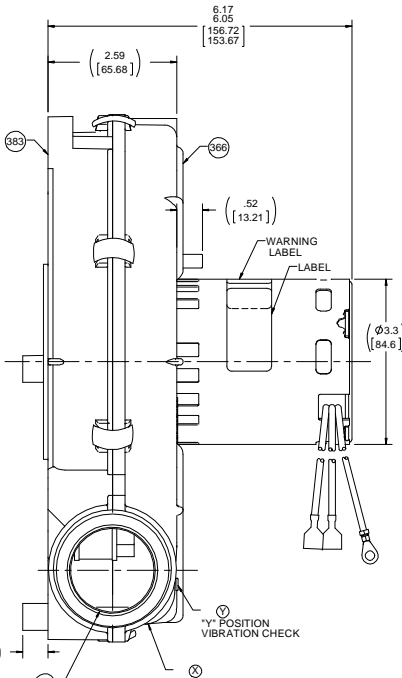
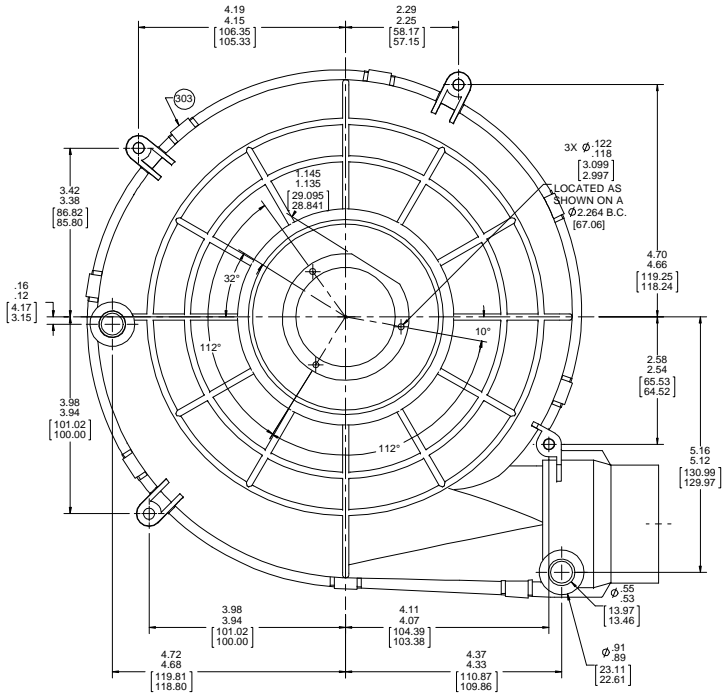

AVERAGE PERFORMANCE TEST DATA WITH 1.25 [31.75] IN. [mm] INLET RESTRICTOR AT 115 VOLTS 60 Hz			
	RPM	WATTS	AMPS
	3358	144	2.12

DRAWING REVISION	REVISION BY	FDP	DATE	9/27/2018	TOLERANCES UNLESS OTHERWISE SPECIFIED:	DRAWN BY	FDP	DATE	9/15/2018	Regal Beloit America, Inc.
ECO-0152994	APPROVED BY	MLS	DATE	9/27/2018	FSC: .001			DATE	9/15/2018	OUTLINE BLOWER ASSY
					ANG: .015			APPROVED BY		
					X .005			DATE	9/15/2018	
					XX .001			REFERENCE		
					XXX .0005			THIRD ANGLE PROJECTION		
					XXXX .0005			SIZE	D	DRAWING NUMBER
					REMOVED SURFACES: SHARP			702111620		SHEET
					EDGES: .001 (1.5) (9.5) (31.1) X 45°			1 OF 2		
					CORNER FILLETS: R .01 (1.5)					
					MACHINED SURFACES: 125 / 32					
					RHS SHOWN IN BRACKETS					

NOTES:

1. SHAFT SEAL MUST BE LOCATED ON SHAFT AS SHOWN BELOW.
2. BEFORE ASSEMBLING IMPELLER TO SHAFT, PRESS PC 399 ROPE SEALANT AGAINST EXPOSED FACE OF NUTS TO PROTECT FROM CORROSIVES.
3. WHEN EQUIPPED WITH WATER SEAL, EVERY 40TH BLOWER IS TO BE CHECKED FOR WATER LEAKAGE. IF LEAKERS ARE DISCOVERED CONTACT ENGINEERING. (USE 1/3 PARTS MR. BUBBLE WITH 2/3 PARTS WATER FOR LEAK TEST.)
4. LAY PC 391 ROPE SEALANT IN CHANNEL PROVIDED IN MOUNTING SHELL.
5. APPLY PC 301 RTV SEALANT TO SHADED AREA OF MOUNTING SHELL AS SHOWN BEFORE ASSEMBLY OF CLIPS. ASSEMBLE INLET SHELL TO MOUNTING SHELL ASSEMBLY AND SECURE WITH (8) PC 303 CLIPS.
6. TRIM EXCESS ROPE SEALANT FROM FACE OF BLOWER EXHAUST.
7. STUFF PAPER TO SECURE HOUSING.
8. CHECK EVERY BLOWER FOR STATIC VACUUM.
9. TEST WITH 1 1/4 IN. INLET RESTRICTOR.

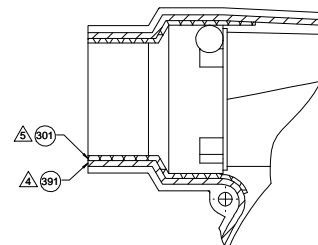
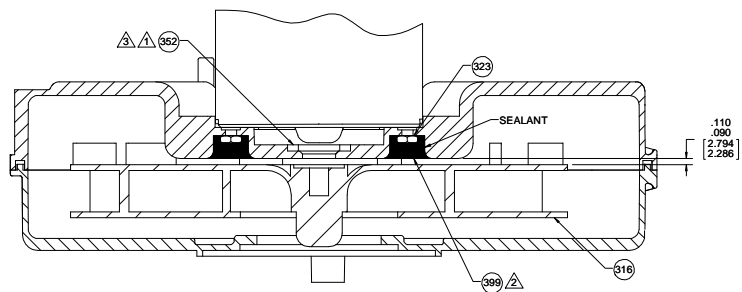

DRAWING REVISION ECO-0152984	REVISION BY MB	APPROVED BY MLS	DATE 9/27/2018	DATE 9/27/2018	TOLERANCES UNLESS OTHERWISE SPECIFIED: FDC .001 X .001 XX .0005 XXX .0005 XXXX .0005	ANGLE 90.0 90.0 90.0 90.0 90.0	DATE 9/15/2018	APPROVED BY SED	DESCRIPTION OUTLINE BLOWER ASSY	REGAL BELLOIT AMERICA, INC.
<p>REVISED PACKING INSTRUCTIONS</p> <p>REGAL BELLOIT AMERICA, INC. reserves the right to change specifications without notice. All dimensions are in inches unless otherwise specified. All tolerances are in inches unless otherwise specified. All dimensions are in inches unless otherwise specified. All tolerances are in inches unless otherwise specified. All dimensions are in inches unless otherwise specified. All tolerances are in inches unless otherwise specified.</p>										
MATERIAL			PROCESS/FINISH			THIRD ANGLE PROJECTION		DRAWING NUMBER 702111620		SHEET 2 OF 2