

# Drop-in Sink Installation Instructions

For Models 006-622, 561-0633, 006-623, 561-0634

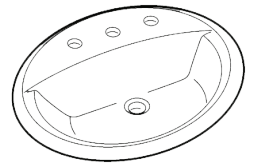

**CAUTION: PRODUCT IS FRAGILE. TO AVOID BREAKAGE AND POSSIBLE INJURY HANDLE WITH CARE!**

- 1** Cut along the inside line of the supplied template.

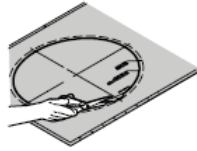

- 2** Using the template provided, locate the position of the sink. Provide proper clearance under the countertop for the faucet supply lines, drain assembly and the structural parts of the cabinet.

NOTE: If you are replacing an existing sink, be certain to shut off the water supply before removing the old sink.

- 3** Trace the cutout.

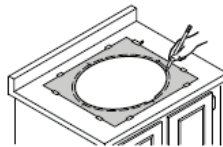

- 4** Drill a pilot hole on the inside of the line.

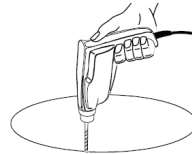

Use a Jig Saw to cut an opening along the line.

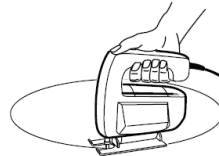

- 5** Mount the faucet and drain assembly (not included) on the sink following faucet manufacturer's instructions. Be certain to apply a bead of sealant on the underside of the drain "A" in order to ensure a watertight seal between the sink and the drain. Remove excess sealant after installing drain on sink.

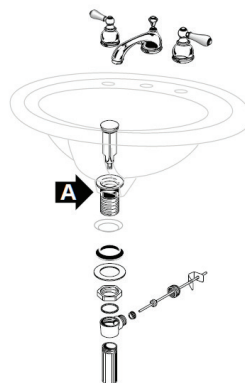

- 6** Before applying the sealant, place the sink temporarily into the cut-out. Check for alignment and clearance. Then mark the sink and countertop in several places as a guide for the installation location.

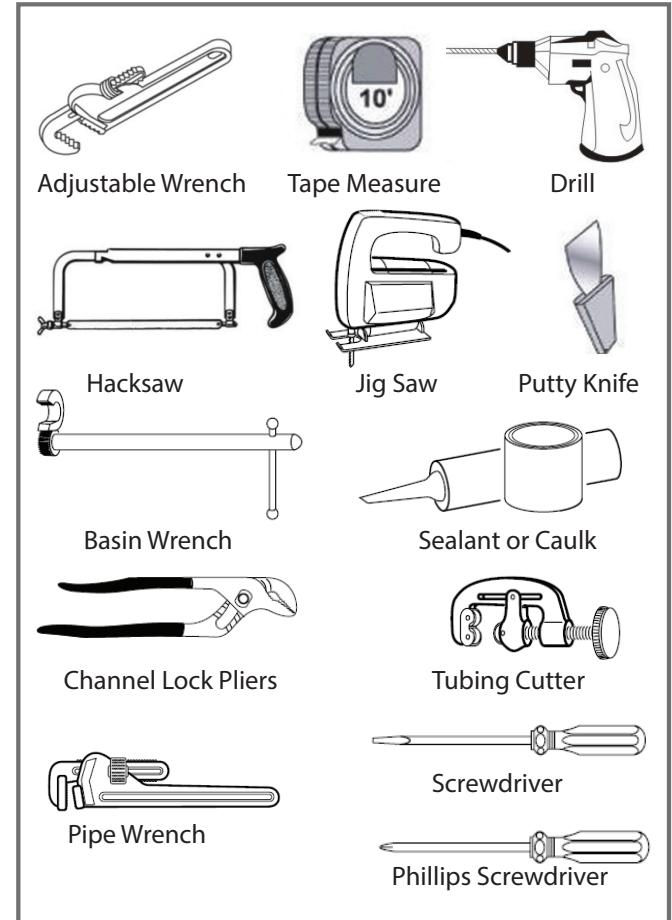
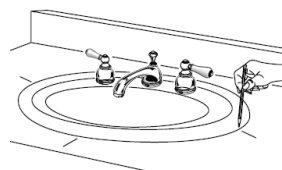

- 7** After checking fit and alignment, turn sink upside down and apply a generous portion of sealant around the underside of the rim near the edge. Carefully lower the sink in place, align with the marks made earlier and press down firmly. Allow the sealant to set before connecting the supplies and drain.

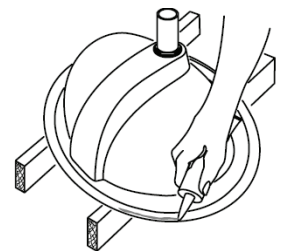

- 8** Connect supply line to faucet (finger tight) and carefully bend tubes to engage with the supply shut-off valves. Tighten connections at faucet and shut-off valves for secure seal.

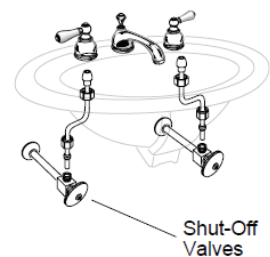

# Drop-in Sink Installation Instructions

For Models 006-622, 561-0633, 006-623, 561-0634

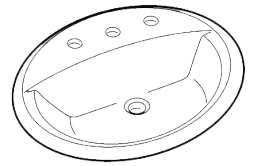

**CAUTION: PRODUCT IS FRAGILE. TO AVOID BREAKAGE AND POSSIBLE INJURY HANDLE WITH CARE!**

- 9** Connect trap to drain assembly, hand tighten to check alignment. It may be necessary to cut off part of the tailpiece ( B ) or part of the horizontal leg of the trap ( C ). Secure joints for watertight assembly.

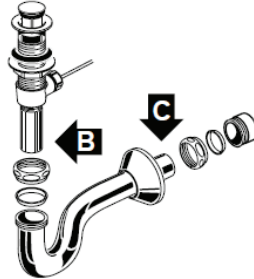

- 10** Run water and check for leaks.

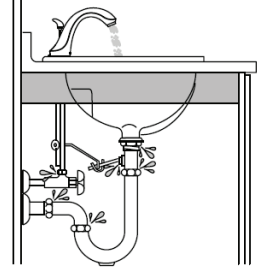

## LIMITED WARRANTY

### Vitreous China

Compass Manufacturing International Vitreous China is warranted to the original consumer purchaser to be free from defects in material and workmanship for as long as the original consumer purchaser owns the home in which the sink was first installed or for 5 years from the date of purchase.

Compass Manufacturing International will replace, free of charge, during the applicable warranty period, any part or finish that proves defective in material and/or workmanship under normal installation, use and service. Compass Manufacturing International recommends using a professional plumber for all installation and repair. Replacement parts may be obtained by emailing the address below, calling the number below or by writing to:

Compass Manufacturing International  
6702 Enterprise Drive  
Louisville, KY 40214  
800.626.3525  
[warranty@cmiproduct.com](mailto:warranty@cmiproduct.com)

### Vitreous China Product Care

Rinse thoroughly and use a soft cloth to wipe the product dry after each use.

#### **Regular Maintenance:**

Remove stains using a cleaning product that contains mild abrasives; rinse and towel dry. Strong abrasive cleaners will scratch and dull the surface.

#### **Products to Consider**

Comet Bathroom Cleanser  
Formula 409 Antibacterial All Purpose

Windex Original  
Soft Scrub Original