



NEW PRODUCT
Malleable Iron
Grooved X Threaded
Reducing 90° Elbow
See Page. 14

WARD FITTINGS

PRICE SCHEDULE #300416

EFFECTIVE: APRIL 11, 2016



WARD MFG

117 Gulick Street, Blossburg, PA 16912 | www.wardmfg.com | (800) 248-1027

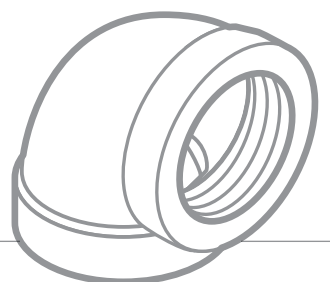

TERMS AND CONDITIONS OF SALE:

- 1. PRICES:** This price sheet supersedes all previous issues. Prices in price sheets are subject to change without notice. Prices apply only to standard sizes as listed in catalog.
- 2. APPROVAL & ACCEPTANCE OF ORDERS:** All orders are accepted on the basis of prices in effect at the time of shipment.
- 3. TAXES:** Any Manufacturer or Sales Tax payable on the transaction under any effective statute will be added to the prices and terms quoted, unless a valid exemption certificate is on file.
- 4. CREDIT TERMS:** Two percent cash discount tenth prox., - Net 30 days. Unless otherwise stated.
- 5. DELIVERY & SHIPMENT OF GOODS:** All goods are shipped at buyer's risk. Shipments should be carefully examined upon delivery and before the carrier's delivery receipt is signed. If any loss or damage is evident, the buyer should make an appropriate notation on the delivery receipt and insist that the carrier's driver initial such exception. The contents of all packages should be carefully examined for concealed damage as soon as possible after delivery, so that the carrier can be requested, within 48 hours after delivery, to arrange for prompt inspection of the damaged goods. Completion of all orders accepted and fulfillment of all agreements or contracts entered into are subject to any delay which might be occasioned by labor disputes, fires, accidents, embargoes, trade restrictions, governmental directives or other causes beyond our control. All promises of shipment will be as closely estimated as possible. We use our efforts in every case to ship within the time promised, but cannot guarantee to do so. All claims for shortage must be made on receipt of goods. We prove our count by weighing the package. Claims for shortage are subject to that test. Typographical, clerical, arithmetical errors or omissions in orders, invoices, quotations, price schedules, acknowledgments, or other documents are subject to correction.
- 6. RETURN OF GOODS:** No goods will be taken back and credited without prior approval and issuance of a return goods authorization (RGA) number. All fittings returned with our permission must be goods sold by Ward Manufacturing, LLC, and in clean saleable condition. Credit will only be allowed on the basis of prices agreed upon. If product returned is a result of a customer ordering error or overstocking situation, the credit will be less 20 percent to cover handling costs, less any costs of returning to a saleable condition, and less transportation charges on original and return shipments. Orders for special goods are not subject to cancellation for any reason after work has been started on them, except upon agreement to make payment for all work which has been performed.
- 7. WARRANTY:** Seller warrants the material to be free of defects in material and workmanship, under normal use, proper maintenance and proper operation, for a period of one year from date of delivery to a common carrier for shipment to buyer or his designated agent. The obligation of the seller is limited to (1) repair of the material, or (2) replacement of any component or components proven defective in material or workmanship, or (3) refund of the purchase price. Seller shall have no liability for the cost of removal or reinstallation with respect to any replaced or repaired product. The election of said remedies shall be determined by seller in its sole discretion and shall be considered final disposition. All implied warranties, including the implied warranties of merchantability and fitness for a particular purpose, are hereby disclaimed and excluded. This warranty is in lieu of all other warranties, guarantees, agreements and similar obligations of seller; in no event shall seller be liable for consequential or incidental damages.
- 8. FREIGHT TERM:** Shipments of 2,000 lb. net or more will be prepaid in the continental U.S. (except Alaska). We reserve the right to choose shipping point and carrier.
- 9. CARTON & BOX QUANTITY ADJUSTMENT:** On orders received for less than master carton or box quantities, we reserve the right to adjust to the next carton or box quantity above the number of pieces shown on the order. Items subject to adjustment are identified with stars in the price sheet.
- 10. WEIGHTS:** The weights per piece or per 100 pieces given in the price sheet, catalogs, and quotations are not guaranteed, but are approximate and for your convenience.
- 12. SPECIAL CONDITIONS:** Any additional cost incurred in packaging or in making any special tests or inspection requested by Buyer in addition to those commercially supplied by Ward Manufacturing, LLC., will be charged to Buyer. Such tests and inspections will be made at the factory before date of shipment. Orders for fittings or parts will be subject to a net minimum invoice charge of \$35.00 Net plus applicable handling and freight charges.
- 13. US EXPORT COMPLIANCE:** The products sold by Ward Manufacturing, LLC. may be subject to the export control laws and regulations of the United States Government. Buyer may not make any disposition of such products, by way of sale, export, re-export, transshipment or otherwise, except as permitted under applicable U.S. law.

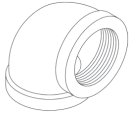

Fig. 47

**MALLEABLE IRON
90° ELBOWS
CLASS 150**

DESCRIPTION	PCS PER BOX	PCS PER MASTER	WEIGHT PER 100	PART # BLACK	PRICE (US\$) BLACK	PART # GALV.	PRICE (US\$) GALV.		
1/8	35	210	8	A.BML	*	7.55	A.NML	*	11.69
1/4	30	180	12	B.BML	*	7.37	B.NML	*	10.67
3/8	30	180	19	C.BML	*	7.37	C.NML	*	10.67
1/2	50	200	26	D.BML	#	5.11	D.NML	#	6.87
3/4	35	140	45	E.BML	#	6.16	E.NML	#	8.44
1	20	80	69	1.BML	#	10.71	1.NML	#	15.63
1-1/4	20	40	102	1B.BML	#	17.65	1B.NML	*	24.71
1-1/2	8	32	135	1D.BML	#	23.22	1D.NML	*	32.24
2	8	16	219	2.BML	#	40.03	2.NML	*	52.82
2-1/2	12	12	449	2D.BML	*	89.18	2D.NML	*	138.22
3	5	5	737	3.BML	*	130.51	3.NML	*	227.88
3-1/2	3	6	665	3D.BML		358.76	3D.NML		745.13
4	4	4	919	4.BML		280.33	4.NML		401.93
5	1	1	1355	5.BML		819.15	5.NML		1,735.75
6	1	1	2255	6.BML		946.22	6.NML		1,600.17
1/4 x 1/8	30	180	10	BXA.BML	*	14.67	BXA.NML		19.16
3/8 x 1/8	25	75	15	CXA.BML		20.42	CXA.NML		32.53
3/8 x 1/4	25	150	16	CXB.BML	*	10.36	CXB.NML		17.07
1/2 x 3/8	50	200	24	DXC.BML	*	9.73	DXC.NML	*	12.64
1/2 x 1/4	30	180	22	DXB.BML	*	10.01	DXB.NML	*	14.80
3/4 x 1/4	12	24	28	EXB.BML		15.59	EXB.NML		26.80
3/4 x 1/2	30	120	35	EXD.BML	*	10.01	EXD.NML	*	14.67
3/4 x 3/8	30	180	30	EXC.BML	*	13.99	EXC.NML		20.24
1 x 3/4	20	80	56	1XE.BML	*	12.86	1XE.NML	*	18.83
1 x 1/2	25	100	50	1XD.BML	*	13.87	1XD.NML	*	19.99
1 x 3/8	25	100	47	1XC.BML	*	27.31	1XC.NML		35.47
1-1/4 x 1	10	40	83	1BX1.BML	*	21.61	1BX1.NML	*	31.59
1-1/4 x 3/4	15	60	74	1BXE.BML	*	24.11	1BXE.NML	*	37.95
1-1/4 x 1/2	15	60	65	1BXD.BML	*	28.17	1BXD.NML		40.21
1-1/2 x 1-1/4	15	30	120	1DX1B.BML	*	30.49	1DX1B.NML	*	50.48
1-1/2 x 1	10	40	106	1DX1.BML	*	30.49	1DX1.NML	*	50.48
1-1/2 x 3/4	12	48	89	1DXE.BML	*	34.88	1DXE.NML	*	50.48
1-1/2 x 1/2	12	48	79	1DXD.BML	*	33.56	1DXD.NML	*	43.61
2 x 1-1/2	10	20	172	2X1D.BML	*	44.17	2X1D.NML	*	58.98
2 x 1-1/4	10	20	162	2X1B.BML	*	50.20	2X1B.NML	*	67.61
2 x 1	12	24	134	2X1.BML	*	50.20	2X1.NML	*	70.16
2 x 3/4	15	30	140	2XE.BML	*	53.22	2XE.NML	*	71.57
2 x 1/2	10	40	121	2XD.BML	*	42.18	2XD.NML	*	56.45
2-1/2 x 2	12	12	312	2DX2.BML		121.23	2DX2.NML		199.93
2-1/2 x 1-1/2	12	12	256	2DX1D.BML		128.37	2DX1D.NML		222.74
3 x 2	8	8	382	3X2.BML		195.99	3X2.NML		315.59
3 x 2-1/2	5	5	423	3X2D.BML		226.87	3X2D.NML		363.37
4 x 3	4	4	738	4X3.BML		387.74	4X3.NML		822.26



Fig. 48

**MALLEABLE IRON
45° ELBOWS
CLASS 150**

DESCRIPTION	PCS PER BOX	PCS PER MASTER	WEIGHT PER 100	PART # BLACK	PRICE (US\$) BLACK	PART # GALV.	PRICE (US\$) GALV.		
1/8	35	210	8	A.BM45L	*	11.11	A.NM45L		17.20
1/4	35	210	13	B.BM45L	*	11.11	B.NM45L	*	14.56
3/8	40	240	17	C.BM45L	*	11.11	C.NM45L	*	16.26
1/2	50	200	26	D.BM45L	*	8.43	D.NM45L	*	10.87
3/4	40	160	38	E.BM45L	*	10.43	E.NM45L	*	15.63
1	25	100	56	1.BM45L	*	13.14	1.NM45L	*	17.65
1-1/4	10	40	90	1B.BM45L	*	23.23	1B.NM45L	*	32.98
1-1/2	10	40	122	1D.BM45L	*	28.74	1D.NM45L	*	38.74
2	8	16	187	2.BM45L	*	43.46	2.NM45L	*	57.32
2-1/2	15	15	320	2D.BM45L		125.77	2D.NM45L		199.43
3	8	8	451	3.BM45L	*	163.36	3.NM45L	*	290.05
4	4	4	719	4.BM45L		320.32	4.NM45L		486.25
5	1	1	1120	5.BM45L		1,265.31	5.NM45L		1,964.88
6	1	1	1910	6.BM45L		1,294.55	6.NM45L		2,369.19

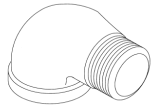

**MALLEABLE IRON
90° STREET ELLS
CLASS 150**

Fig. 50

DESCRIPTION	PCS PER BOX	PCS PER MASTER	WEIGHT PER 100	PART # BLACK	PRICE (US\$) BLACK	PART # GALV.	PRICE (US\$) GALV.
1/8	40	240	7	A.BMSL	*	10.88	A.NMSL
1/4	30	180	11	B.BMSL	*	10.88	B.NMSL
3/8	30	180	18	C.BMSL	*	10.88	C.NMSL
1/2	50	200	27	D.BMSL	#	10.56	D.NMSL
3/4	35	140	43	E.BMSL	#	10.56	E.NMSL
1	20	80	60	1.BMSL	#	14.96	1.NMSL
1-1/4	15	30	106	1B.BMSL	*	23.23	1B.NMSL
1-1/2	12	24	143	1D.BMSL	*	31.08	1D.NMSL
2	8	16	236	2.BMSL	*	50.52	2.NMSL
2-1/2	8	8	358	2D.BMSL		128.05	2D.NMSL
3	8	8	705	3.BMSL		195.46	3.NMSL
4	1	1	1065	4.BMSL		367.04	4.NMSL
1/2 x 3/8	35	280	22	DXC.BMSL		15.63	DXC.NMSL
3/4 x 1/2	25	100	36	EXD.BMSL		23.33	EXD.NMSL
1 x 3/4	25	100	56	1XE.BMSL		21.93	1XE.NMSL
1-1/4x3/4	15	60	75	1BXE.BMSL		60.25	1BXE.NMSL
1-1/4x1	15	30	101	1BX1.BMSL		31.55	1BX1.NMSL
1-1/2x1	15	30	134	1DX1.BMSL		46.34	1DX1.NMSL
1-1/2 x 1-1/4	16	32	140	1DX1B.BMSL	*	56.45	1DX1B.NMSL
2x1-1/2	12	24	19	2X1D.BMSL		80.85	2X1D.NMSL

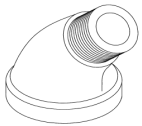

**MALLEABLE IRON
45° STREET ELLS
CLASS 150**

Fig. 51

DESCRIPTION	PCS PER BOX	PCS PER MASTER	WEIGHT PER 100	PART # BLACK	PRICE (US\$) BLACK	PART # GALV.	PRICE (US\$) GALV.
1/8	30	180	7	A.BMS45L	*	17.13	A.NMS45L
1/4	25	150	10	B.BMS45L		14.23	B.NMS45L
3/8	30	180	15	C.BMS45L	*	14.44	C.NMS45L
1/2	50	200	21	D.BMS45L	*	11.79	D.NMS45L
3/4	40	160	32	E.BMS45L	*	17.80	E.NMS45L
1	25	100	55	1.BMS45L	*	20.74	1.NMS45L
1-1/4	25	50	86	1B.BMS45L	*	35.84	1B.NMS45L
1-1/2	15	30	109	1D.BMS45L	*	46.22	1D.NMS45L
2	10	20	170	2.BMS45L	*	77.73	2.NMS45L



**MALLEABLE IRON
TEES
CLASS 150**

Fig. 52

DESCRIPTION	PCS PER BOX	PCS PER MASTER	WEIGHT PER 100	PART # BLACK	PRICE (US\$) BLACK	PART # GALV.	PRICE (US\$) GALV.
1/8	35	210	13	A.BMT	*	11.37	A.NMT
1/8 x 1/4	25	50	12	AXB.BMT		21.17	AXB.NMT
1/4	35	210	17	B.BMT	*	10.71	B.NMT
1/4 x 1/8	25	50	13	BXA.BMT		22.16	BXA.NMT
1/4 x 1/4 x 3/8	15	30	19	BXC.BMT		23.97	BXC.NMT
3/8	30	180	26	C.BMT	*	10.71	C.NMT
3/8 x 3/8 x 1/4	15	30	21	CXB.BMT		16.84	CXB.NMT
3/8 x 1/4 x 1/4	15	30	19	CXBXB.BMT		25.93	CXBXB.NMT
1/2	30	120	37	D.BMT	#	6.83	D.NMT
3/4	20	80	60	E.BMT	#	9.80	E.NMT
3/4 x 3/8 x 3/8	35	140	36	EXXC.BMT		61.86	
3/4 x 3/4 x 1-1/4	10	40	88	EX1B.BMT		48.94	EX1B.NMT
1	12	48	91	1.BMT	#	16.78	1.NMT
1-1/4	15	30	138	1B.BMT	*	27.18	1B.NMT
1-1/2	10	20	184	1D.BMT	*	33.79	1D.NMT
2	15	15	312	2.BMT	*	57.60	2.NMT
2-1/2	8	8	494	2D.BMT		124.19	2D.NMT
3	6	6	722	3.BMT		182.94	3.NMT
4	3	3	1215	4.BMT		442.14	4.NMT
1/2 x 1/2 x 3/8	35	140	36	DXC.BMT	*	14.92	DXC.NMT
1/2 x 1/2 x 1/4	25	100	29	DXB.BMT	*	11.62	DXB.NMT
1/2 x 3/8 x 1/2	35	140	36	DXCXD.BMT	*	18.18	DXCXD.NMT
1/2 x 3/8 x 3/8	35	140	32	DXCXC.BMT	*	18.18	DXCXC.NMT
1/2 x 1/4 x 1/2	35	140	32	DXBXD.BMT		12.21	DXBXD.NMT

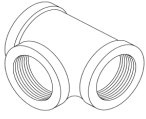

Fig. 52

**MALLEABLE IRON
TEES CLASS 150**
(continued)

DESCRIPTION	PCS PER BOX	PCS PER MASTER	WEIGHT PER 100	PART # BLACK		PRICE (US\$) BLACK	PART # GALV.		PRICE (US\$) GALV.
3/8 x 3/8 x 1/2	30	180	34	CXD.BMT	*	15.89	CXD.NMT		21.09
3/4 x 3/4 x 1/2	25	100	52	EXD.BMT	*	15.16	EXD.NMT	*	20.41
3/4 x 3/4 x 3/8	30	120	49	EXC.BMT	*	18.61	EXC.NMT		21.95
3/4 x 3/4 x 1/4	30	120	43	EXB.BMT	*	16.84	EXB.NMT		21.8
3/4 x 1/2 x 3/4	20	80	54	EXDXE.BMT	*	17.49	EXDXE.NMT	*	23.29
3/4 x 1/2 x 1/2	30	120	45	EXDXD.BMT	*	15.57	EXDXD.NMT	*	24.4
3/4 x 3/8 x 3/4	25	100	53	EXCXE.BMT		46.81			
3/4 x 1/4 x 3/4	30	120	48	EXBXE.BMT	*	23.23	EXBXE.NMT		31.83
3/4 x 3/4 x 1	15	60	73	EX1.BMT	*	23.08	EX1.NMT	*	35.14
1/2 x 1/2 x 3/4	30	120	46	DXE.BMT		17.49	DXE.NMT	*	24.4
1/2 x 1/2 x 1	25	100	65	DX1.BMT	*	28.61	DX1.NMT		40.99
1 x 1 x 3/4	25	50	79	1XE.BMT	*	19.13	1XE.NMT	*	28.66
1 x 1 x 1/2	15	60	71	1XD.BMT	*	19.13	1XD.NMT	*	28.66
1 x 1 x 3/8	20	80	66	1XC.BMT		26.89	1XC.NMT		36.56
1 x 1 x 1/4	20	80	63	1XB.BMT	*	24.22	1XB.NMT		39.87
1 x 1 x 1-1/4	15	30	123	1X1B.BMT		42.35	1X1B.NMT		57.93
1 x 1 x 1-1/2	8	16	113	1X1D.BMT	*	69.41	1X1D.NMT		107.8
1 x 3/4 x 1	20	40	82	1XEX1.BMT	*	22.21	1XEX1.NMT	*	35.8
1 x 3/4 x 3/4	20	40	71	1XEXE.BMT	*	20.24	1XEXE.NMT	*	34.54
1 x 3/4 x 1/2	20	40	68	1XEXD.BMT	*	21.91	1XEXD.NMT	*	35.8
1 x 1/2 x 1	15	60	76	1XD1.BMT	*	21.79	1XD1.NMT		35.8
1 x 1/2 x 3/4	20	80	65	1DXE.BMT	*	25.99	1DXE.NMT		36.56
1 x 1/2 x 1/2	20	80	54	1DXD.BMT	*	21.79	1DXD.NMT		35.8
1 x 1/4 x 1	15	60	73	1XB1.BMT		22.21	1XB1.NMT		37.09
1 x 1 x 2	12	24	170	1X2.BMT	*	89.27	1X2.NMT		111.95
1-1/4 x 3/4 x 1-1/4	15	30	125	1BXEX1B.BMT	*	36.79	1BXEX1B.NMT		52.84
1-1/4 x 3/4 x 1	10	40	119	1BXEX1.BMT	*	37.59	1BXEX1.NMT		58.27
1-1/4 x 3/4 x 3/4	10	40	98	1BXEXE.BMT		40.60	1BXEXE.NMT		61.29
1-1/4 x 1/2 x 1	10	40	94	1BXDX1.BMT	*	47.39	1BXDX1.NMT		70.19
1-1/4 x 1/2 x 1-1/4	10	40	119	1BXDX1B.BMT		40.60	1BXDX1B.NMT		56.34
1-1/4 x 1-1/4 x 3/8	10	40	85	1BXC.BMT	*	47.39	1BXC.NMT		74.8
1-1/4 x 1-1/4 x 1	14	28	116	1BX1.BMT	*	33.13	1BX1.NMT	*	44.45
1-1/4 x 1-1/4 x 3/4	12	24	109	1BXE.BMT	*	30.57	1BXE.NMT	*	44.45
1-1/4 x 1-1/4 x 1/2	15	30	99	1BXD.BMT	*	34.86	1BXD.NMT	*	46.98
1-1/4 x 1 x 1-1/4	15	30	123	1BX1X1B.BMT	*	42.86	1BX1X1B.NMT		57.03
1-1/4 x 1 x 1	15	30	109	1BX1X1.BMT		35.69	1BX1X1.NMT	*	53.94
1-1/4 x 1 x 3/4	15	30	98	1BX1XE.BMT	*	35.69	1BX1XE.NMT	*	56.34
1-1/4 x 1 x 1/2	15	60	86	1BX1XD.BMT	*	44.20	1BX1XD.NMT		59.85
1-1/4 x 1-1/4 x 1-1/2	10	20	153	1BX1D.BMT	*	53.40	1BX1D.NMT		79.17
1-1/4 x 2	12	24	183	1BX2.BMT		89.27	1BX2.NMT		111.95
1-1/2 x 3/4 x 1-1/2	10	20	153	1DXEX1D.BMT	*	48.52	1DXEX1D.NMT		70.64
1-1/2 x 3/4 x 3/4	10	40	108	1DXEXE.BMT	*	81.33	1DXEXE.NMT		103.11
1-1/2 x 1/2 x 1-1/2	10	20	154	1DXDX1D.BMT	*	48.52	1DXDX1D.NMT		77.46
1-1/2 x 1 x 1-1/4	15	30	142	1DX1X1B.BMT		62.86	1DX1X1B.NMT		86.91
1-1/2 x 1-1/2 x 1-1/4	8	16	175	1DX1B.BMT	*	47.72	1DX1B.NMT	*	68.76
1-1/2 x 1-1/2 x 1	10	20	149	1DX1.BMT	*	38.58	1DX1.NMT	*	54.92
1-1/2 x 1-1/2 x 3/4	10	20	132	1DXE.BMT	*	38.58	1DXE.NMT	*	54.92
1-1/2 x 1-1/2 x 1/2	8	32	121	1DXD.BMT	*	40.84	1DXD.NMT	*	58.03
1-1/2 x 1-1/4 x 1-1/2	10	20	180	1DX1BX1D.BMT	*	73.16	1DX1BX1D.NMT		97.92
1-1/2 x 1-1/4 x 1-1/4	10	20	163	1DX1BX1B.BMT	*	65.08	1DX1BX1B.NMT		97.92
1-1/2 x 1-1/4 x 1	8	16	151	1DX1BX1.BMT	*	41.65	1DX1BX1.NMT	*	66.75
1-1/2 x 1-1/4 x 3/4	10	20	135	1DX1BXE.BMT	*	48.52	1DX1BXE.NMT	*	70.64
1-1/2 x 1-1/4 x 1/2	10	20	111	1DX1BXD.BMT		53.40	1DX1BXD.NMT		81.48
1-1/2 x 1 x 1-1/2	10	20	165	1DX1X1D.BMT	*	48.52	1DX1X1D.NMT	*	70.64
1-1/2 x 1 x 1	10	20	135	1DX1X1.BMT	*	48.52	1DX1X1.NMT		70.64
1-1/2 x 1-1/2 x 2	8	16	220	1DX2.BMT	*	86.00	1DX2.NMT	*	108
2 x 2 x 1-1/2	8	16	247	2X1D.BMT	*	65.08	2X1D.NMT	*	94.39
2 x 2 x 1-1/4	8	16	229	2X1B.BMT	*	65.08	2X1B.NMT	*	94.39
2 x 2 x 1	10	20	198	2X1.BMT	*	60.46	2X1.NMT	*	78.67
2 x 2 x 3/4	10	20	181	2XE.BMT	*	60.46	2XE.NMT	*	80.17
2 x 2 x 1/2	10	20	172	2XD.BMT	*	61.61	2XD.NMT	*	89.33
2 x 1-1/2 x 2	6	12	259	2X1DX2.BMT	*	81.86	2X1DX2.NMT	*	99.86
2 x 1-1/2 x 1-1/2	8	16	235	2X1DX1D.BMT	*	74.34	2X1DX1D.NMT		97.96
2 x 1-1/2 x 1-1/4	8	16	208	2X1DX1B.BMT	*	75.78	2X1DX1B.NMT		99.86
2 x 1-1/2 x 1	8	16	194	2X1DX1.BMT	*	74.34	2X1DX1.NMT	*	94.32
2 x 1-1/4 x 2	8	16	267	2X1BX2.BMT	*	81.25	2X1BX2.NMT	*	115.33

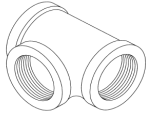

Fig. 52

**MALLEABLE IRON
TEES
CLASS 150
(continued)**

DESCRIPTION	PCS PER BOX	PCS PER MASTER	WEIGHT PER 100	PART # BLACK	PRICE (US\$) BLACK	PART # GALV.	PRICE (US\$) GALV.	
2 x 1-1/4 x 1-1/4	8	16	197	2X1BX1B.BMT	*	75.64	2X1BX1B.NMST	99.86
2 x 1-1/4 x 1-1/2	10	20	195	2X1BX1D.BMT		96.48	2X1BX1D.NMST	147.89
2 x 1 x 2	8	16	245	2X1X2.BMT	*	75.64	2X1X2.NMST	99.86
2 x 1 x 1	8	16	176	2X1X1.BMT	*	86.09	2X1X1.NMST	98.15
2 x 3/4 x 2	8	16	229	2XEX2.BMT	*	74.34	2XEX2.NMST	97.96
2 x 1/2 x 2	8	16	230	2XD2.BMT	*	75.64	2XD2.NMST	99.86
2 x 2 x 2-1/2	6	12	340	2X2D.BMT		193.48	2X2D.NMST	334.41
2-1/2 x 1-1/2 x 2	6	12	343	2DX1DX2.BMT		255.03	2DX1DX2.NMST	392.56
2-1/2 x 1-1/2 x 2-1/2	6	12	390	2DX1DX2D.BMT		193.48	2DX1DX2D.NMST	392.56
2-1/2 x 2 x 2	6	12	305	2DX2X2.BMT		186.45	2DX2X2.NMST	302.07
2-1/2 x 2 x 2-1/2	4	8	410	2DX2X2D.BMT		194.05	2DX2X2D.NMST	334.41
2-1/2 x 2-1/2 x 2	12	12	410	2DX2.BMT		161.56	2DX2.NMST	265.37
2-1/2 x 2-1/2 x 1-1/2	6	12	368	2DX1D.BMT		188.38	2DX1D.NMST	295.48
2-1/2 x 2-1/2 x 1-1/4	6	12	340	2DX1B.BMT		188.38	2DX1B.NMST	293.76
2-1/2 x 2-1/2 x 1	6	12	321	2DX1.BMT		188.38	2DX1.NMST	283.16
2-1/2 x 2-1/2 x 3/4	6	12	303	2DXE.BMT		181.43	2DXE.NMST	293.76
2-1/2 x 2-1/2 x 3	4	8	582	2DX3.BMT		341.19	2DX3.NMST	533.18
3-1/2	1	4	900	3D.BMT		423.57	3D.NMST	603.14
3 x 2 x 3	4	8	699	3X2X3.BMT		259.14	3X2X3.NMST	454.19
3 x 2-1/2 x 2	4	8	483	3X2DX2.BMT		341.19	3X2DX2.NMST	533.18
3 x 2-1/2 x 2-1/2	4	8	575	3X2DX2D.BMT		341.19	3X2DX2D.NMST	533.18
3 x 3 x 2-1/2	8	8	601	3X2D.BMT		256.33	3X2D.NMST	404.44
3 x 3 x 2	8	8	573	3X2.BMT		215.78	3X2.NMST	347.24
3 x 3 x 1-1/2	8	8	512	3X1D.BMT		224.33	3X1D.NMST	360.23
3 x 3 x 1-1/4	8	8	500	3X1B.BMT		228.44	3X1B.NMST	367.24
3 x 3 x 1	8	8	436	3X1.BMT		216.82	3X1.NMST	347.24
3 x 3 x 3/4	8	8	416	3XE.BMT		219.99	3XE.NMST	484.45
3 x 2 x 2	8	8	415	3X2X2.BMT		228.28	3X2X2.NMST	367.24
4 x 1-1/2	3	3	720	4X1D.BMT		523.29	4X1D.NMST	823.20
4 x 2	3	3	822	4X2.BMT		508.87	4X2.NMST	772.88
4 x 2-1/2	4	4	915	4X2D.BMT		586.73	4X2D.NMST	1,066.35
4 x 4 x 3	3	3	1174	4X3.BMT		523.29	4X3.NMST	966.35
4 x 3 x 4	4	4	1030	4X3X4.BMT		688.42	4X3X4.NMST	1,064.56
6	1	1	2550	6.BMT		1,437.89	6.NMST	2,119.00



Fig. 64

**MALLEABLE IRON
STREET TEES
CLASS 150**

DESCRIPTION	PCS PER BOX	PCS PER MASTER	WEIGHT PER 100	PART # BLACK	PRICE (US\$) BLACK	PART # GALV.	PRICE (US\$) GALV.	
1/4	25	50	15	B.BMST		21.93	B.NMST	31.46
1/2	15	120	35	D.BMST		20.19	D.NMST	33.33
3/4	20	80	58	E.BMST	*	24.97	E.NMST	31.94
3/8	12	24	25	C.BMST		24.44	C.NMST	35.19
1	12	24	98	1.BMST	*	33.00	1.NMST	50.51
1-1/4	10	20	162	1B.BMST	*	54.48	1B.NMST	84.23
1-1/4 x 1 x 1-1/4	8	16	128	1BX1X1B.BMST		79.78	1BX1X1B.NMST	120.62
1-1/2	12	24	197	1D.BMST		84.96	1D.NMST	128.40
2	6	12	316	2.BMST		156.43	2.NMST	245.82



Fig. 61

**MALLEABLE IRON
CROSSES
CLASS 150**

DESCRIPTION	PCS PER BOX	PCS PER MASTER	WEIGHT PER 100	PART # BLACK	PRICE (US\$) BLACK	PART # GALV.	PRICE (US\$) GALV.	
1/8	25	50	13	A.BMCR		31.21	A.NMCR	50.99
1/4	15	90	20	B.BMCR		24.86	B.NMCR	40.69
3/8	20	160	28	C.BMCR		25.75	C.NMCR	42.25
1/2	30	120	45	D.BMCR	*	25.82	D.NMCR	36.640
3/4	15	60	73	E.BMCR	*	31.24	E.NMCR	44.64
1	15	30	109	1.BMCR	*	38.49	1.NMCR	61.60
1-1/4	12	24	188	1B.BMCR	*	62.47	1B.NMCR	92.61
1-1/2	8	16	231	1D.BMCR	*	77.42	1D.NMCR	108.35
2	8	8	336	2.BMCR	*	127.29	2.NMCR	205.22
2-1/2	4	8	533	2D.BMCR		271.03	2D.NMCR	548.74
3	4	4	834	3.BMCR		376.02	3.NMCR	606.38
4	1	1	1290	4.BMCR		823.63	4.NMCR	1,493.21

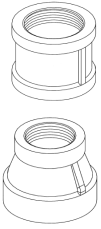

**MALLEABLE IRON
STRT & RED PIPE
COUPLINGS
CLASS 150**

Fig. 53

DESCRIPTION	PCS PER BOX	PCS PER MASTER	WEIGHT PER 100	PART # BLACK	PRICE (US\$) BLACK	PART # GALV.	PRICE (US\$) GALV.
1/8 (steel)	40	240	3	A.BSMC	*	10.62	A.NSMC
1/4	35	210	11	B.BMC	*	9.16	B.NMC
3/8	40	240	16	C.BMC	*	9.16	C.NMC
1/2	40	240	21	D.BMC	*	7.06	D.NMC
3/4	40	160	33	E.BMC	*	8.27	E.NMC
1	25	100	48	1.BMC	#	12.39	1.NMC
1-1/4	15	60	74	1B.BMC	*	16.04	1B.NMC
1-1/2	10	40	98	1D.BMC	*	21.67	1D.NMC
2	8	32	154	2.BMC	*	32.11	2.NMC
2-1/2	8	8	262	2D.BMC		88.62	2D.NMC
3	8	8	391	3.BMC		119.80	3.NMC
4	4	4	610	4.BMC		241.27	4.NMC
1/4 x 1/8	25	150	9	BXA.BMC	*	9.65	BXA.NMC
3/8 x 1/4	25	150	12	CXB.BMC	*	9.65	CXB.NMC
3/8 x 1/8	30	180	18	CXA.BMC		12.35	CXA.NMC
1/2 x 3/8	30	180	17	DXC.BMC	*	8.29	DXC.NMC
1/2 x 1/4	25	150	16	DXB.BMC	*	8.77	DXB.NMC
1/2 x 1/8	25	150	16	DXA.BMC	*	9.76	DXA.NMC
3/4 x 1/2	50	200	28	EXD.BMC	*	9.27	EXD.NMC
3/4 x 3/8	35	210	25	EXC.BMC	*	11.07	EXC.NMC
3/4 x 1/4	35	210	23	EXB.BMC	*	11.07	EXB.NMC
3/4 x 1/8	35	210	23	EXA.BMC	*	11.54	EXA.NMC
1 x 3/4	25	100	43	1XE.BMC	*	14.44	1XE.NMC
1 x 1/2	30	120	49	1XD.BMC	*	14.79	1XD.NMC
1 x 3/8	30	120	38	1XC.BMC	*	18.19	1XC.NMC
1 x 1/4	30	120	38	1XB.BMC		19.47	1XB.NMC
1-1/4 x 1	15	60	70	1BX1.BMC	*	18.58	1BX1.NMC
1-1/4 x 3/4	15	60	64	1BXE.BMC	*	18.58	1BXE.NMC
1-1/4 x 1/2	15	60	63	1BXD.BMC	*	21.79	1BXD.NMC
1-1/2 x 1-1/4	10	40	96	1DX1B.BMC	*	23.48	1DX1B.NMC
1-1/2 x 1	10	40	89	1DX1.BMC	*	27.23	1DX1.NMC
1-1/2 x 3/4	10	40	87	1DXE.BMC	*	31.24	1DXE.NMC
1-1/2 x 1/2	15	60	80	1DXD.BMC	*	27.72	1DXD.NMC
2 x 1-1/2	10	20	146	2X1D.BMC	*	34.02	2X1D.NMC
2 x 1-1/4	10	20	139	2X1B.BMC	*	38.57	2X1B.NMC
2 x 1	15	30	127	2X1.BMC	*	36.82	2X1.NMC
2 x 3/4	8	32	138	2XE.BMC	*	38.57	2XE.NMC
2 x 1/2	8	32	141	2XD.BMC	*	45.13	2XD.NMC
2-1/2 x 2	10	10	249	2DX2.BMC		78.21	2DX2.NMC
2-1/2 x 1-1/2	10	10	233	2DX1D.BMC		92.80	2DX1D.NMC
2-1/2 x 1-1/4	20	20	207	2DX1B.BMC		100.58	2DX1B.NMC
2-1/2 x 1	20	20	224	2DX1.BMC		100.58	2DX1.NMC
3 x 2-1/2	8	8	378	3X2D.BMC		118.22	3X2D.NMC
3 x 2	8	8	334	3X2.BMC		101.24	3X2.NMC
3 x 1-1/2	8	8	305	3X1D.BMC		122.25	3X1D.NMC
3 x 1-1/4	8	8	337	3X1B.BMC		126.83	3X1B.NMC
3 x 1	8	8	325	3X1.BMC		124.52	3X1.NMC
3-1/2 x 2	4	8	423	3DX2.BMC		386.41	3DX2.NMC
3-1/2 x 3	4	8	475	3DX3.BMC		386.41	3DX3.NMC
4 x 1-1/2	1	1	495	4X1D.BMC		293.65	4X1D.NMC
4 x 2-1/2	4	4	571	4X2D.BMC		274.83	4X2D.NMC
4 x 2	4	4	524	4X2.BMC		245.05	4X2.NMC
4 x 3	4	4	621	4X3.BMC		245.05	4X3.NMC
4 x 3-1/2	4	4	620	4X3D.BMC		386.41	4X3D.NMC
5 x 4	1	1	940	5X4.BMC		550.80	5X4.NMC
6 x 4	1	1	1085	6X4.BMC		707.44	6X4.NMC

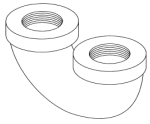

Fig. 60

**MALLEABLE IRON
RETURN BENDS
OPEN
CLASS 150**

DESCRIPTION	PCS PER BOX	PCS PER MASTER	WEIGHT PER 100	PART # BLACK	PRICE (US\$) BLACK	PART # GALV.	PRICE (US\$) GALV.
3/4	25	50	72	E.BMRB	55.52	E.NMRB	64.35
1	10	20	173	1.BMRB	51.59	1.NMRB	78.14

**MALLEABLE IRON
45 Y
CLASS 150**

DESCRIPTION	PCS PER BOX	PCS PER MASTER	WEIGHT PER 100	PART # BLACK	PRICE (US\$) BLACK	PART # GALV.	PRICE (US\$) GALV.
3/8	12	24	28	C.BM45Y	27.54	C.NM45Y	33.48
1/2	35	140	39	D.BM45Y	25.93	D.NM45Y	30.06
3/4	20	80	65	E.BM45Y	34.39	E.NM45Y	47.04
1	10	40	88	1.BM45Y	44.98	1.NM45Y	67.24
1-1/4	12	24	160	1B.BM45Y	77.73	1B.NM45Y	107.71
1-1/2	10	20	213	1D.BM45Y	108.57	1D.NM45Y	151.41
2	6	12	325	2.BM45Y	168.97	2.NM45Y	243.55
2-1/2	1	4	586	2D.BM45Y	430.41	2D.NM45Y	687.42
3	1	1	915	3.BM45Y	595.07	3.NM45Y	1,130.29
4	1	1	1570	4.BM45Y	1,254.02	4.NM45Y	1,865.29

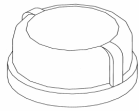

Fig. 49

**MALLEABLE IRON
CAPS
CLASS 150**

DESCRIPTION	PCS PER BOX	PCS PER MASTER	WEIGHT PER 100	PART # BLACK	PRICE (US\$) BLACK	PART # GALV.	PRICE (US\$) GALV.
1/4	40	240	6	B.BMCAP	* 6.79	B.NMCAP	* 9.23
3/8	40	240	10	C.BMCAP	* 5.69	C.NMCAP	* 9.23
1/2	50	300	17	D.BMCAP	* 5.16	D.NMCAP	* 7.62
3/4	40	240	24	E.BMCAP	* 6.99	E.NMCAP	* 10.54
1	25	150	42	1.BMCAP	* 8.45	1.NMCAP	* 13.06
1-1/4	25	100	62	1B.BMCAP	* 11.15	1B.NMCAP	* 17.20
1-1/2	20	80	83	1D.BMCAP	* 15.32	1D.NMCAP	* 22.04
2	10	40	129	2.BMCAP	* 22.35	2.NMCAP	* 30.87
2-1/2	6	12	189	2D.BMCAP	50.91	2D.NMCAP	89.67
3	6	12	291	3.BMCAP	* 75.64	3.NMCAP	108.67
3-1/2	8	16	322	3D.BMCAP	171.48	3D.NMCAP	298.27
4	5	10	566	4.BMCAP	129.69	4.NMCAP	240.09
5	4	8	740	5.BMCAP	309.14	5.NMCAP	644.18
6	3	3	995	6.BMCAP	566.86	6.NMCAP	814.11

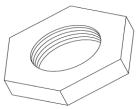

Fig. 55

**MALLEABLE IRON
LOCKNUT
CLASS 150**

DESCRIPTION	PCS PER BOX	PCS PER MASTER	WEIGHT PER 100	PART # BLACK	PRICE (US\$) BLACK	PART # GALV.	PRICE (US\$) GALV.
1/8 (steel)	100	600	2	A.BSLN	6.68	A.NSLN	7.59
1/4 (steel)	100	600	3	B.BSLN	* 6.15	B.NSLN	* 6.15
3/8	50	300	4	C.BMLN	* 8.52	C.NMLN	10.67
1/2	50	300	7	D.BMLN	* 7.31	D.NMLN	8.63
3/4	50	300	10	E.BMLN	* 7.96	E.NMLN	10.12
1	40	160	16	1.BMLN	* 15.26	1.NMLN	18.4
1-1/4	40	160	22	1B.BMLN	* 12.54	1B.NMLN	17.65
1-1/2	40	160	27	1D.BMLN	* 17.62	1D.NMLN	22.92
2	25	100	55	2.BMLN	* 29.23	2.NMLN	40.35

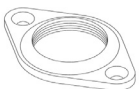

Fig. 62

**MALLEABLE IRON
WASTE NUT
CLASS 150**

DESCRIPTION	PCS PER BOX	PCS PER MASTER	WEIGHT PER 100	PART # BLACK	PRICE (US\$) BLACK	PART # GALV.	PRICE (US\$) GALV.
1/2	50	300	10	D.BMWN	15.09	D.NMWN	17.38
3/4	50	300	12	E.BMWN	18.21	E.NMWN	24.71
1	25	150	15	1.BMWN	13.63	1.NMWN	18.28

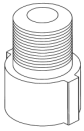

Fig. 54

**MALLEABLE IRON
EXTENSION PIECES
CLASS 150**

DESCRIPTION	PCS PER BOX	PCS PER MASTER	WEIGHT PER 100	PART # BLACK	PRICE (US\$) BLACK	PART # GALV.	PRICE (US\$) GALV.	
1/2	50	200	23	D.BME	*	15.76	D.NME	25.37
3/4	50	200	32	E.BME	*	23.22	E.NME	37.95
1	25	100	49	1.BME	*	33.51	1.NME	47.59
1-1/4	15	60	93	1B.BME	*	38.56	1B.NME	51.03

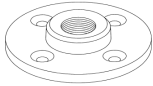

Fig. 15

**MALLEABLE IRON
FLOOR FLANGES
CLASS 150**

DESCRIPTION	PCS PER BOX	PCS PER MASTER	WEIGHT PER 100	PART # BLACK	PRICE (US\$) BLACK	PART # GALV.	PRICE (US\$) GALV.	
1/4 x 2-3/8	25	150	24	B.BMFF		23.82	B.NMFF	46.34
3/8 x 2-15/16	25	150	40	C.BMFF		23.82	C.NMFF	46.34
1/2 x 3	30	120	46	D.BMFF	*	23.82	D.NMFF	59.52
3/4 x 3-1/4	30	120	47	E.BMFF	*	23.82	E.NMFF	59.52
1 x 3-7/8	30	60	91	1.BMFF	*	29.93	1.NMFF	54.33
1-1/4 x 3-7/8	30	60	80	1B.BMFF	*	29.93	1B.NMFF	72.20
1-1/2 x 4-1/2	10	40	140	1D.BMFF	*	38.49	1D.NMFF	92.51
2 x 5-1/2	15	30	214	2.BMFF	*	46.31	2.NMFF	117.48
2-1/2 x 5-13/16	10	10	225	2D.BMFF		50.81	2D.NMFF	142.82
3 x 6-3/8	10	10	286	3.BMFF		64.16	3.NMFF	139.4



Fig. 53

**MALLEABLE IRON
LEFT & RIGHT HAND
THREAD COUPLINGS
CLASS 150**

DESCRIPTION	PCS PER BOX	PCS PER MASTER	WEIGHT PER 100	PART # BLACK	PRICE (US\$) BLACK	PART # GALV.	PRICE (US\$) GALV.	
1/2	40	240	21	D.BMCLR	*	14.81	D.NMCLR	19.41
3/4	40	160	33	E.BMCLR	*	16.62	E.NMCLR	22.46
1	25	100	50	1.BMCLR	*	24.69	1.NMCLR	33.11
1-1/4	15	60	74	1B.BMCLR	*	29.29	1B.NMCLR	42.48
1-1/2	10	40	101	1D.BMCLR	*	39.94	1D.NMCLR	54.61
2	8	32	154	2.BMCLR	*	53.41	2.NMCLR	73.62



Fig. 65

**MALLEABLE IRON
90° ELBOWS A.A.R.
CLASS 300**

DESCRIPTION	PCS PER BOX	PCS PER MASTER	WEIGHT PER 100	PART # BLACK	PRICE (US\$) BLACK	PART # GALV.	PRICE (US\$) GALV.	
1/4	35	210	22	B.B300L	*	25.86	B.N300L	46.31
3/8	20	120	32	C.B300L	*	22.97	C.N300L	47.23
1/2	15	90	55	D.B300L	*	29.77	D.N300L	56.25
3/4	12	48	87	E.B300L	*	33.67	E.N300L	63.15
1	10	40	127	1.B300L	*	43.00	1.N300L	80.98
1-1/4	10	20	203	1B.B300L	*	62.75	1B.N300L	127.21
1-1/2	8	16	265	1D.B300L	*	73.99	1D.N300L	137.87
2	5	10	413	2.B300L	*	106.44	2.N300L	231.69
2-1/2	6	6	650	2D.B300L		275.86	2D.N300L	515.66
3	6	6	1032	3.B300L		316.79	3.N300L	608.20
3/8 x 1/4	25	150	25	CXB.B300L		53.04		
1/2 x 3/8	25	100	58	DXC.B300L		55.05	DXC.N300L	73.83
3/4 x 1/2	15	60	69	EXD.B300L		40.56	EXD.N300L	71.98
1 x 1/2	20	40	95	1XD.B300L		83.49	1XD.N300L	102.14
1 x 3/4	10	40	111	1XE.B300L		81.18	1XE.N300L	113.79
1-1/4x3/4	15	30	135	1BXE.B300L		146.44		
1-1/4x1	15	30	155	1BX1.B300L		101.99		
1-1/2x1	10	20	185	1DX1.B300L		161.03		
1-1/2x1-1/4	10	20	215	1DX1B.B300L		161.03		
2x1-1/4	5	10	302	2X1B.B300L		226.25		
2x1-1/2	5	10	333	2X1D.B300L		201.76	2X1D.N300L	418.98
4	1	1	1635	4.B300L		744.26	4.N300L	1,817.66



Fig. 65A

**MALLEABLE IRON
45° ELBOWS A.A.R.
CLASS 300**

DESCRIPTION	PCS PER BOX	PCS PER MASTER	WEIGHT PER 100	PART # BLACK	PRICE (US\$) BLACK	PART # GALV.	PRICE (US\$) GALV.
1/4	35	210	23	B.B30045L			54.85
3/8	25	150	34	C.B30045L			54.85
1/2	20	80	51	D.B30045L	*		83.57
3/4	15	60	76	E.B30045L	*		96.61
1	10	40	119	1.B30045L	*		105.54
1-1/4	12	24	178	1B.B30045L	*		163.81
1-1/2	8	16	236	1D.B30045L	*		211.95
2	6	12	392	2.B30045L	*		293.59
2-1/2	4	8	530	2D.B30045L			784.46
3	3	6	825	3.B30045L			1,031.05
4	3	3	1341	4.B30045L			1,489.63

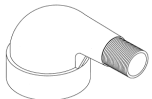
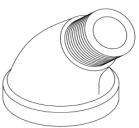

Fig. 65B

**MALLEABLE IRON
STREET 90° ELBOWS A.A.R.
CLASS 300**

DESCRIPTION	PCS PER BOX	PCS PER MASTER	WEIGHT PER 100	PART # BLACK	PRICE (US\$) BLACK	PART # GALV.	PRICE (US\$) GALV.
1/4	40	240	19	B.B300SL			48.73
3/8	35	140	31	C.B300SL			48.73
1/2	15	90	48	D.B300SL	*		95.48
3/4	12	48	76	E.B300SL	*		101.41
1	10	40	111	1.B300SL	*		132.61
1-1/4	12	24	176	1B.B300SL	*		173.22
1-1/2	10	20	133	1D.B300SL	*		222.68
2	6	12	376	2.B300SL	*		348.04
3	2	4	973	3.B300SL			



**MALLEABLE IRON
STREET 45° ELBOWS A.A.R.
CLASS 300**

DESCRIPTION	PCS PER BOX	PCS PER MASTER	WEIGHT PER 100	PART # BLACK	PRICE (US\$) BLACK	PART # GALV.	PRICE (US\$) GALV.
1/2	50	200	38	D.B300S45L	*		136.94
3/4	25	100	62	E.B300S45L	*		145.05
1	15	60	89	1.B300S45L			170.11
1 1/4	10	40	150	1B.B300S45L			
1 1/2	6	24	206	1D.B300S45L			
2	8	16	334	2.B300S45L			



Fig. 66

**MALLEABLE IRON
TEES A.A.R.
CLASS 300**

DESCRIPTION	PCS PER BOX	PCS PER MASTER	WEIGHT PER 100	PART # BLACK	PRICE (US\$) BLACK	PART # GALV.	PRICE (US\$) GALV.
1/4	25	150	32	B.B300T			65.91
3/8	15	90	45	C.B300T			67.13
1/2	15	60	75	D.B300T	*		84.04
3/4	10	40	120	E.B300T	*		92.56
1	12	24	171	1.B300T	*		114.12
1-1/4	8	16	273	1B.B300T	*		162.87
1-1/2	6	12	369	1D.B300T	*		169.36
2	4	8	559	2.B300T	*		270.75
3	4	4	1305	3.B300T			970.31
3/8 x 1/4	18	108	43	CXB.B300T			68.19
1/2 x 3/8	15	60	68	DXC.B300T			113.86
1/2 x 1/4	20	80	58	DXB.B300T			113.86
3/4 x 1/4	15	60	73	EXB.B300T			
3/4 x 3/8	13	52	80	EXC.B300T			
3/4 x 1/2	10	40	100	EXD.B300T	*		122.93
3/4 x 1/2 x 1/2	1	1	78	EXDXD.B300T			
3/4 x 1/2 x 3/4	13	52	93	EXDYE.B300T			
1 x 1/2 x 1	18	36	130	1XD1.B300T			
1 x 1/4	9	36	105	1XB.B300T			
1 x 3/4	7	28	155	1XE.B300T	*		161.46

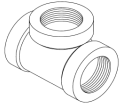

Fig. 66

MALLEABLE IRON TEES A.A.R. CLASS 300 (continued)

DESCRIPTION	PCS PER BOX	PCS PER MASTER	WEIGHT PER 100	PART # BLACK	PRICE (US\$) BLACK	PART # GALV.	PRICE (US\$) GALV.
1 x 3/4 x 3/4	10	40	123	1XEX.B300T	100.25		
1 x 3/4 x 1	9	36	136	1XEX1.B300T	112.52		
1 x 1/2	8	32	141	1XD.B300T	* 85.60	1XD.N300T	* 146.75
1-1/4 x 1/2	15	30	180	1BXD.B300T	130.85	1BXD.N300T	237.18
1-1/4 x 1	10	20	240	1BX1.B300T	* 118.27	1BX1.N300T	214.24
1-1/4 x 1 x 1	14	28	193	1BX1X1.B300T	130.85		
1-1/4 x 3/4	10	20	239	1BXE.B300T	113.96	1BXE.N300T	214.24
1-1/2 x 1	8	16	298	1DX1.B300T	* 138.66	1DX1.N300T	262.95
1-1/2 x 1-1/4	9	18	305	1DX1B.B300T	156.22	1DX1B.N300T	
1-1/2 x 1/2	10	20	249	1DXD.B300T	155.16	1DXD.N300T	266.89
1-1/2 x 3/4	9	18	262	1DXE.B300T	* 138.66	1DXE.N300T	262.95
2 x 1/2	6	12	363	2XD.B300T	* 223.56	2XD.N300T	* 419.41
2 x 3/4	8	16	386	2XE.B300T	223.56	2XE.N300T	419.41
2 x 1	6	12	421	2X1.B300T	223.56	2X1.N300T	354.44
2 x 1-1/4	6	12	425	2X1B.B300T	229.88	2X1B.N300T	506.31
2 x 1-1/2	5	10	483	2X1D.B300T	* 207.91	2X1D.N300T	389.57
2 x 1-1/2 x 2	5	10	470	2X1DX2.B300T	269.86		
2-1/2	4	4	840	2D.B300T	341.95	2D.N300T	855.92
2-1/2 x 1-1/2	4	8	653	2DX1D.B300T	383.16		
2-1/2 x 2	1	1	760	2DX2.B300T			
3 x 2	4	4	990	3X2.B300T	972.91	3X2.N300T	1,745.98
4	1	1	2340	4.B300T	1,389.11	4.N300T	2,491.56



Fig. 68

MALLEABLE IRON CROSSES A.A.R. CLASS 300

DESCRIPTION	PCS PER BOX	PCS PER MASTER	WEIGHT PER 100	PART # BLACK	PRICE (US\$) BLACK	PART # GALV.	PRICE (US\$) GALV.
1/4	1	1	35	B.B300CR	87.88		
1/2	12	48	89	D.B300CR	122.32	D.N300CR	218.79
3/4	15	30	136	E.B300CR	* 144.25	E.N300CR	318.52
1	12	24	199	1.B300CR	157.35	1.N300CR	358.80
1-1/4	7	14	311	1B.B300CR	159.62	1B.N300CR	328.19
1-1/2	5	10	427	1D.B300CR	* 275.31	1D.N300CR	439.51
2	3	6	665	2.B300CR	* 299.78	2.N300CR	627.58

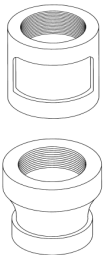

Fig. 67

MALLEABLE IRON COUPLINGS AND REDUCERS A.A.R. CLASS 300

DESCRIPTION	PCS PER BOX	PCS PER MASTER	WEIGHT PER 100	PART # BLACK	PRICE (US\$) BLACK	PART # GALV.	PRICE (US\$) GALV.
1/4	35	210	18	B.B300C	23.33	B.N300C	30.38
3/8	25	150	31	C.B300C	23.33	C.N300C	43.73
1/2	20	80	48	D.B300C	* 26.03	D.N300C	44.85
3/4	30	60	74	E.B300C	* 29.95	E.N300C	50.66
1	10	40	110	1.B300C	* 34.25	1.N300C	67.03
1-1/4	12	24	174	1B.B300C	* 40.73	1B.N300C	87.36
1-1/2	10	20	223	1D.B300C	* 60.99	1D.N300C	123.27
2	6	12	365	2.B300C	* 87.84	2.N300C	* 149.29
2-1/2	5	10	535	2D.B300C	161.78	2D.N300C	392.56
3/8 x 1/4	25	150	25	CXB.B300C	30.84	CXB.N300C	43.75
1/2 x 3/8	30	120	39	DXC.B300C	* 37.14	DXC.N300C	63.37
1/2 x 1/4	20	120	35	DXB.B300C	* 37.14	DXB.N300C	63.37
3/4 x 1/4	45	90	45	EXB.B300C	52.97		
3/4 x 3/8	45	90	47	EXC.B300C	52.97	EXC.N300C	101.73
3/4 x 1/2	20	80	55	EXD.B300C	* 37.97	EXD.N300C	76.92
1 x 1/4	15	60	67	1XB.B300C	63.49	1XB.N300C	123.89
1 x 1/2	15	60	78	1XD.B300C	* 46.26	1XD.N300C	93.74
1 x 3/4	12	48	83	1XE.B300C	* 45.36	1XE.N300C	91.87
1 x 3/8	20	80	65	1XC.B300C	63.49	1XC.N300C	123.89
1-1/4 x 1/2	22	44	107	1BXD.B300C	94.72	1BXD.N300C	151.76
1-1/4 x 3/4	15	30	123	1BXE.B300C	* 61.95	1BXE.N300C	114.83
1-1/4 x 1	18	36	134	1BX1.B300C	* 59.73	1BX1.N300C	104.40
1-1/2 x 1/2	16	32	147	1DXD.B300C	98.38	1DXD.N300C	188.15
1-1/2 x 1	14	28	166	1DX1.B300C	* 81.79	1DX1.N300C	142.29
1-1/2 x 3/4	15	30	159	1DXE.B300C	* 84.95	1DXE.N300C	142.29
1-1/2 x 1-1/4	12	24	189	1DX1B.B300C	* 93.03	1DX1B.N300C	156.99
2 x 1-1/4	6	12	275	2X1B.B300C	145.02	2X1B.N300C	303.86
2 x 1-1/2	8	16	292	2X1D.B300C	* 117.60	2X1D.N300C	203.62

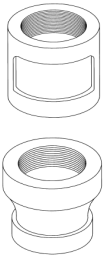

Fig. 67

MALLEABLE IRON COUPLINGS AND REDUCERS A.A.R. CLASS 300 (continued)

DESCRIPTION	PCS PER BOX	PCS PER MASTER	WEIGHT PER 100	PART # BLACK	PRICE (US\$) BLACK	PART # GALV.	PRICE (US\$) GALV.
2 x 1/2	12	24	228	2XD.B300C	141.98		
2 x 3/4	10	20	235	2XE.B300C	141.98	2XE.N300C	301.02
2 x 1	8	16	264	2X1.B300C	118.61	2X1.N300C	228.14
2-1/2 x 1-1/2	4	8	388	2DX1D.B300C	228.96	2DX1D.N300C	555.55
2-1/2 x 2	5	10	437	2DX2.B300C	228.96	2DX2.N300C	555.55
3	3	6	713	3.B300C	233.04	3.N300C	467.34
3 x 1-1/2	4	8	560	3X1D.B300C	408.97		
3 x 2	4	8	566	3X2.B300C	335.51	3X2.N300C	840.06
3 x 2-1/2	4	8	643	3X2D.B300C	348.37	3X2D.N300C	840.06
4 x 2	1	1	920	4X2.B300C	708.01		
4 x 3	4	4	985	4X3.B300C	708.01		



Fig. 69

MALLEABLE IRON CAPS A.A.R. CLASS 300

DESCRIPTION	PCS PER BOX	PCS PER MASTER	WEIGHT PER 100	PART # BLACK	PRICE (US\$) BLACK	PART # GALV.	PRICE (US\$) GALV.
1/4	50	300	13	B.B300CAP	23.93	B.N300CAP	30.99
3/8	40	240	18	C.B300CAP	23.93	C.N300CAP	30.99
1/2	40	160	28	D.B300CAP	23.73	D.N300CAP	45.46
3/4	25	100	45	E.B300CAP	29.95	E.N300CAP	54.35
1	15	60	73	1.B300CAP	39.28	1.N300CAP	74.57
1-1/4	10	40	110	1B.B300CAP	43.53	1B.N300CAP	88.23
1-1/2	15	30	140	1D.B300CAP	63.58	1D.N300CAP	123.68
2	10	20	218	2.B300CAP	88.36	2.N300CAP	171.17
2-1/2	10	10	340	2D.B300CAP	170.33	2D.N300CAP	405.16
3	8	16	463	3.B300CAP	235.06	3.N300CAP	553.23

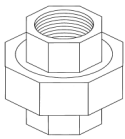

Fig. 91

MALLEABLE IRON UNIONS BRASS TO IRON CLASS 150

DESCRIPTION	PCS PER BOX	PCS PER MASTER	WEIGHT PER 100	PART # BLACK	PRICE (US\$) BLACK	PART # GALV.	PRICE (US\$) GALV.
1/8	25	150	27	A.BU	41.31	A.NU	58.88
1/4	35	210	24	B.BU	38.23	B.NU	51.85
3/8	30	180	32	C.BU	26.34	C.NU	34.71
1/2	40	160	41	D.BU	23.85	D.NU	31.65
3/4	30	60	67	E.BU	27.41	E.NU	36.38
3/4 x 1/2	40	160	41	EXD.BU	48.64	EXD.NU	60.53
1	25	50	88	1.BU	35.73	1.NU	47.64
1-1/4	15	30	151	1B.BU	51.24	1B.NU	68.88
1-1/2	12	24	188	1D.BU	63.89	1D.NU	83.45
2	8	16	265	2.BU	74.28	2.NU	95.95
2-1/2	8	8	518	2D.BU	221.35	2D.NU	333.28
3	8	8	763	3.BU	266.45	3.NU	466.46
4	1	2	1451	4.BU	657.67	4.NU	945.06

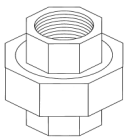

Fig. 92

MALLEABLE IRON UNIONS BRASS TO IRON CLASS 250

DESCRIPTION	PCS PER BOX	PCS PER MASTER	WEIGHT PER 100	PART # BLACK	PRICE (US\$) BLACK	PART # GALV.	PRICE (US\$) GALV.
1/8	25	150	15	A.B250U	104.01	A.N250U	134.18
1/4	35	210	25	B.B250U	41.96	B.N250U	54.12
3/8	30	180	38	C.B250U	42.25	C.N250U	54.92
1/2	40	80	60	D.B250U	44.75	D.N250U	72.11
3/4	30	60	102	E.B250U	44.01	E.N250U	65.51
1	18	36	120	1.B250U	54.01	1.N250U	81.23
1-1/4	12	24	190	1B.B250U	90.59	1B.N250U	123.01
1-1/2	10	20	243	1D.B250U	104.32	1D.N250U	141.61
2	6	12	412	2.B250U	133.81	2.N250U	200.00
2-1/2	8	8	540	2D.B250U	419.42	2D.N250U	526.09
3	8	8	842	3.B250U	490.88	3.N250U	807.16
4	1	2	1451	4.B250U	870.07	4.N250U	1,266.14

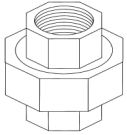

Fig. 93

**MALLEABLE IRON
UNIONS BRASS
TO IRON A.A.R.
CLASS 300**

DESCRIPTION	PCS PER BOX	PCS PER MASTER	WEIGHT PER 100	PART # BLACK	PRICE (US\$) BLACK	PART # GALV.	PRICE (US\$) GALV.
1/8	25	150	15	A.B300U	61.21	A.N300U	68.33
1/4	35	210	25	B.B300U	55.84	B.N300U	75.85
3/8	30	180	38	C.B300U	56.51	C.N300U	77.36
1/2	40	80	57	D.B300U	* 45.72	D.N300U	* 73.36
3/4	30	60	109	E.B300U	* 50.62	E.N300U	* 79.54
1	18	36	129	1.B300U	* 66.09	1.N300U	* 105.52
1-1/4	12	24	208	1B.B300U	* 107.78	1B.N300U	* 147.15
1-1/2	10	20	252	1D.B300U	* 112.87	1D.N300U	* 177.17
2	6	12	428	2.B300U	* 139.81	2.N300U	* 212.66
2-1/2	8	8	541	2D.B300U	450.77	2D.N300U	593.19
3	8	8	872	3.B300U	583.17	3.N300U	1,003.25
4	1	1	1730	4.B300U	1,850.89	4.N300U	2,516.20

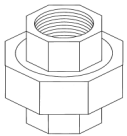

Fig. 94

**MALLEABLE IRON
UNIONS ALL IRON
CLASS 150**

DESCRIPTION	PCS PER BOX	PCS PER MASTER	WEIGHT PER 100	PART # BLACK	PRICE (US\$) BLACK	PART # GALV.	PRICE (US\$) GALV.
1/8	25	150	13	A.BA1U	39.00	A.NA1U	40.81
1/4	35	210	24	B.BA1U	39.00	B.NA1U	49.69
3/8	35	210	30	C.BA1U	39.00	C.NA1U	49.69
1/2	40	160	40	D.BA1U	* 40.29	D.NA1U	52.88
3/4	30	60	68	E.BA1U	* 45.66	E.NA1U	* 58.76
1	25	50	88	1.BA1U	* 59.09	1.NA1U	78.41
1-1/4	15	30	149	1B.BA1U	* 81.53	1B.NA1U	107.48
1-1/2	12	24	182	1D.BA1U	* 99.40	1D.NA1U	129.73
2	8	16	260	2.BA1U	* 125.40	2.NA1U	153.78
2-1/2	8	8	520	2D.BA1U	260.25	2D.NA1U	399.64
3	8	8	772	3.BA1U	422.60	3.NA1U	622.81

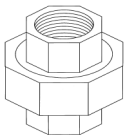

Fig. 99

**MALLEABLE IRON
UNIONS ALL IRON
A.A.R.
CLASS 300**

DESCRIPTION	PCS PER BOX	PCS PER MASTER	WEIGHT PER 100	PART # BLACK	PRICE (US\$) BLACK	PART # GALV.	PRICE (US\$) GALV.
1/8	25	150	16	A.BA1300U	62.09	A.NA1300U	79.20
1/4	35	210	28	B.BA1300U	86.49	B.NA1300U	83.14
3/8	30	180	37	C.BA1300U	86.49	C.NA1300U	82.32
1/2	40	80	60	D.BA1300U	91.13	D.NA1300U	110.57
3/4	30	60	107	E.BA1300U	* 97.80	E.NA1300U	121.62
1	18	36	125	1.BA1300U	* 119.93	1.NA1300U	206.72
1-1/4	15	30	206	1B.BA1300U	* 184.01	1B.NA1300U	225.17
1-1/2	10	20	253	1D.BA1300U	* 224.68	1D.NA1300U	272.82
2	5	10	418	2.BA1300U	284.35	2.NA1300U	338.52
2-1/2	8	8	533	2D.BA1300U	* 503.88	2D.NA1300U	661.01
3	8	8	854	3.BA1300U	957.71	3.NA1300U	1,060.60

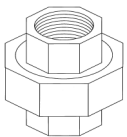

Fig. 98

**MALLEABLE IRON
UNIONS BRASS TO
BRASS A.A.R.
CLASS 300**

DESCRIPTION	PCS PER BOX	PCS PER MASTER	WEIGHT PER 100	PART # BLACK	PRICE (US\$) BLACK	PART # GALV.	PRICE (US\$) GALV.
1/4	30	180	26	B.BBBU	50.29	B.NBBU	66.33
3/8	30	180	38	C.BBBU	53.72	C.NBBU	71.21
1/2	25	100	57	D.BBBU	* 56.53	D.NBBU	* 73.81
3/4	25	50	103	E.BBBU	* 63.27	E.NBBU	* 85.06
1	18	36	130	1.BBBU	* 81.00	1.NBBU	114.87
1-1/4	15	30	208	1B.BBBU	* 105.56	1B.NBBU	150.62
1-1/2	12	24	252	1D.BBBU	* 126.78	1D.NBBU	* 176.06
2	5	10	417	2.BBBU	* 173.65	2.NBBU	* 235.49
2-1/2	3	3	541	2D.BBBU	500.48	2D.NBBU	235.49
3	3	3	872	3.BBBU	609.17	3.NBBU	629.32
4	1	2	1517	4.BBBU	1,243.87	4.NBBU	1,758.8

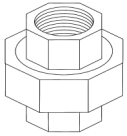
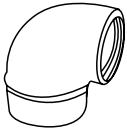

Fig. 95

MALLEABLE IRON GASKET UNIONS CLASS 150

DESCRIPTION	PCS PER BOX	PCS PER MASTER	WEIGHT PER 100	PART # BLACK	PRICE (US\$) BLACK	PART # GALV.	PRICE (US\$) GALV.
3/8	35	210	29	C.BGU	40.91	C.NGU	49.07
1/2	40	160	38	D.BGU	43.19	D.NGU	62.71
3/4	30	60	65	E.BGU	48.73	E.NGU	68.63
1	25	50	82	1.BGU	63.12	1.NGU	88.98
1-1/4	15	30	141	1B.BGU	87.17	1B.NGU	122.38
1-1/2	15	30	172	1D.BGU	105.93	1D.NGU	149.43
2	8	16	262	2.BGU	132.13	2.NGU	183.98



MALLEABLE IRON GROOVED X THREADED REDUCING 90° ELBOW

NEW PRODUCT

DESCRIPTION	PCS PER BOX	PCS PER MASTER	WEIGHT PER 100	PART # BLACK	PRICE (US\$) BLACK	PART # GALV.	PRICE (US\$) GALV.
1 1/4 x 1	35		.8	1BX1.BMEL	74.89		
1 1/2 x 1	30		1.0	1DX1.BMEL	83.26		
2 x 1	25		1.2	2X1.BMEL	104.08		

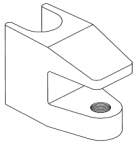

TOP BEAM CLAMPS

DESCRIPTION	PCS PER BOX	PCS PER MASTER	WEIGHT PER 100	PART # BLACK	PRICE (US\$) BLACK	PART # GALV.	PRICE (US\$) GALV.
3/8 Small Mouth	50	200	31	C.BSBC	* Consult Factory	C.NSBC	* Consult Factory
1/2 Small Mouth	100	100	46	D.BSBC	* Consult Factory	D.NSBC	* Consult Factory
3/8 Wide Mouth	100	100	52	C.BWBC	* Consult Factory	C.NWBC	* Consult Factory
1/2 Wide Mouth	100	100	50	D.BWBC	* Consult Factory	D.NWBC	Consult Factory

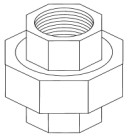
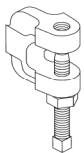

Fig. 96

DIE ELECTRICAL UNIONS CLASS 150

DESCRIPTION	PCS PER BOX	PCS PER MASTER	WEIGHT PER 100	PART # BLACK	PRICE (US\$) BLACK	PART # GALV.	PRICE (US\$) GALV.
1/2 W	40	160	40			D.NDEUW	57.52
3/4 W	30	120	38			E.NDEUW	56.25



C-CLAMPS

DESCRIPTION	PCS PER BOX	PCS PER MASTER	WEIGHT PER 100	PART # BLACK	PRICE (US\$) BLACK	PART # GALV.	PRICE (US\$) GALV.
3/8 C-Clamp	100	100	28	C.BCC	* Consult Factory		
1/2 C-Clamp	100	100	28	D.BCC	* Consult Factory		

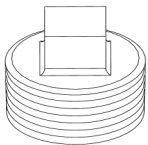
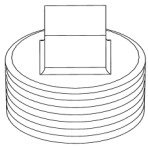

Fig. 01 & 02

CAST IRON PLUGS - REGULAR CORED

DESCRIPTION	PCS PER BOX	PCS PER MASTER	WEIGHT PER 100	PART # BLACK	PRICE (US\$) BLACK	PART # GALV.	PRICE (US\$) GALV.
1/2	100	600	10	D.BP	* 3.78	D.NP	* 8.02
3/4	70	420	15	E.BP	* 4.77	E.NP	* 10.20
1	40	240	25	1.BP	* 4.77	1.NP	* 10.20
1-1/4	40	160	43	1B.BP	* 7.60	1B.NP	* 17.01
1-1/2	40	80	64	1D.BP	* 10.76	1D.NP	* 22.98
2	25	50	94	2.BP	* 12.56	2.NP	* 28.54
2-1/2	20	40	130	2D.BP	30.59	2D.NP	60.31
3	10	20	198	3.BP	* 35.43	3.NP	77.22
3-1/2	10	20	208	3D.BP	86.44	3D.NP	141.02
4 SQUARE HEAD	5	10	409	4.BPSH	73.64	4.NPSH	211.92
4 BAR HEAD	5	10	399	4.BP	* 72.98	4.NP	149.77
5 BAR HEAD	5	5	627	5.BP	137.18	5.NP	297.76
6 BAR HEAD	4	4	970	6.BP	179.08	6.NP	338.73



**CAST IRON PLUGS
- SOLID**

Fig. 03 & 04

DESCRIPTION	PCS PER BOX	PCS PER MASTER	WEIGHT PER 100	PART # BLACK	PRICE (US\$) BLACK	PART # GALV.	PRICE (US\$) GALV.		
1/2	100	600	10	D.BSP	*	4.22	D.NSP	*	9.45
3/4	50	300	17	E.BSP	*	12.75	E.NSP		26.99
1	30	180	33	1.BSP	*	13.58	1.NSP		30.60
1-1/4	30	120	57	1B.BSP	*	15.63	1B.NSP		33.35
1-1/2	40	80	80	1D.BSP	*	22.16	1D.NSP		44.46
2	25	50	125	2.BSP		28.60	2.NSP		63.35
2-1/2	10	20	195	2D.BSP		42.33	2D.NSP		81.54
3	10	20	350	3.BSP		72.21	3.NSP		143.83
4 BAR HEAD	5	10	576	4.BSP		160.59	4.NSP		282.20
5 BAR HEAD	5	5	970	5.BSP		298.47			

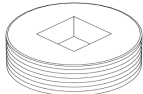

CAST IRON COUNTERSUNK PLUGS

Fig. 05

DESCRIPTION	PCS PER BOX	PCS PER MASTER	WEIGHT PER 100	PART # BLACK	PRICE (US\$) BLACK	PART # GALV.	PRICE (US\$) GALV.		
1/2 MI	100	600	6	D.BCTP		8.64	D.NCTP		13.01
3/4 MI	80	480	10	E.BCTP		11.75	E.NCTP		20.24
1 MI	40	240	22	1.BCTP		16.45	1.NCTP		32.33
1-1/4	40	160	35	1B.BCTP		17.20	1B.NCTP		34.19
1-1/2	50	100	48	1D.BCTP		20.59	1D.NCTP		45.96
2	40	80	84	2.BCTP		30.38	2.NCTP		64.35
2-1/2	20	40	150	2D.BCTP		48.02	2D.NCTP		95.61
3	10	20	225	3.BCTP		78.43	3.NCTP		146.09
4	5	5	390	4.BCTP		211.38	4.NCTP		432.54

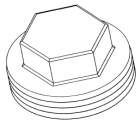

HEX HEAD CLEANOUT PLUGS

Fig. 06

DESCRIPTION	PCS PER BOX	PCS PER MASTER	WEIGHT PER 100	PART # BLACK	PRICE (US\$) BLACK	PART # GALV.	PRICE (US\$) GALV.		
1-1/4	1	1	28	1B.BCOP		8.97	1B.NCOP		16.82
4	1	1	172	4.BCOP		59.59	4.NCOP		152.71

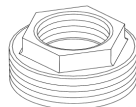

HEXAGON BUSHINGS

DESCRIPTION	PCS PER BOX	PCS PER MASTER	WEIGHT PER 100	PART # BLACK	PRICE (US\$) BLACK	PART # GALV.	PRICE (US\$) GALV.		
3/8x1/4	25	150	3	CXB.BMB	*	9.58	CXB.NMB		15.27
1/2x3/8	25	150	6	DXC.BMB	*	9.58	DXC.NMB	*	15.27
1/2x1/4	25	150	7	DXB.BMB	*	9.58	DXB.NMB		15.27
1/2x1/8	25	150	8	DXA.BMB	*	9.58	DXA.NMB		15.27
3/4 x 1/2	25	150	10	EXD.BB	*	8.29	EXD.NB		13.83
3/4 x 3/8	25	150	11	EXC.BB	*	9.22	EXC.NB	*	18.06
3/4 x 1/4	25	150	12	EXB.BB	*	8.98	EXB.NB	*	16.16
3/4 x 1/8	25	150	15	EXA.BB	*	9.46	EXA.NB	*	16.61
1 x 3/4	25	150	17	1XE.BB	*	8.72	1XE.NB	*	15.89
1 x 1/2	25	150	21	1XD.BB	*	8.84	1XD.NB	*	17.07
1 x 3/8	25	150	18	1XC.BB	*	11.95	1XC.NB	*	18.97
1 x 1/4	25	150	25	1XB.BB	*	11.62	1XB.NB	*	18.87
1 x 1/8	25	150	21	1XA.BB	*	13.46	1XA.NB	*	22.22
1-1/4 x 1	25	150	30	1BX1.BB	*	11.37	1BX1.NB	*	21.41
1-1/4 x 3/4	25	150	38	1BXE.BB	*	11.37	1BXE.NB	*	21.41
1-1/4 x 1/2	25	150	31	1BXD.BB	*	12.94	1BXD.NB	*	24.26
1-1/4 x 3/8	25	150	34	1BXC.BB	*	13.99	1BXC.NB		28.47
1-1/4 x 1/4	25	150	36	1BXB.BB		16.71	1BXB.NB		28.47
1-1/4 x 1/8	25	150	36	1BXA.BB		16.20	1BXA.NB	*	27.80
1-1/2 x 1-1/4	30	120	31	1DX1B.BB	*	14.44	1DX1B.NB	*	25.82
1-1/2 x 1	30	120	47	1DX1.BB	*	12.99	1DX1.NB	*	26.94
1-1/2 x 3/4	30	120	43	1DXE.BB	*	14.80	1DXE.NB	*	29.82
1-1/2 x 1/2	30	120	40	1DXD.BB	*	14.80	1DXD.NB	*	29.82
1-1/2 x 3/8	30	120	47	1DXC.BB	*	22.07	1DXC.NB	*	38.36
1-1/2 x 1/4	15	90	49	1DXB.BB	*	19.46	1DXB.NB	*	38.36
1-1/2 x 1/8	30	120	62	1DXA.BB		18.18	1DXA.NB		34.42
2 x 1-1/2	20	80	61	2X1D.BB	*	18.18	2X1D.NB	*	29.96
2 x 1-1/4	20	80	85	2X1B.BB	*	17.77	2X1B.NB	*	34.74

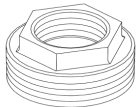
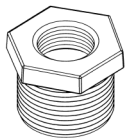

Fig. 09

HEXAGON BUSHINGS (continued)

DESCRIPTION	PCS PER BOX	PCS PER MASTER	WEIGHT PER 100	PART # BLACK	PRICE (US\$) BLACK	PART # GALV.	PRICE (US\$) GALV.
2 x 1	20	80	75	2X1.BB	*	2X1.NB	34.74
2 x 3/4	20	80	61	2XE.BB	*	2XE.NB	34.74
2 x 1/2	20	80	60	2XD.BB	*	2XD.NB	37.37
2 x 3/8	20	80	71	2XC.BB	*	2XC.NB	44.46
2 x 1/4	20	80	73	2XB.BB	*	2XB.NB	43.44
2-1/2 x 2	20	20	113	2DX2.BB	*	2DX2.NB	49.86
2-1/2 x 1-1/2	20	20	111	2DX1D.BB		2DX1D.NB	56.95
2-1/2 x 1-1/4	20	20	105	2DX1B.BB		2DX1B.NB	63.26
2-1/2 x 1	20	20	90	2DX1.BB		2DX1.NB	63.26
2-1/2 x 3/4	20	20	120	2DXE.BB		2DXE.NB	63.26
2-1/2 x 1/2	20	20	102	2DXD.BB		2DXD.NB	63.26
3 x 2-1/2	10	10	161	3X2D.BB		3X2D.NB	69.66
3 x 2	10	20	164	3X2.BB		3X2.NB	64.89
3 x 1-1/2	10	20	157	3X1D.BB		3X1D.NB	75.11
3 x 1-1/4	10	20	152	3X1B.BB		3X1B.NB	81.52
3 x 1	10	20	168	3X1.BB		3X1.NB	83.45
3 x 3/4	10	20	190	3XE.BB		3XE.NB	83.45
3 x 1/2	10	20	155	3XD.BB		3XD.NB	83.45
3 x 1/4	10	20	197	3XB.BB		3XB.NB	77.41
3-1/2 x 3	10	10	247	3DX3.BB		3DX3.NB	148.20
3-1/2 x 2-1/2	10	10	198	3DX2D.BB		3DX2D.NB	148.20
3-1/2 x 2	10	10	190	3DX2.BB		3DX2.NB	148.20
3-1/2 x 1-1/2	10	10	234	3DX1D.BB		3DX1D.NB	148.20
3-1/2 x 1-1/4	10	10	212	3DX1B.BB		3DX1B.NB	135.26
3-1/2 x 1	10	10	219	3DX1.BB		3DX1.NB	135.26
3-1/2 x 3/4	10	10	228	3DXE.BB			
4 x 3-1/2	10	10	200	4X3D.BB		4X3D.NB	174.89
4 x 3	10	10	318	4X3.BB		4X3.NB	136.25
4 x 2-1/2	10	10	280	4X2D.BB		4X2D.NB	174.89
4 x 2	10	10	270	4X2.BB		4X2.NB	136.25
4 x 1-1/2	10	10	286	4X1D.BB		4X1D.NB	174.89
4 x 1-1/4	10	10	250	4X1B.BB		4X1B.NB	174.89
4 x 1	10	10	273	4X1.BB		4X1.NB	174.89
4 x 1/2	10	10	291	4XD.BB		4XD.NB	162.33
5 x 4	10	10	474	5X4.BB		5X4.NB	288.77
5 x 3	10	10	496	5X3.BB		5X3.NB	295.68
5 x 2-1/2	10	10	543	5X2D.BB		5X2D.NB	269.89
5 x 2	10	10	445	5X2.BB		5X2.NB	295.68
6 x 5	6	6	617	6X5.BB		6X5.NB	334.51
6 x 4	6	6	788	6X4.BB		6X4.NB	315.57
6 x 3	6	6	752	6X3.BB		6X3.NB	334.51
6 x 2-1/2	6	6	620	6X2D.BB		6X2D.NB	336.6
6 x 2	6	6	650	6X2.BB		6X2.NB	334.51
8 x 6	2	2	1112	8X6.BB		8X6.NB	583.13
8 x 4	2	2	1828	8X4.BB		8X4.NB	628.01



TANK BUSHINGS, DOUBLE TAPPED HVY TYPE ONLY

DESCRIPTION	PCS PER BOX	PCS PER MASTER	WEIGHT PER 100	PART # BLACK	PRICE (US\$) BLACK	PART # GALV.	PRICE (US\$) GALV.
1 x 1/2 x 1/2	50	50	37	1XD.BTB	18.71	1XD.NTB	31.24
1-1/2 x 1 x 1	40	40	66	1DX1.BTB	27.23	1DX1.NTB	45.43
2 x 1-1/2 x 1-1/2	20	20	89	2X1D.BTB	36.74	2X1D.NTB	61.22
2 x 1-1/4 x 1-1/4	20	20	120	2X1B.BTB	36.74	2X1B.NTB	61.22
2 x 1 x 1	20	20	136	2X1.BTB	36.74	2X1.NTB	61.22
2 x 3/4 x 3/4	20	20	155	2XE.BTB	36.74	2XE.NTB	61.22
2 x 1/2 x 1/2	20	20	165	2XD.BTB	36.74	2XD.NTB	61.22
2 x 3/8 x 3/8	20	20	174	2XC.BTB	36.74	2XC.NTB	50.28
3 x 2 x 2	10	10	350	3X2.BTB	74.45	3X2.NTB	121.40
3 x 1 x 1	10	10	525	3X1.BTB	74.45	3X1.NTB	121.40
4 x 3 x 3	5	5	425	4X3.BTB	146.09	4X3.NTB	243.61
4 x 2-1/2 x 2-1/2	5	5	601	4X2D.BTB	134.68	4X2D.NTB	224.73
4 x 2 x 2	5	5	349	4X2.BTB	134.68	4X2.NTB	224.73
4 x 1-1/2 x 1-1/2	5	5	334	4X1D.BTB	134.68	4X1D.NTB	224.73
4 x 1 x 1	5	5	650	4X1.BTB	134.68	4X1.NTB	224.73

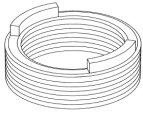

Fig. 10

FLUSH BUSHINGS

DESCRIPTION	PCS PER BOX	PCS PER MASTER	WEIGHT PER 100	PART # BLACK	PRICE (US\$) BLACK	PART # GALV.	PRICE (US\$) GALV.		
1 x 3/4	25	150	12	1XE.BFB	*	23.00	1XE.NFB	*	38.77
1 x 1/2	25	150	14	1XD.BFB	*	18.52	1XD.NFB	*	38.77
1-1/4 x 1	25	150	20	1BX1.BFB	*	24.88	1BX1.NFB	*	47.99
1-1/4 x 3/4	25	150	27	1XE.BFB		18.75	1XE.NFB		50.68
1-1/4 x 1/2	25	150	30	1BXD.BFB		19.31	1BXD.NFB		50.68
1-1/2 x 1-1/4	30	120	20	1DX1B.BFB	*	31.04	1DX1B.NFB	*	68.78
1-1/2 x 1	30	120	32	1DX1.BFB	*	29.82	1DX1.NFB	*	67.97
1-1/2 x 3/4	30	120	40	1DXE.BFB		34.43	1DXE.NFB		70.19
1-1/2 x 1/2	30	120	45	1DXD.BFB		34.43	1DXD.NFB		70.00
2 x 1-1/2	20	80	42	2X1D.BFB	*	41.80	2X1D.NFB	*	90.60
2 x 1-1/4	20	80	54	2X1B.BFB		40.17	2X1B.NFB		87.14
2 x 1	20	80	62	2X1.BFB	*	40.17	2X1.NFB	*	87.14
2 x 3/4	20	80	70	2XE.BFB		39.11	2XE.NFB		84.87
2 x 1/2	20	80	66	2XD.BFB		45.36	2XD.NFB		96.19
2-1/2 x 2	20	20	56	2DX2.BFB		59.14	2DX2.NFB		120.86
2-1/2 x 1-1/4	20	20	100	2DX1B.BFB		43.56	2DX1B.NFB		107.77
3 x 2-1/2	10	10	95	3X2D.BFB		87.02	3X2D.NFB		182.24
3 x 2	10	10	134	3X2.BFB		97.42	3X2.NFB		163.17
3 x 1-1/2	10	10	95	3X1D.BFB		95.77	3X1D.NFB		144.76
3 x 1-1/4	10	10	95	3X1B.BFB		91.33			
3-1/2 x 2-1/2	10	10	171	3DX2D.BFB		131.43	3DX2D.NFB		250.89
4 x 3-1/2	10	10	115	4X3D.BFB		188.66	4X3D.NFB		333.93
4 x 3	10	10	200	4X3.BFB		185.37	4X3.NFB		349.95
4 x 2-1/2	10	10	252	4X2D.BFB		169.18	4X2D.NFB		349.95
4 x 2	10	10	280	4X2.BFB		223.83	4X2.NFB		347.42
5 x 4	10	10	300	5X4.BFB		223.83	5X4.NFB		347.42
6 x 5	6	6	375	6X5.BFB		343.79	6X5.NFB		626.98
6 x 4	6	6	550	6X4.BFB		357.56	6X4.NFB		689.87
8 x 6	2	2	925	8X6.BFB		927.32	8X6.NFB		1,914.49



Fig. 21

CAST IRON 90° ELBOWS CLASS 125

DESCRIPTION	PCS PER BOX	PCS PER MASTER	WEIGHT PER 100	PART # BLACK	PRICE (US\$) BLACK	PART # GALV.	PRICE (US\$) GALV.		
1/4	25	150	17	B.BCL	*	14.98	B.NCL		25.09
3/8	25	150	25	C.BCL	*	21.68	C.NCL		25.09
1/2	100	100	41	D.BCL	*	9.49	D.NCL		28.60
3/4	100	100	69	E.BCL	*	9.89	E.NCL		28.07
1	50	50	104	I.BCL	*	11.72	I.NCL		32.44
1-1/4	25	25	158	1B.BCL	*	16.63	1B.NCL		50.49
1-1/2	25	25	209	1D.BCL	*	23.00	1D.NCL		69.35
2	15	15	339	2.BCL	*	35.95	2.NCL		102.4
2-1/2	10	10	514	2D.BCL	*	86.13	2D.NCL		210.15
3	6	6	787	3.BCL		141.04	3.NCL		319.65
3-1/2	3	3	955	3D.BCL		383.08	3D.NCL		510.28
4	2	2	1323	4.BCL		261.48	4.NCL		585.66
5	1	1	2040	5.BCL		572.85			
6	1	1	2985	6.BCL		742.32			
8	1	1	6456	8.BCL		1,815.2			
3/4 x 1/2	100	100	56	EXD.BCL	*	19.97	EXD.NCL		32.47
1/2 x 1/4	1	1	40	DXB.BCL		23.40			
1/2 x 3/8	100	100	34	DXC.BCL		30.18			
1 x 1/2	50	50	71	1XD.BCL	*	14.80	1XD.NCL		35.61
1 x 3/4	50	50	92	1XE.BCL	*	16.67	1XE.NCL		37.62
1-1/4 x 1	25	25	127	1BX1.BCL	*	20.99	1BX1.NCL		55.19
1-1/4 x 3/4	25	25	115	1BXE.BCL	*	23.93	1BXE.NCL		48.04
1-1/4 x 1/2	25	25	100	1BXD.BCL	*	23.54	1BXD.NCL		58.39
1-1/2 x 1-1/4	25	25	190	1DX1B.BCL	*	42.39	1DX1B.NCL		82.49
1-1/2 x 1	25	25	157	1DX1.BCL	*	38.75	1DX1.NCL		80.85
1-1/2 x 3/4	25	25	146	1DXE.BCL	*	38.75	1DXE.NCL		70.37
1-1/2 x 1/2	25	25	147	1DXD.BCL	*	41.57	1DXD.NCL		85.68
2 x 1-1/2	15	15	274	2X1D.BCL	*	56.72	2X1D.NCL		99.62
2 x 1-1/4	15	15	249	2X1B.BCL	*	60.65	2X1B.NCL		121.33
2 x 1	15	15	227	2X1.BCL	*	56.72	2X1.NCL		121.33

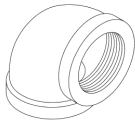

Fig. 21

**CAST IRON
90° ELBOWS
CLASS 125
(continued)**

DESCRIPTION	PCS PER BOX	PCS PER MASTER	WEIGHT PER 100	PART # BLACK	PRICE (US\$) BLACK	PART # GALV.	PRICE (US\$) GALV.	
2 x 3/4	15	15	206	2XE.BCL	*	56.72	2XE.NCL	121.33
2 x 1/2	15	15	204	2XD.BCL	*	64.62	2XD.NCL	121.33
2-1/2 x 2	10	10	400	2DX2.BCL		114.55	2DX2.NCL	219.42
2-1/2 x 1-1/2	10	10	326	2DX1D.BCL		129.17	2DX1D.NCL	219.42
4 x 3	4	4	1067	4X3.BCL		368.98	4X3.NCL	611.94
4 x 2-1/2	4	4	890	4X2D.BCL		368.98	4X2D.NCL	648.65
4 x 2	4	4	775	4X2.BCL		368.98	4X2.NCL	611.94
4 x 1-1/2	4	4	850	4X1D.BCL		361.27	4X1D.NCL	648.65
2-1/2 x 1-1/4	10	10	326	2DX1B.BCL		132.28	2DX1B.NCL	232.59
2-1/2 x 1	10	10	258	2DX1.BCL		132.28	2DX1.NCL	232.59
2-1/2 x 3/4	10	10	280	2DXE.BCL		129.47	2DXE.NCL	232.59
3 x 2-1/2	6	6	574	3X2D.BCL		216.25	3X2D.NCL	375.83
3 x 2	6	6	575	3X2.BCL		199.22	3X2.NCL	354.55
3 x 1-1/2	6	6	603	3X1D.BCL		216.25	3X1D.NCL	375.83
3 x 1-1/4	6	6	465	3X1B.BCL		216.25	3X1B.NCL	308.6
3 x 1	6	6	475	3X1.BCL		211.79	3X1.NCL	532.61
5 x 4	1	1	1690	5X4.BCL		849.15		
6 x 3	1	1	2038	6X3.BCL		1,124.45		
6 x 4	1	1	2465	6X4.BCL		1,124.45		



Fig. 23

**CAST IRON
45° ELBOWS
CLASS 125**

DESCRIPTION	PCS PER BOX	PCS PER MASTER	WEIGHT PER 100	PART # BLACK	PRICE (US\$) BLACK	PART # GALV.	PRICE (US\$) GALV.	
1/4	1	1	16	B.BC45L			18.46	
3/8	1	1	25	C.BC45L			19.84	
1/2	100	100	36	D.BC45L	*	14.53	D.NC45L	28.58
3/4	100	100	60	E.BC45L	*	14.62	E.NC45L	32.78
1	50	50	87	1.BC45L	*	17.15	1.NC45L	40.31
1-1/4	25	25	140	1B.BC45L	*	23.05	1B.NC45L	60.17
1-1/2	25	25	180	1D.BC45L	*	38.20	1D.NC45L	85.06
2	15	15	298	2.BC45L	*	44.06	2.NC45L	119.28
2-1/2	10	10	462	2D.BC45L		114.58	2D.NC45L	192.29
3	6	6	655	3.BC45L		181.47	3.NC45L	375.09
4	2	2	992	4.BC45L		377.31	4.NC45L	687.76
6	1	1	2530	6.BC45L		1,091.91		585.66

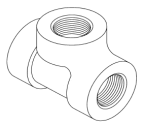

Fig. 24

**CAST IRON
STRAIGHT TEES
CLASS 125**

DESCRIPTION	PCS PER BOX	PCS PER MASTER	WEIGHT PER 100	PART # BLACK	PRICE (US\$) BLACK	PART # GALV.	PRICE (US\$) GALV.	
1/4	1	1	22	B.BCT			23.43	
3/8	25	150	38	C.BCT	*	22.78	C.NCT	30.24
1/2	100	100	55	D.BCT	*	14.80	D.NCT	29.19
3/4	50	50	92	E.BCT	*	17.26	E.NCT	40.38
1	25	25	142	1.BCT	*	15.36	1.NCT	43.84
1-1/4	25	25	223	1B.BCT	*	28.04	1B.NCT	76.71
1-1/2	25	25	287	1D.BCT	*	36.43	1D.NCT	101.46
2	15	15	469	2.BCT	*	50.73	2.NCT	126.59
2-1/2	9	9	675	2D.BCT		131.80	2D.NCT	257.33
3	5	5	994	3.BCT		202.26	3.NCT	579.23
3-1/2	3	3	1246	3D.BCT		407.94	3D.NCT	724.23
4	2	2	1737	4.BCT		394.53	4.NCT	811.54
5	1	1	2718	5.BCT		1,079.02		
6	1	1	3960	6.BCT		1,225.03		

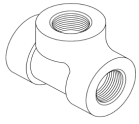

Fig. 25

**CAST IRON
REDUCING TEES
CLASS 125**

DESCRIPTION	PCS PER BOX	PCS PER MASTER	WEIGHT PER 100	PART # BLACK	PRICE (US\$) BLACK	PART # GALV.	PRICE (US\$) GALV.
1/2 x 1/2 x 1/4	1	1	60	DXB.BCT	36.52		
1/2 x 1/2 x 3/8	25	25	55	DXC.BCT	30.77	DXC.NCT	43.45
1/2 x 1/2 x 3/4	50	50	99	DXE.BCT	* 27.85	DXE.NCT	46.21
1/2 x 1/2 x 1	45	45	88	DXI.BCT	* 32.97		
3/4 x 3/4 x 1/4	1	1	62	EXB.BCT	31.69		
3/4 x 3/4 x 1/2	50	50	81	EXD.BCT	* 23.99	EXD.NCT	43.61
3/4 x 3/4 x 3/8	50	50	81	EXC.BCT	28.57	EXC.NCT	46.21
3/4x1/2x3/4	50	50	96	EXDXE.BCT	* 27.85	EXDXE.NCT	43.61
3/4x1/2x1/2	50	50	66	EXDXD.BCT	* 27.85	EXDXD.NCT	43.61
3/4 x 3/4 x 1	45	45	135	EXI.BCT	* 28.17	EXI.NCT	56.96
1 x 1 x 3/4	50	50	126	1XE.BCT	* 20.78	1XE.NCT	51.27
1 x 1 x 1/2	50	50	108	1XD.BCT	* 17.31	1XD.NCT	52.98
1 x 1 x 3/8	50	50	116	1XC.BCT	28.07	1XC.NCT	52.98
1 x 3/4 x 1	50	50	126	1XEXI.BCT	* 23.18	1XEXI.NCT	42.11
1 x 3/4 x 3/4	50	50	100	1XEXE.BCT	* 28.93	1XEXE.NCT	49.35
1 x 3/4 x 1/2	50	50	97	1XEXD.BCT	31.52	1XEXD.NCT	52.31
1 x 1/2 x 1	50	50	109	1XD1.BCT	* 22.82	1XD1.NCT	48.56
1 x 1/2 x 3/4	50	50	100	1DXDE.BCT	31.52	1DXDE.NCT	52.31
1 x 1/2 x 1/2	50	50	84	1DXDD.BCT	34.58	1DXDD.NCT	46.77
1 x 1 x 1/4	1	1	85	1XB.BCT	35.69		
1 x 1/4 x 1	50	50	106	1XB1.BCT	36.02	1XB1.NCT	56.96
1 x 1 x 2	1	1	225	1X2.BCT	105.02		
1 x 1 x 1-1/4	25	25	164	1X1B.BCT	* 33.21	1X1B.NCT	84.37
1 x 1 x 1-1/2	25	25	184	1X1D.BCT	55.54	1X1D.NCT	73.17
1 x 1/2 x 1-1/4	25	25	187	1XD1B.BCT	64.72	1XD1B.NCT	86.04
1 x 3/4 x 1-1/4	25	25	202	1XEX1B.BCT	64.72	1XEX1B.NCT	86.04
1-1/4 x 1/2 x 1-1/4	25	25	181	1BXDX1B.BCT	* 42.81	1BXDX1B.NCT	81.17
1-1/4 x 1/2 x 1-1/2	25	25	230	1BXDX1D.BCT	60.13	1BXDX1D.NCT	116.86
1-1/4 x 1/2 x 1	25	25	185	1BXDX1BCT	* 50.25	1BXDX1B.NCT	81.17
1-1/4 x 1/2 x 3/4	25	25	144	1BXDXE.BCT	50.34	1BXDXE.NCT	86.04
1-1/4 x 1/2 x 1/2	25	25	110	1BXDXD.BCT	66.06	1BXDXD.NCT	86.04
1-1/4 x 3/4 x 1-1/2	25	25	230	1BXEX1D.BCT	54.38	1BXEX1D.NCT	124.52
1-1/4 x 3/4 x 1-1/4	25	25	177	1BXEX1B.BCT	* 40.83	1BXEX1B.NCT	75.23
1-1/4 x 3/4 x 1	25	25	172	1BXEX1BCT	* 50.04	1BXEX1B.NCT	86.04
1-1/4 x 3/4 x 3/4	25	25	136	1BXEXE.BCT	* 50.04	1BXEXE.NCT	86.04
1-1/4 x 3/4 x 1/2	25	25	150	1BXEXD.BCT	50.04	1BXEXD.NCT	86.04
1-1/4 x 1-1/4 x 1-1/2	25	25	278	1BX1D.BCT	* 51.37	1BX1D.NCT	119.87
1-1/4 x 1-1/4 x 1	25	25	185	1BX1BCT	* 27.69	1BX1B.NCT	79.73
1-1/4 x 1-1/4 x 3/4	25	25	165	1BXE.BCT	* 30.05	1BXE.NCT	65.47
1-1/4 x 1-1/4 x 1/2	25	25	164	1BXD.BCT	* 27.66	1BXD.NCT	79.73
1-1/4 x 1 x 1	25	25	164	1BX1X1BCT	* 27.69	1BX1X1B.NCT	79.73
1-1/4 x 1 x 1-1/4	25	25	195	1BX1X1B.BCT	* 30.59	1BX1X1B.NCT	84.37
1-1/4 x 1 x 1-1/2	25	25	270	1BX1X1D.BCT	* 51.37	1BX1X1D.NCT	119.87
1-1/4 x 1 x 2	1	1	267	1BX1X2.BCT	97.71		
1-1/4 x 1 x 3/4	25	25	160	1BX1XE.BCT	* 31.72	1BX1XE.NCT	84.37
1-1/4 x 1 x 1/2	25	25	136	1BX1XD.BCT	* 28.05	1BX1XD.NCT	79.73
1-1/4 x 1-1/4 x 2	1	1	290	1BX2.BCT	82.04		
1-1/2 x 3/4 x 1/2	25	25	171	1DXEXD.BCT	56.25	1DXEXD.NCT	120.48
1-1/2 x 3/4 x 3/4	25	25	166	1DXEXE.BCT	56.25	1DXEXE.NCT	120.48
1-1/2 x 3/4 x 1	25	25	192	1DXEX1BCT	56.25	1DXEX1B.NCT	98.93
1-1/2 x 3/4 x 1-1/4	25	25	230	1DXEX1B.BCT	* 55.96	1DXEX1B.NCT	120.48
1-1/2 x 3/4 x 1-1/2	25	25	228	1DXEX1D.BCT	* 55.94	1DXEX1D.NCT	95.96
1-1/2 x 1/2 x 1-1/4	25	25	235	1DXDX1B.BCT	* 65.07	1DXDX1B.NCT	116.86
1-1/2 x 1/2 x 1-1/2	25	25	217	1DXDX1D.BCT	* 57.27	1DXDX1D.NCT	116.86
1-1/2 x 1/2 x 1/2	25	25	158	1DXDXD.BCT	65.46	1DXDXD.NCT	116.63
1-1/2 x 1/2 x 3/4	25	25	167	1DXDXE.BCT	65.46	1DXDXE.NCT	116.63
1-1/2 x 1 x 1/2	25	25	191	1DX1XD.BCT	* 59.42	1DX1XD.NCT	116.86
1-1/2 x 1 x 3/4	25	25	192	1DX1XE.BCT	* 57.49	1DX1XE.NCT	116.86
1-1/2 x 1 x 1	25	25	189	1DX1X1BCT	* 51.37	1DX1X1B.NCT	98.43
1-1/2 x 1 x 1-1/4	25	25	271	1DX1X1B.BCT	* 59.42	1DX1X1B.NCT	116.86
1-1/2 x 1 x 1-1/2	25	25	253	1DX1X1D.BCT	* 42.82	1DX1X1D.NCT	114.68
1-1/2x1x2	15	15	411	1DX1X2.BCT	* 80.24	1DX1X2.NCT	159.63
1-1/2x1-1/4x1/2	25	25	178	1DX1BXD.BCT	* 39.01	1DX1BXD.NCT	108.44
1-1/2x1-1/4x3/4	25	25	204	1DX1BXE.BCT	* 41.26	1DX1BXE.NCT	114.68
1-1/2x1-1/4x1	25	25	218	1DX1BX1BCT	* 36.12	1DX1BX1B.NCT	108.44
1-1/2x1-1/4x1-1/4	25	25	236	1DX1BX1B.BCT	* 51.37	1DX1BX1B.NCT	119.87

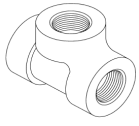

Fig. 25

**CAST IRON
REDUCING TEES
CLASS 125
(continued)**

DESCRIPTION	PCS PER BOX	PCS PER MASTER	WEIGHT PER 100	PART # BLACK		PRICE (US\$) BLACK	PART # GALV.	PRICE (US\$) GALV.
1-1/2x1-1/4x1-1/2	25	25	271	1DX1BX1D.BCT	*	51.37	1DX1BX1D.NCT	119.87
1-1/2x1-1/4x2	15	15	430	1DX1BX2.BCT	*	78.62	1DX1BX2.NCT	156.63
1-1/2x1-1/2x1/2	25	25	200	1DXD.BCT	*	36.12	1DXD.NCT	108.44
1-1/2x1-1/2x3/4	25	25	217	1DXE.BCT	*	39.01	1DXE.NCT	108.44
1-1/2x1-1/2x1	25	25	228	1DXI.BCT	*	36.12	1DXI.NCT	108.44
1-1/2x1-1/2x1-1/4	25	25	262	1DX1B.BCT	*	51.37	1DX1B.NCT	119.87
1-1/2x1-1/2x2	15	15	355	1DX2.BCT	*	56.18	1DX2.NCT	156.63
1-1/2x1-1/2x2-1/2	10	10	425	1DX2D.BCT	*	173.29	1DX2D.NCT	303.65
2x2x1-1/2	15	15	396	2X1D.BCT	*	60.76	2X1D.NCT	156.63
2x2x1-1/4	15	15	364	2X1B.BCT	*	57.48	2X1B.NCT	148.08
2x2x1	15	15	326	2X1.BCT	*	51.19	2X1.NCT	148.08
2x2x3/4	15	15	310	2XE.BCT	*	51.19	2XE.NCT	148.08
2x2x1/2	15	15	290	2XD.BCT	*	51.19	2XD.NCT	148.08
2x1-1/2x2	15	15	400	2X1DX2.BCT	*	69.8	2X1DX2.NCT	126.42
2x1-1/2x1-1/2	15	15	346	2X1DX1D.BCT	*	78.62	2X1DX1D.NCT	153.96
2x1-1/2x1-1/4	15	15	363	2X1DX1B.BCT	*	80.17	2X1DX1B.NCT	131.68
2x1-1/2x1	15	15	289	2X1DX1.BCT	*	51.19	2X1DX1.NCT	148.08
2x1-1/2x3/4	15	15	273	2X1DXE.BCT	*	58.59	2X1DXE.NCT	148.08
2x1-1/2x1/2	15	15	239	2X1DXD.BCT	*	58.59	2X1DXD.NCT	148.08
2x1-1/4x2	15	15	396	2X1BX2.BCT	*	69.8	2X1BX2.NCT	133.05
2x1-1/4x1-1/2	15	15	363	2X1BX1D.BCT	*	92.36	2X1BX1D.NCT	159.63
2x1-1/4x1-1/4	15	15	300	2X1BX1B.BCT	*	80.24	2X1BX1B.NCT	131.07
2x1-1/4x1	15	15	310	2X1BX1.BCT	*	90.17	2X1BX1.NCT	159.63
2x1-1/4x1/2	15	15	244	2X1BXD.BCT	*	92.36	2X1BXD.NCT	150.59
2x1-1/4x3/4	1	1	250	2X1BXE.BCT		105.02		
2x1x2	15	15	370	2X1X2.BCT	*	80.88	2X1X2.NCT	148.08
2x1x1-1/2	15	15	413	2X1X1D.BCT	*	75.02	2X1X1D.NCT	159.63
2x1x1-1/4	15	15	300	2X1X1B.BCT	*	92.36	2X1X1B.NCT	159.63
2x1x1	15	15	240	2X1X1.BCT	*	90.17	2X1X1.NCT	150.59
2x1x3/4	15	15	250	2X1XE.BCT	*	90.18	2X1XE.NCT	159.63
2x3/4x2	15	15	380	2XEX2.BCT	*	73.32	2XEX2.NCT	156.14
2x3/4x1-1/2	15	15	410	2XEX1D.BCT	*	92.36	2XEX1D.NCT	150.59
2x3/4x1-1/4	15	15	424	2XEX1B.BCT	*	92.36	2XEX1B.NCT	159.63
2x3/4x1	15	15	250	2XEX1.BCT	*	92.36	2XEX1.NCT	159.63
2x1/2x2	15	15	330	2DXD2.BCT	*	80.24	2DXD2.NCT	150.59
2x1/2x1-1/2	15	15	314	2DXD1D.BCT	*	92.36	2DXD1D.NCT	159.63
2x1/2x1-1/4	15	15	341	2DXD1B.BCT	*	92.36	2DXD1B.NCT	150.59
2x1/2x1/2	15	15	220	2DXD.BCT	*	92.36		
2-1/2x2-1/2x3	6	6	958	2DX3.BCT		260.43	2DX3.NCT	480.74
2-1/2x2x3	6	6	888	2DX2X3.BCT		260.43	2DX2X3.NCT	375.84
2-1/2x2-1/2x2	10	10	610	2DX2.BCT		149.45	2DX2.NCT	286.45
2-1/2x2-1/2x1-1/2	10	10	500	2DX1D.BCT		153.00	2DX1D.NCT	303.65
2-1/2x2-1/2x1-1/4	10	10	450	2DX1B.BCT		149.45	2DX1B.NCT	286.45
2-1/2x2-1/2x1	10	10	469	2DX1.BCT		146.55	2DX1.NCT	281.05
2-1/2x2-1/2x3/4	10	10	475	2DXE.BCT		149.45	2DXE.NCT	286.45
2-1/2x2-1/2x1/2	10	10	490	2DXD.BCT		166.12	2DXD.NCT	303.65
2-1/2x2x2-1/2	10	10	575	2DX2X2D.BCT		150.12	2DX2X2D.NCT	297.91
2-1/2x2x2	10	10	537	2DX2X2.BCT		153.00	2DX2X2.NCT	286.45
2-1/2x2x1-1/2	10	10	574	2DX2X1D.BCT		166.12	2DX2X1D.NCT	249.32
2-1/2x2x1-1/4	10	10	412	2DX2X1B.BCT		173.29	2DX2X1B.NCT	286.45
2-1/2x2x1	10	10	440	2DX2X1.BCT		149.45	2DX2X1.NCT	303.65
2-1/2x2x3/4	10	10	433	2DX2XE.BCT		146.55	2DX2XE.NCT	244.6
2-1/2x2x1/2	10	10	350	2DX2XD.BCT		173.29	2DX2XD.NCT	303.65
2-1/2x1-1/2x2-1/2	10	10	535	2DX1DX2D.BCT		173.29	2DX1DX2D.NCT	303.65
2-1/2x1-1/2x2	10	10	558	2DX1DX2.BCT		173.29	2DX1DX2.NCT	303.65
2-1/2x1-1/2x1-1/2	10	10	601	2DX1DX1D.BCT		173.29	2DX1DX1D.NCT	249.32
2-1/2x1-1/2x1-1/4	10	10	446	2DX1DX1B.BCT		173.27	2DX1DX1B.NCT	317.23
2-1/2x1-1/2x1/2	10	10	376	2DX1DXD.BCT		163.47	2DX1DXD.NCT	317.23
2-1/2x1-1/4x2-1/2	10	10	520	2DX1BX2D.BCT		173.29	2DX1BX2D.NCT	244.6
2-1/2x1-1/4x2	10	10	557	2DX1BX2.BCT		173.29	2DX1BX2.NCT	244.6
2-1/2x1-1/4x1-1/4	10	10	380	2DX1BX1B.BCT		173.27	2DX1BX1B.NCT	317.23
2-1/2x1-1/4x1	10	10	394	2DX1BX1.BCT		173.27	2DX1BX1.NCT	317.23
2-1/2x1x2-1/2	10	10	525	2DX1X2D.BCT		153.00	2DX1X2D.NCT	297.91
2-1/2x1x2	10	10	470	2DX1X2.BCT		173.29	2DX1X2.NCT	297.91
2-1/2x1x1-1/4	10	10	388	2DX1X1B.BCT		173.27	2DX1X1B.NCT	297.91
2-1/2x1x1	10	10	315	2DX1X1.BCT		173.27		
2-1/2x1x3/4	10	10	280	2DX1XE.BCT		173.27		

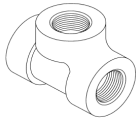
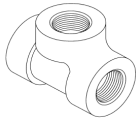

Fig. 25

**CAST IRON
REDUCING TEES
CLASS 125
(continued)**

DESCRIPTION	PCS PER BOX	PCS PER MASTER	WEIGHT PER 100	PART # BLACK	PRICE (US\$) BLACK	PART # GALV.	PRICE (US\$) GALV.
2-1/2x3/4x2-1/2	10	10	532	2DXE2D.BCT	152.88	2DXE2D.NCT	292.66
2-1/2x3/4x2	10	10	440	2DXE2.BCT	152.88	2DXE2.NCT	297.91
2-1/2x1/2x2-1/2	10	10	549	2DXD2D.BCT	156.46	2DXD2D.NCT	292.66
2x2x3	6	6	922	2X3.BCT	234.99	2X3.NCT	457.74
2x2x2-1/2	10	10	550	2X2D.BCT	130.32	2X2D.NCT	242.46
2x1-1/2x2-1/2	10	10	628	2X1DX2D.BCT	149.58	2X1DX2D.NCT	303.65
2x1-1/4x2-1/2	10	10	556	2X1BX2D.BCT	173.29	2X1BX2D.NCT	303.65
2x1x2-1/2	10	10	560	2X1X2D.BCT	173.29	2X1X2D.NCT	303.65
2x3/4x2-1/2	10	10	360	2XE2D.BCT	173.27	2XE2D.NCT	303.65
3x3x2-1/2	6	6	775	3X2D.BCT	260.43	3X2D.NCT	431.82
3x3x2	6	6	800	3X2.BCT	224.00	3X2.NCT	431.82
3x3x1-1/2	6	6	840	3X1D.BCT	260.43	3X1D.NCT	375.84
3x3x1-1/4	6	6	584	3X1B.BCT	239.98	3X1B.NCT	375.84
3x3x1	6	6	660	3X1.BCT	219.36	3X1.NCT	375.84
3x2-1/2x3	6	6	850	3X2DX3.BCT	260.43	3X2DX3.NCT	457.74
3x2-1/2x2-1/2	6	6	780	3X2DX2D.BCT	260.43	3X2DX2D.NCT	431.82
3x2-1/2x2	6	6	837	3X2DX2.BCT	260.43	3X2DX2.NCT	431.82
3x2-1/2x1-1/4	6	6	658	3X2DX1B.BCT	248.2	3X2DX1B.NCT	453.55
3x2x3	6	6	780	3X2X3.BCT	260.43	3X2X3.NCT	457.74
3x2x2-1/2	6	6	850	3X2X2D.BCT	248.2	3X2X2D.NCT	453.55
3x2x2	6	6	615	3X2X2.BCT	260.43	3X2X2.NCT	431.82
3x2x1-1/2	6	6	650	3X2X1D.BCT	260.43	3X2X1D.NCT	457.74
3x3x1/2	1	1	608	3XD.BCT	352.74		
3x3x3/4	1	1	595	3XE.BCT	352.74		
3x1-1/2x3	6	6	830	3X1DX3.BCT	260.43	3X1DX3.NCT	457.74
3x1-1/2x2	6	6	650	3X1DX2.BCT	260.46	3X1DX2.NCT	480.74
3x2-1/2x1-1/2	1	1	623	3X2DX1D.BCT	352.74		
3x1-1/2x1-1/2	6	6	675	3X1DX1D.BCT	260.46	3X1DX1D.NCT	394.74
3x1-1/4x3	6	6	838	3X1BX3.BCT	260.43	3X1BX3.NCT	457.74
3x1-1/4x2	6	6	600	3X1BX2.BCT	249.55		
3x1x3	6	6	822	3X1X3.BCT	260.43	3X1X3.NCT	457.74
3x1x2	6	6	580	3X1X2.BCT	260.43		
3x3x4	1	1	1280	3X4.BCT	639.52		
4x4x3	4	4	1410	4X3.BCT	507.92	4X3.NCT	915.37
4x4x2-1/2	4	4	1238	4X2D.BCT	479.18	4X2D.NCT	863.55
4x4x2	4	4	1117	4X2.BCT	458.64	4X2.NCT	915.37
4x4x1-1/2	4	4	1108	4X1D.BCT	519.98	4X1D.NCT	863.55
4x3-1/2x4	2	2	1805	4X3DX4.BCT	523.21	4X3DX4.NCT	1,089.6
4x3x4	4	4	1500	4X3X4.BCT	519.98	4X3X4.NCT	863.55
4x2-1/2x4	4	4	1400	4X2DX4.BCT	519.98	4X2DX4.NCT	863.55
4x2x4	4	4	1360	4X2X4.BCT	519.98	4X2X4.NCT	915.37
4x4x3/4	1	1	1058	4XE.BCT	704.20		
4x4x1	1	1	980	4X1.BCT	648.85		
4x4x1-1/4	1	1	978	4X1B.BCT	585.96		
4x1-1/2x4	4	4	1325	4X1DX4.BCT	495.49	4X1DX4.NCT	915.37
4x1x4	4	4	1392	4X1X4.BCT	451.69	4X1X4.NCT	915.37
4x3x3	4	4	1160	4X3X3.BCT	684.83	4X3X3.NCT	915.37
4x3x2-1/2	4	4	1270	4X3X2D.BCT	495.49	4X3X2D.NCT	915.37
4x3x2	4	4	1200	4X3X2.BCT	532.67	4X3X2.NCT	915.37
4x3x1-1/2	4	4	1058	4X3X1D.BCT	532.67	4X3X1D.NCT	915.37
4x2-1/2x2-1/2	4	4	1083	4X2DX2D.BCT	637.09	4X2DX2D.NCT	863.55
4x2x2	4	4	875	4X2X2.BCT	532.67	4X2X2.NCT	915.37
5x5x2	1	1	1743	5X2.BCT	1,208.19		
5x5x2-1/2	1	1	2093	5X2D.BCT	1,172.75		
5x5x3	1	1	2000	5X3.BCT	1,208.19		
5x5x4	1	1	2383	5X4.BCT	1,172.75		
6x6x3	1	1	2670	6X3.BCT	1,507.69		
6x6x4	1	1	3043	6X4.BCT	1,553.17		
6x6x5	1	1	3523	6X5.BCT	1,507.69		



**CAST IRON
REDUCING TEES
CLASS 250**

DESCRIPTION	PCS PER BOX	PCS PER MASTER	WEIGHT PER 100	PART # BLACK	PRICE (US\$) BLACK	PART # GALV.	PRICE (US\$) GALV.
1-1/4x1-1/4x3/4	1	1	321	1BXE.BC250T	185.44		
1-1/2x1-1/2x3/4	1	1	402	1DXE.BC250T	275.42		
2x2x3/4	1	1	615	2XE.BC250T	303.79		
2x2x1-1/2	1	1	760	2X1D.BC250T	374.51		



**CAST IRON
CROSSES
CLASS 125**

Fig. 30A

DESCRIPTION	PCS PER BOX	PCS PER MASTER	WEIGHT PER 100	PART # BLACK	PRICE (US\$) BLACK	PART # GALV.	PRICE (US\$) GALV.
1/2	50	50	87	D.BCCR	40.77	D.NCCR	70.95
3/4	30	30	130	E.BCCR	40.77	E.NCCR	58.25
1	25	25	178	1.BCCR	* 47.48	1.NCCR	98.84
1-1/4	15	15	295	1B.BCCR	* 66.98	1B.NCCR	109.08
1-1/4x1	15	15	215	1BX1.BCCR	76.98	1BX1.NCCR	138.99
1-1/2	10	10	350	1D.BCCR	* 92.95	1D.NCCR	167.59
1-1/2x1-1/4	1	1	280	1DX1B.BCCR	110.17		
1-1/2x1-1/4x1	1	1	303	1DX1BX1.BCCR	151.6		
1-1/2x1-1/4x1x1	1	1	268	1DX1BX1X1.BCCR	110.17		
1-1/2x1	10	10	262	1DX1.BCCR	91.55	1DX1.NCCR	169.22
1-1/2x1x1x1	1	1	280	1DX1X1X1.BCCR	127.93		
2	8	8	650	2.BCCR	* 123.08	2.NCCR	263.35
2x1	8	8	352	2X1.BCCR	125.34	2X1.NCCR	263.73
2x1-1/4	1	1	373	2X1B.BCCR	141.17		
2x1-1/2	1	1	410	2X1D.BCCR	126.45		
2x1-1/2x1x1	1	1	367	2X1DX1X1.BCCR	190.06		
4	1	1	1950	4.BCCR	907.60		

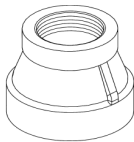

**CAST IRON
REDUCING
COUPLINGS
CLASS 125**

Fig. 29

DESCRIPTION	PCS PER BOX	PCS PER MASTER	WEIGHT PER 100	PART # BLACK	PRICE (US\$) BLACK	PART # GALV.	PRICE (US\$) GALV.
3/4x1/2	50	50	44	EXD.BR	26.54	EXD.NR	35.82
1x3/4	50	50	64	1XE.BR	* 17.99	1XE.NR	51.05
1x1/2	50	50	58	1XD.BR	* 13.58	1XD.NR	42.57
1-1/4x1	50	50	105	1BX1.BR	* 46.62	1BX1.NR	87.33
1-1/4x1/2	50	50	96	1BXD.BR	* 53.61		
1-1/4x3/4	50	50	99	1BXE.BR	* 39.85	1BXE.NR	85.88
1-1/2x1/2	1	1	397	1DXD.BR	84.22		
1-1/2x3/4	40	40	120	1DXE.BR	75.79	1DXE.NR	254.71
1-1/2x1	40	40	150	1DX1.BR	* 65.99	1DX1.NR	129.09
1-1/2x1-1/4	40	40	135	1DX1B.BR	* 65.99	1DX1B.NR	129.09
2x1-1/2	30	30	209	2X1D.BR	* 86.31	2X1D.NR	147.04
2x1-1/4	30	30	204	2X1B.BR	* 90.17	2X1B.NR	179.08
2x1	30	30	172	2X1.BR	* 76.84	2X1.NR	175.74
2x3/4	30	30	172	2XE.BR	* 86.31	2XE.NR	168.96
2x1/2	30	30	175	2XD.BR	* 95.81	2XD.NR	168.96
2-1/2x2	18	18	300	2DX2.BR	122.65	2DX2.NR	195.75
2-1/2x1-1/2	18	18	325	2DX1D.BR	136.39	2DX1D.NR	224.92
3x2	12	12	435	3X2.BR	150.33	3X2.NR	243.26
3x1-1/2	12	12	458	3X1D.BR	208.19	3X1D.NR	254.04
3x2-1/2	1	1	440	3X2D.BR	194.53		
4x2	1	1	605	4X2.BR	398.71		
4x2-1/2	1	1	780	4X2D.BR	398.71		
4x3	1	1	700	4X3.BR	398.71		
6x4	1	1	1335	6X4.BR	722.68		

**CAST IRON
ECCENTRIC
REDUCERS
CLASS 125**

Fig. 29E

DESCRIPTION	PCS PER BOX	PCS PER MASTER	WEIGHT PER 100	PART # BLACK	PRICE (US\$) BLACK	PART # GALV.	PRICE (US\$) GALV.
3/4x1/2	50	50	45	EXD.BER	55.84	EXD.NER	100.53
1x3/4	50	50	69	1XE.BER	60.31	1XE.NER	108.55
1x1/2	50	50	64	1XD.BER	58.62	1XD.NER	116.07
1-1/4x1	50	50	89	1BX1.BER	89.82	1BX1.NER	161.68
1-1/4x3/4	50	50	96	1BXE.BER	87.29	1BXE.NER	157.13
1-1/4x1/2	50	50	91	1BXD.BER	96.34	1BXD.NER	173.43
1-1/2x1-1/4	40	40	141	1DX1B.BER	121.78	1DX1B.NER	219.18
1-1/2x1	40	40	127	1DX1.BER	127.36	1DX1.NER	229.25
1-1/2x3/4	40	40	110	1DXE.BER	127.36	1DXE.NER	229.25
1-1/2x1/2	40	40	117	1DXD.BER	121.29	1DXD.NER	242.60
2x1/2	1	1	183	2XD.BER	162.79		
2x3/4	25	25	185	2XE.BER	183.51	2XE.NER	367.00
2x1	30	30	195	2X1.BER	166.24	2X1.NER	291.68
2x1-1/4	30	30	205	2X1B.BER	158.31	2X1B.NER	284.96
2x1-1/2	30	30	198	2X1D.BER	161.48	2X1D.NER	290.68
2-1/2x1	1	1	258	2DX1.BER	252.47		
2-1/2x1-1/4	1	1	265	2DX1B.BER	252.47		
2-1/2x1-1/2	1	1	265	2DX1D.BER	252.47		
2-1/2x2	1	1	308	2DX2.BER	246.59		
3x1	1	1	367	3X1.BER	398.71		
3x1-1/4	1	1	388	3X1B.BER	398.71		
3x1-1/2	1	1	383	3X1D.BER	339.68		
3x2	1	1	403	3X2.BER	305.73		
3x2-1/2	1	1	468	3X2D.BER	367.41		
4x1-1/4	1	1	658	4X1B.BER	719.33		
4x1-1/2	1	1	661	4X1D.BER	669.15		
4x2	1	1	600	4X2.BER	719.33		

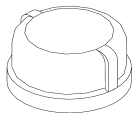

Fig. 30

**CAST IRON
PIPE CAPS
CLASS 125**

DESCRIPTION	PCS PER BOX	PCS PER MASTER	WEIGHT PER 100	PART # BLACK	PRICE (US\$) BLACK	PART # GALV.	PRICE (US\$) GALV.
2-1/2	6	6	225	2D.BCCAP	81.31	2D.NCCAP	140.14
3	6	6	375	3.BCCAP	106.97	3.NCCAP	178.22
4	5	5	600	4.BCCAP	153.86	4.NCCAP	288.07
5	6	6	1014	5.BCCAP	234.26	5.NCCAP	452.14
6	3	3	1910	6.BCCAP	293.53	6.NCCAP	1,162.75
8	1	1	2825	8.BCCAP	832.09	8.NCCAP	1,626.72

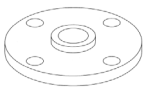

Fig. 20

**COMPANION FLANG-
ES
THREADED
CLASS 125**

DESCRIPTION	PCS PER BOX	PCS PER MASTER	WEIGHT PER 100	PART # BLACK	PRICE (US\$) BLACK	PART # GALV.	PRICE (US\$) GALV.
1x4-1/4	10	10	166	1X4B.BCF	72.85	1X4B.NCF	164.92
1-1/4x4-5/8	10	10	205	1B.BCF	87.17	1B.NCF	189.33
1-1/2x5	10	10	261	1DX5.BCF	80.56	1DX5.NCF	193.69
2x6	6	6	444	2X6.BCF	80.39	2X6.NCF	170.34
2-1/2x7	6	6	607	2DX7.BCF	94.05	2DX7.NCF	199.27
3x7-1/2	5	5	764	3X7D.BCF	121.15	3X7D.NCF	242.16
4x9	5	5	1188	4X9.BCF	163.26	4X9.NCF	329.82
5x10	1	1	1358	5X10.BCF	230.64	5X10.NCF	517.80
6x11	3	3	1745	6X11.BCF	260.95	6X11.NCF	553.45
8x13-1/2	1	1	3000	8X13D.BCF	411.89	8X13D.NCF	961.03
10x16	1	1	4200	10X16.BCF	729.99	10X16.NCF	1,447.44

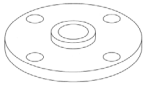

Fig. 71

**CAST IRON
REDUCING
FLANGES
THREADED
CLASS 125**

DESCRIPTION	PCS PER BOX	PCS PER MASTER	WEIGHT PER 100	PART # BLACK	PRICE (US\$) BLACK	PART # GALV.	PRICE (US\$) GALV.
3/4x5	10	10	300	EX5.BRF	210.58	EX5.NRF	343.17
1x5	10	10	300	1X5.BRF	215.31	1X5.NRF	343.17
1x6	6	6	450	1X6.BRF	205.22	1X6.NRF	327.76
1-1/4x6	6	6	400	1BX6.BRF	196.65	1BX6.NRF	332.52
1-1/2x6	6	6	425	1DX6.BRF	168.32	1DX6.NRF	332.52
1-1/2x7	6	6	637	1DX7.BRF	217.02	1DX7.NRF	339.26
2x7	6	6	615	2X7.BRF	157.46	2X7.NRF	366.41
1x7-1/2	5	5	810	1X7D.BRF	310.65	1X7D.NRF	498.41
1-1/4x7-1/2	5	5	800	1BX7D.BRF	310.65	1BX7D.NRF	480.4
1-1/2x7-1/2	5	5	825	1DX7D.BRF	260.19	1DX7D.NRF	515.19
2x7-1/2	5	5	800	2X7D.BRF	209.95	2X7D.NRF	493.66
2-1/2x7-1/2	5	5	800	2DX7D.BRF	225.31	2DX7D.NRF	515.19
1-1/2x9	5	5	1394	1DX9.BRF	384.32	1DX9.NRF	652.64
2x9	1	1	1403	2X9.BRF	285.36	2X9.NRF	691.64
2-1/2x9	1	1	1450	2DX9.BRF	306.2	2DX9.NRF	652.64
3x9	1	1	1313	3X9.BRF	285.36	3X9.NRF	691.64
3-1/2x9	5	5	1250	3DX9.BRF	346.11	3DX9.NRF	709.05
2x10	1	1	1850	2X10.BRF	525.91	2X10.NRF	841.80
2-1/2x10	1	1	1850	2DX10.BRF	525.91	2DX10.NRF	841.80
3x10	1	1	1750	3X10.BRF	527.48	3X10.NRF	824.69
4x10	1	1	1600	4X10.BRF	441.57	4X10.NRF	886.54
1-1/2x11	1	1	2410	1DX11.BRF	676.44	1DX11.NRF	1,123.36
2x11	1	1	2450	2X11.BRF	521.86	2X11.NRF	1,040.59
2-1/2x11	1	1	2225	2DX11.BRF	620.04	2DX11.NRF	1,116.52
3x11	1	1	2200	3X11.BRF	521.86	3X11.NRF	1,040.59
4x11	1	1	2012	4X11.BRF	430.38	4X11.NRF	1,030.40
5x11	1	1	1900	5X11.BRF	545.46	5X11.NRF	1,040.59
2x13-1/2	1	1	3080	2X13D.BRF	956.49	2X13D.NRF	1,725.07
3x13-1/2	1	1	3900	3X13D.BRF	956.49	3X13D.NRF	1,714.57
4x13-1/2	1	1	4056	4X13D.BRF	736.65	4X13D.NRF	1,528.81
5x13-1/2	1	1	4000	5X13D.BRF	1,033.92	5X13D.NRF	1,561.54
6x13-1/2	1	1	3800	6X13D.BRF	667.78	6X13D.NRF	1,643.13

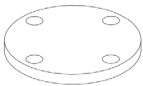

Fig. 19

**CAST IRON
BLIND FLANGES
CLASS 125**

DESCRIPTION	PCS PER BOX	PCS PER MASTER	WEIGHT PER 100	PART # BLACK	PRICE (US\$) BLACK	PART # GALV.	PRICE (US\$) GALV.
1-1/4x4-5/8	10	10	200	1B.BBF	122.52	1B.NBF	216.99
1-1/2x5	10	10	275	1DX5.BBF	130.06	1DX5.NBF	221.19
1x4-1/4	10	10	150	1X4B.BBF	115.96	1X4B.NBF	198.62
2x6	6	6	450	2X6.BBF	146.95	2X6.NBF	230.13
2-1/2x7	6	6	675	2DX7.BBF	161.51	2DX7.NBF	268.40
3x7-1/2	5	5	850	3X7D.BBF	193.57	3X7D.NBF	334.97
4x9	1	1	1456	4X9.BBF	247.94	4X9.NBF	468.82
5x10	1	1	2000	5X10.BBF	402.84	5X10.NBF	765.41
6x11	1	1	2475	6X11.BBF	438.24	6X11.NBF	812.57
8x13-1/2	1	1	4000	8X13D.BBF	687.59	8X13D.NBF	1,074.23
10x16	1	1	6044	10X16.BBF	1,017.20	10X16.NBF	1,794.60

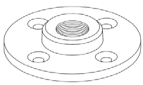

Fig. 15

**CAST IRON
FLOOR FLANGES
CLASS 125**

DESCRIPTION	PCS PER BOX	PCS PER MASTER	WEIGHT PER 100	PART # BLACK	PRICE (US\$) BLACK	PART # GALV.	PRICE (US\$) GALV.
3/8	25	150	36	C.BCFF	* 23.82	C.NCFF	46.34
1/2	30	120	46	D.BCFF	* 24.51	D.NCFF	61.19
3/4	30	120	48	E.BCFF	* 24.51	E.NCFF	61.19
1	30	60	87	1.BCFF	* 30.75	1.NCFF	55.84
1-1/4	30	60	80	1B.BCFF	* 30.75	1B.NCFF	74.22
1-1/2	20	40	137	1D.BCFF	* 39.59	1D.NCFF	95.13
2	15	30	215	2.BCFF	* 47.61	2.NCFF	120.76
3	10	10	225	3.BCFF	35.60		
4	10	10	450	4.BCFF	69.68		812.57



Fig. 14

**CAST IRON
FLANGES
UNIONS
CLASS 125**

DESCRIPTION	PCS PER BOX	PCS PER MASTER	WEIGHT PER 100	PART # BLACK	PRICE (US\$) BLACK	PART # GALV.	PRICE (US\$) GALV.
1/2	1	1	150	D.BFU	127.36	D.NFU	325.27
3/4	1	1	250	E.BFU	177.49	E.NFU	372.87
1	1	1	225	1.BFU	171.97	1.NFU	372.87
1-1/4	1	1	329	1B.BFU	203.4	1B.NFU	466.95
1-1/2	7	7	350	1D.BFU	187.71	1D.NFU	575.76
2	7	7	600	2.BFU	220.94	2.NFU	592.54
2-1/2	4	4	1000	2D.BFU	299.17	2D.NFU	891.87
3-1/2	4	4	1250	3D.BFU	574.15	3D.NFU	1,536.53
3	4	4	1115	3.BFU	338.42	3.NFU	1,182.4
4	3	3	1450	4.BFU	460.19	4.NFU	1,568.69
5	2	2	2500	5.BFU	1,072.56	5.NFU	1,759.46
6	2	2	2850	6.BFU	1,006.8	6.NFU	2,010.28

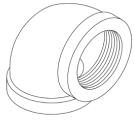

**CAST IRON
90° ELBOWS
CLASS 250**

DESCRIPTION	PCS PER BOX	PCS PER MASTER	WEIGHT PER 100	PART # BLACK	PRICE (US\$) BLACK	PART # GALV.	PRICE (US\$) GALV.
1/2	1	1	75	D.BC250L	48.88		
3/4	1	1	157	E.BC250L	49.77		
1	1	1	169	1.BC250L	60.19		
1-1/4	1	1	292	1B.BC250L	89.61		
1-1/2	1	1	386	1D.BC250L	111.17		
2	1	1	643	2.BC250L	137.18		
2-1/2	1	1	1056	2D.BC250L	333.00		

**CAST IRON
45° ELBOWS
CLASS 250**

DESCRIPTION	PCS PER BOX	PCS PER MASTER	WEIGHT PER 100	PART # BLACK	PRICE (US\$) BLACK	PART # GALV.	PRICE (US\$) GALV.
1/2	1	1	67	D.BC25045L	69.66		
3/4	1	1	104	E.BC25045L	67.26		
1	1	1	160	1.BC25045L	80.74		
1-1/4	1	1	270	1B.BC25045L	133.06		
1-1/2	1	1	355	1D.BC25045L	146.39		
2	1	1	617	2.BC25045L	208.19		
2-1/2	1	1	938	2D.BC25045L	359.48		



**CAST IRON
STRAIGHT TEES
CLASS 250**

DESCRIPTION	PCS PER BOX	PCS PER MASTER	WEIGHT PER 100	PART # BLACK	PRICE (US\$) BLACK	PART # GALV.	PRICE (US\$) GALV.
3/8	1	1	70	C.BC250T	79.65		
1/2	1	1	101	D.BC250T	76.37		
3/4	1	1	153	E.BC250T	76.31		
1	1	1	243	1.BC250T	92.13		
1-1/4	1	1	394	1B.BC250T	137.40		
1-1/2	1	1	531	1D.BC250T	176.79		
2	1	1	873	2.BC250T	219.32		
2-1/2	1	1	1423	2D.BC250T	468.00		

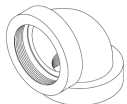

Fig. 31

**CAST IRON
DRAINAGE SHORT
TURN 90° ELBOWS**

DESCRIPTION	PCS PER BOX	PCS PER MASTER	WEIGHT PER 100	PART # BLACK	PRICE (US\$) BLACK	PART # GALV.	PRICE (US\$) GALV.
1-1/2	25	25	193	1D.BDL	57.03	1D.NDL	84.52
2	15	15	301	2.BDL	85.89	2.NDL	122.13
3	6	6	750	3.BDL	322.61	3.NDL	482.78
4	2	2	1150	4.BDL	510.94	4.NDL	939.61
2x1-1/2	20	20	275	2X1D.BDL	*	2X1D.NDL	134.22

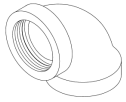

Fig. 33

DRAINAGE LONG TURN 90° ELBOWS

DESCRIPTION	PCS PER BOX	PCS PER MASTER	WEIGHT PER 100	PART # BLACK	PRICE (US\$) BLACK	PART # GALV.	PRICE (US\$) GALV.
1-1/2	15	15	216	1D.BDLTL	79.80	1D.NDLTL	96.11
2	10	10	360	2.BDLTL	118.83	2.NDLTL	164.98
3	5	5	838	3.BDLTL	* 433.41	3.NDLTL	510.47

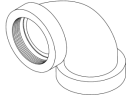

Fig. 78

DRAINAGE EXTRA LONG TURN 90° ELBOWS

DESCRIPTION	PCS PER BOX	PCS PER MASTER	WEIGHT PER 100	PART # BLACK	PRICE (US\$) BLACK	PART # GALV.	PRICE (US\$) GALV.
1-1/2	15	15	324	1D.BDXLTL	103.05	1D.NDXLTL	146.44
2	10	10	415	2.BDXLTL	178.22	2.NDXLTL	234.42



Fig. 37

DRAINAGE SHORT TURN 60° ELBOWS

DESCRIPTION	PCS PER BOX	PCS PER MASTER	WEIGHT PER 100	PART # BLACK	PRICE (US\$) BLACK	PART # GALV.	PRICE (US\$) GALV.
1-1/2	25	25	182	1D.BD60L	103.23	1D.ND60L	160.16
2	15	15	270	2.BD60L	118.48	2.ND60L	156.73

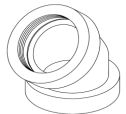

Fig. 32

DRAINAGE SHORT TURN 45° ELBOWS

DESCRIPTION	PCS PER BOX	PCS PER MASTER	WEIGHT PER 100	PART # BLACK	PRICE (US\$) BLACK	PART # GALV.	PRICE (US\$) GALV.
1-1/4	25	25	135	1B.BD45L	53.48	1B.ND45L	81.81
1-1/2	25	25	168	1D.BD45L	55.75	1D.ND45L	83.54
2	15	15	257	2.BD45L	80.49	2.ND45L	119.55
3	6	6	694	3.BD45L	315.23	3.ND45L	416.06
4	2	2	1100	4.BD45L	492.75	4.ND45L	679.84

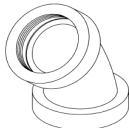

Fig. 34

DRAINAGE LONG TURN 45° ELBOWS

DESCRIPTION	PCS PER BOX	PCS PER MASTER	WEIGHT PER 100	PART # BLACK	PRICE (US\$) BLACK	PART # GALV.	PRICE (US\$) GALV.
1-1/2	15	15	210	1D.BDLT45L	78.35	1D.NDLT45L	95.08
2	10	10	310	2.BDLT45L	* 133.57	2.NDLT45L	167.76



Fig. 74

DRAINAGE SHORT TURN 22-1/2° ELBOWS

DESCRIPTION	PCS PER BOX	PCS PER MASTER	WEIGHT PER 100	PART # BLACK	PRICE (US\$) BLACK	PART # GALV.	PRICE (US\$) GALV.
1-1/2	25	25	149	1D.BD22L	70.27	1D.ND22L	90.60
2	15	15	260	2.BD22L	93.61	2.ND22L	135.51



Fig. 75

DRAINAGE SHORT TURN 11-1/4° ELLS

DESCRIPTION	PCS PER BOX	PCS PER MASTER	WEIGHT PER 100	PART # BLACK	PRICE (US\$) BLACK	PART # GALV.	PRICE (US\$) GALV.
1-1/2	25	25	149	1D.BD11L	74.79	1D.ND11L	96.87

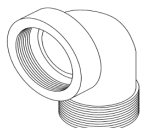

Fig. 35

DRAINAGE STREET 90° ELBOWS

DESCRIPTION	PCS PER BOX	PCS PER MASTER	WEIGHT PER 100	PART # BLACK	PRICE (US\$) BLACK	PART # GALV.	PRICE (US\$) GALV.
1-1/2	25	25	180	1D.BDSTL	81.31	1D.NDSTL	107.04
2	15	15	260	2.BDSTL	107.65	2.NDSTL	167.75



Fig. 36

DRAINAGE STREET 45° ELBOWS

DESCRIPTION	PCS PER BOX	PCS PER MASTER	WEIGHT PER 100	PART # BLACK	PRICE (US\$) BLACK	PART # GALV.	PRICE (US\$) GALV.
1-1/2	25	25	155	1D.BDST45L	75.94	1D.NDST45L	110.77
2	15	15	240	2.BDST45L	122.92	2.NDST45L	170.45



Fig. 38

DRAINAGE TEES

DESCRIPTION	PCS PER BOX	PCS PER MASTER	WEIGHT PER 100	PART # BLACK	PRICE (US\$) BLACK	PART # GALV.	PRICE (US\$) GALV.
1-1/2	15	15	270	1D.BDT	93.72	1D.NDT	127.07
2	10	10	425	2.BDT	154.95	2.NDT	212.66
2x1-1/2	10	10	350	2X1D.BDT	* 176.43	2X1D.NDT	239.97



Fig. 39

DRAINAGE SHORT TURN 90° TYS

DESCRIPTION	PCS PER BOX	PCS PER MASTER	WEIGHT PER 100	PART # BLACK	PRICE (US\$) BLACK	PART # GALV.	PRICE (US\$) GALV.
1-1/2	15	15	320	1D.BDTY	92.03	1D.NDTY	128.61
2	10	10	488	2.BDTY	151.68	2.NDTY	210.18
4	1	1	2000	4.BDTY	827.56	4.NDTY	1,014.58
2x1-1/2	10	10	370	2X1D.BDTY	155.96	2X1D.NDTY	241.28
2x1-1/2x1-1/2	10	10	350	2X1DX1D.BDTY	155.96	2X1DX1D.NDTY	227.62
2x1-1/2x2	10	10	475	2X1DX2.BDTY	155.96	2X1DX2.NDTY	227.62



Fig. 40

DRAINAGE LONG TURN 90° TYS

DESCRIPTION	PCS PER BOX	PCS PER MASTER	WEIGHT PER 100	PART # BLACK	PRICE (US\$) BLACK	PART # GALV.	PRICE (US\$) GALV.
1-1/2	10	10	440	1D.BDLTTY	* 153.79	1D.NDLTTY	213.69
2	6	6	700	2.BDLTTY	239.81	2.NDLTTY	387.53
2x1-1/2	8	8	500	2X1D.BDLTTY	251.69	2X1D.NDLTTY	387.55
2x1-1/2x1-1/2			500			2X1DX1D.NDLTTY	413.15
2x1-1/2x2	8	8	740	2X1DX2.BDLTTY	207.18		



Fig. 41

DRAINAGE SHORT TURN 45° Y BRANCHES

DESCRIPTION	PCS PER BOX	PCS PER MASTER	WEIGHT PER 100	PART # BLACK	PRICE (US\$) BLACK	PART # GALV.	PRICE (US\$) GALV.
1-1/2	15	15	360	1D.BDY	112.71	1D.NDY	142.66
2	10	10	509	2.BDY	210.21	2.NDY	286.00
3	1	1	1345	3.BDY	725.02	3.NDY	1,014.14
4	1	1	2400	4.BDY	1,081.8	4.NDY	1,555.93
2x1-1/2x1-1/2	10	10	452	2X1DX1D.BDY	236.25	2X1DX1D.NDY	320.54
2x2x1-1/2	10	10	450	2X1D.BDY	207.85	2X1D.NDY	252.63
2x1-1/2x2	10	10	585	2X1DX2.BDY	193.99		
4x3	1	1	2000	4X3.BDY	1,129.67	4X3.NDY	1,589.44



Fig. 42

DRAINAGE DOUBLE 90° Y BRANCHES

DESCRIPTION	PCS PER BOX	PCS PER MASTER	WEIGHT PER 100	PART # BLACK	PRICE (US\$) BLACK	PART # GALV.	PRICE (US\$) GALV.
1-1/2	10	10	376	1D.BDDY	220.32	1D.NDDY	273.26
2	8	8	650	2.BDDY	225.84	2.NDDY	318.79
2x1-1/2	8	8	513	2X1D.BDDY	231.73	2X1D.NDDY	318.79



Fig. 45

DRAINAGE P TRAP WITH CLEANOUT

DESCRIPTION	PCS PER BOX	PCS PER MASTER	WEIGHT PER 100	PART # BLACK	PRICE (US\$) BLACK	PART # GALV.	PRICE (US\$) GALV.
1-1/2	10	10	469	1D.BDPT	167.46	1D.NDPT	230.71
2	8	8	600	2.BDPT	268.12	2.NDPT	403.82



Fig. 46

P TRAP WITHOUT DRAIN

DESCRIPTION	PCS PER BOX	PCS PER MASTER	WEIGHT PER 100	PART # BLACK	PRICE (US\$) BLACK	PART # GALV.	PRICE (US\$) GALV.
1-1/2	10	10	380	1D.BDPTWO	172.29	1D.NDPTWO	226.73
2	8	8	647	2.BDPTWO	275.79	2.NDPTWO	396.89

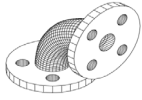

FLANGED 90° ELLS

DESCRIPTION	PCS PER BOX	PCS PER MASTER	WEIGHT PER 100	PART # BLACK	PRICE (US\$) BLACK	PART # GALV.	PRICE (US\$) GALV.
2	1	1	1300	2.BFL	499.35	2.NFL	1,036.22
2-1/2	1	1	1900	2D.BFL	540.14	2D.NFL	1,417.49
3	1	1	2700	3.BFL	450.83	3.NFL	1,397.34
4	1	1	4000	4.BFL	557.55	4.NFL	1,273.92
5	1	1	5700	5.BFL	1,320.48	5.NFL	2,685.03
6	1	1	7000	6.BFL	872.96	6.NFL	2,051.03
8	1	1	11600	8.BFL	1,507.36	8.NFL	3,194.75
10	1	1	17700	10.BFL	3,303.64	10.NFL	5,911.85
12	1	1	24800	12.BFL	6,650.43	12.NFL	9,864.87
3X2-1/2	1	1	2300	3X2D.BFL	1,670.25	3X2D.NFL	2,051.48
3X2	1	1	2100	3X2.BFL	1,531.09	3X2.NFL	1,812.11
4X3	1	1	3500	4X3.BFL	1,236.89	4X3.NFL	1,926.19
4X2-1/2	1	1	3500	4X2D.BFL	1,890.45	4X2D.NFL	2,237.48
4X2	1	1	3200	4X2.BFL	1,890.45	4X2.NFL	2,237.48
5X4	1	1	6500	5X4.BFL	2,515.33		
6X5	1	1	6600	6X5.BFL	2,605.88	6X5.NFL	3,084.60
6X4	1	1	6700	6X4.BFL	1,533.87	6X4.NFL	3,107.72
6X3	1	1	5900	6X3.BFL	2,724.35	6X3.NFL	3,679.40
8X6	1	1	9200	8X6.BFL	2,237.96	8X6.NFL	4,413.23
8X5	1	1	9200	8X5.BFL	3,986.74	8X5.NFL	5,384.39
8X4	1	1	8900	8X4.BFL	3,017.88	8X4.NFL	5,235.91
10X8	1	1	16000	10X8.BFL	4,261.20	10X8.NFL	8,174.62
10X6	1	1	15500	10X6.BFL	6,224.54	10X6.NFL	8,406.33
12X6	1	1	23400	12X6.BFL	11,820.51		
12X10	1	1	23700	12X10.BFL	8,165.78	12X10.NFL	14,175.8
12X8	1	1	23400	12X8.BFL	10,790.78	12X8.NFL	14,573.15

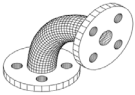

FLANGED LONG RADIUS 90° ELLS

DESCRIPTION	PCS PER BOX	PCS PER MASTER	WEIGHT PER 100	PART # BLACK	PRICE (US\$) BLACK	PART # GALV.	PRICE (US\$) GALV.
2	1	1	1500	2.BFLL	1,344.69	2.NFLL	1,737.06
3	1	1	2800	3.BFLL	1,452.61	3.NFLL	2,460.89
4	1	1	4700	4.BFLL	1,332.18	4.NFLL	3,486.59
6	1	1	9200	6.BFLL	1,926.94	6.NFLL	3,704.51
8	1	1	13400	8.BFLL	3,703.80	8.NFLL	6,444.61
10	1	1	21600	10.BFLL	5,765.75	10.NFLL	10,010.33
12	1	1	35600	12.BFLL	11,880.55	12.NFLL	19,712.42



FLANGED LONG RADIUS 90° REDUCING ELLS

DESCRIPTION	PCS PER BOX	PCS PER MASTER	WEIGHT PER 100	PART # BLACK	PRICE (US\$) BLACK	PART # GALV.	PRICE (US\$) GALV.
4X3	1	1	4200	4X3.BFLL	3,170.94	4X3.NFLL	3,704.72
6X4	1	1	8100	6X4.BFLL	4,138.82	6X4.NFLL	5,589.55
8X6	1	1	13000	8X6.BFLL	7,650.31	8X6.NFLL	9,920.76

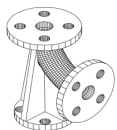

FLANGED 90° BASE ELLS

DESCRIPTION	PCS PER BOX	PCS PER MASTER	WEIGHT PER 100	PART # BLACK	PRICE (US\$) BLACK	PART # GALV.	PRICE (US\$) GALV.
4	1	1	5200	4.BFBL	2,166.47	4.NFBL	2,925.77
6	1	1	8800	6.BFBL	3,691.16	6.NFBL	4,985.07
8	1	1	15300	8.BFBL	4,891.72	8.NFBL	6,603.56
10	1	1	22700	10.BFBL	8,213.28	10.NFBL	10,610.04
12	1	1	34000	12.BFBL	11,310.94		

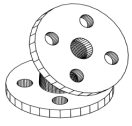

FLANGED 45° ELLS

DESCRIPTION	PCS PER BOX	PCS PER MASTER	WEIGHT PER 100	PART # BLACK	PRICE (US\$) BLACK	PART # GALV.	PRICE (US\$) GALV.
2	1	1	1100	2.BF45L	723.54	2.NF45L	1,335.92
2-1/2	1	1	1900	2D.BF45L	771.73	2D.NF45L	1,318.40
3	1	1	2100	3.BF45L	750.46	3.NF45L	1,482.46
4	1	1	3700	4.BF45L	844.68	4.NF45L	1,839.31
5	1	1	3700	5.BF45L	2,024.03	5.NF45L	3,324.21
6	1	1	6000	6.BF45L	1,380.94	6.NF45L	2,565.74
8	1	1	9600	8.BF45L	2,019.38	8.NF45L	3,848.21
10	1	1	14700	10.BF45L	4,267.04	10.NF45L	7,365.04
12	1	1	21200	12.BF45L	6,520.02	12.NF45L	11,249.38

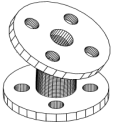

FLANGED 22-1/2° ELLS

DESCRIPTION	PCS PER BOX	PCS PER MASTER	WEIGHT PER 100	PART # BLACK	PRICE (US\$) BLACK	PART # GALV.	PRICE (US\$) GALV.
4	1	1	3530	4.BF22L	948.08	4.NF22L	1,819.62
6	1	1	5730	6.BF22L	1,368.93	6.NF22L	2,628.29
8	1	1	9230	8.BF22L	2,053.76	8.NF22L	3,942.81
12	1	1	21610	12.BF22L	6,450.75	12.NF22L	10,667.41

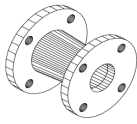

FLANGED CONCENTRIC REDUCERS

DESCRIPTION	PCS PER BOX	PCS PER MASTER	WEIGHT PER 100	PART # BLACK	PRICE (US\$) BLACK	PART # GALV.	PRICE (US\$) GALV.
2-1/2X2	1	1	1400	2D.X2.BFCRD	1,260.27	2D.X2.NFCRD	1,998.19
3X2-1/2	1	1	2000	3X2D.BFCRD	1,000.49	3X2D.NFCRD	1,640.66
3X2	1	1	1700	3X2.BFCRD	1,000.49	3X2.NFCRD	1,709.58
4X3	1	1	2900	4X3.BFCRD	1,124.14	4X3.NFCRD	1,995.48
4X2-1/2	1	1	2700	4X2D.BFCRD	1,209.2	4X2D.NFCRD	2,369.01
4X2	1	1	2400	4X2.BFCRD	1,336.44	4X2.NFCRD	2,369.01
5X3	1	1	4100	5X3.BFCRD	1,977.19	5X3.NFCRD	3,484.93
5X4	1	1	4000	5X4.BFCRD	1,738.22	5X4.NFCRD	3,091.82
6X5	1	1	5200	6X5.BFCRD	1,653.72	6X5.NFCRD	3,353.53
6X4	1	1	5000	6X4.BFCRD	1,505.46	6X4.NFCRD	2,907.40
6X3	1	1	4200	6X3.BFCRD	1,733.05	6X3.NFCRD	3,417.78
6X2-1/2	1	1	3900	6X2D.BFCRD	2,286.38	6X2D.NFCRD	3,948.47
6X2	1	1	3900	6X2.BFCRD	3,023.05	6X2.NFCRD	5,020.89
8X6	1	1	8000	8X6.BFCRD	1,894.68	8X6.NFCRD	3,366.13
8X5	1	1	7500	8X5.BFCRD	3,430.8	8X5.NFCRD	4,703.26
8X4	1	1	7400	8X4.BFCRD	2,182.6	8X4.NFCRD	4,396.39
10X8	1	1	12000	10X8.BFCRD	3,907.42	10X8.NFCRD	7,704.26
10X6	1	1	10800	10X6.BFCRD	4,255.89	10X6.NFCRD	8,560.36
12X10	1	1	19500	12X10.BFCRD	6,739.68	12X10.NFCRD	12,935.96
12X8	1	1	15800	12X8.BFCRD	7,449.23	12X8.NFCRD	12,935.96
12X6	1	1	15300	12X6.BFCRD	7,788.64	12X6.NFCRD	13,524.22

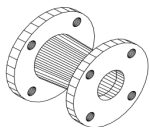

FLANGED ECCENTRIC REDUCERS

DESCRIPTION	PCS PER BOX	PCS PER MASTER	WEIGHT PER 100	PART # BLACK	PRICE (US\$) BLACK	PART # GALV.	PRICE (US\$) GALV.
3X2	1	1	1700	3X2.BFERD	1,509.23	3X2.NFERD	2,038.24
3x2-1/2	1	1	1600	3X2D.BFERD	1,531.09	3X2D.NFERD	2,039.49
4X3	1	1	2800	4X3.BFERD	1,824.56	4X3.NFERD	2,723.45
4X2	1	1	2500	4X2.BFERD	2,108.32	4X2.NFERD	2,723.45
4X2-1/2	1	1	2500	4X2D.BFERD	2,123.44		
6X5	1	1	5500	6X5.BFERD	1,723.37	6X5.NFERD	3,399.71
6X4	1	1	4900	6X4.BFERD	1,723.37	6X4.NFERD	3,238.24
6X3	1	1	4400	6X3.BFERD	2,876.64	6X3.NFERD	3,884.74
8X6	1	1	8400	8X6.BFERD	2,183.04	8X6.NFERD	4,098.47
8X5	1	1	7500	8X5.BFERD	2,831.75	8X5.NFERD	4,916.87
8X4	1	1	7300	8X4.BFERD	2,960.41	8X4.NFERD	4,916.87
10X8	1	1	12500	10X8.BFERD	5,560.76	10X8.NFERD	8,425.61
10X6	1	1	11200	10X6.BFERD	6,522.27	10X6.NFERD	8,808.52
12X10	1	1	18500	12X10.BFERD	7,537.60	12X10.NFERD	11,528.63
12X8	1	1	16700	12X8.BFERD	7,806.82	12X8.NFERD	13,555.64

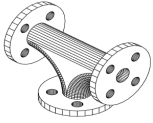

STANDARD FLANGED TEES

DESCRIPTION	PCS PER BOX	PCS PER MASTER	WEIGHT PER 100	PART # BLACK	PRICE (US\$) BLACK	PART # GALV.	PRICE (US\$) GALV.
2	1	1	1700	2.BFT	546.75	2.NFT	977.69
2-1/2	1	1	2700	2D.BFT	796.33	2D.NFT	1,320.11
3	1	1	4400	3.BFT	558.09	3.NFT	1,325.45
4	1	1	6400	4.BFT	848.94	4.NFT	2,088.36
5	1	1	8300	5.BFT	2,274.18	5.NFT	3,116.22
6	1	1	10500	6.BFT	1,231.96	6.NFT	2,885.14
8	1	1	16300	8.BFT	2,104.75	8.NFT	4,548.65
10	1	1	26000	10.BFT	5,663.31	10.NFT	8,633.35
12	1	1	40200	12.BFT	8,896.47	12.NFT	13,188.54

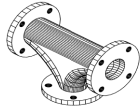

REDUCING FLANGED TEES

DESCRIPTION	PCS PER BOX	PCS PER MASTER	WEIGHT PER 100	PART # BLACK	PRICE (US\$) BLACK	PART # GALV.	PRICE (US\$) GALV.
3X3X2-1/2	1	1	3800	3X2D.BFT	1,656.74	3X2D.NFT	2,259.71
3 X3X2	1	1	3400	3X2.BFT	1,296.87	3X2.NFT	2,252.21
4X4X6	1	1	8300	4X6.BFT	3,374.34	4X6.NFT	4,431.55
4 X4X3	1	1	5900	4X3.BFT	1,747.37	4X3.NFT	3,031.72
4 X3X4	1	1	5500	4X3X4.BFT	4,178.59		
4 X4X2-1/2	1	1	5500	4X2D.BFT	1,908.27	4X2D.NFT	3,171.73
4X4X2	1	1	5400	4X2.BFT	1,747.37	4X2.NFT	2,906.53
6X4X6	1	1	9500	6X4X6.BFT	1,938.14	6X4X6.NFT	3,823.48
6X4X3	1	1	8600	6X4X3.BFT	706.87		
6X4X4	1	1	9000	6X4X4.BFT	2,142.21	6X4X4.NFT	3,800.23
6X6X8	1	1	13800	6X8.BFT	4,172.71	6X8.NFT	7,246.65
6X6X4	1	1	9600	6X4.BFT	1,682.17	6X4.NFT	3,272.42
6X6X3	1	1	9700	6X3.BFT	2,447.12	6X3.NFT	4,248.19
6X6X2-1/2	1	1	8800	6X2D.BFT	3,274.19	6X2D.NFT	4,232.87
6X6X2	1	1	8700	6X2.BFT	3,437.94	6X2.NFT	4,439.65
8X4X8	1	1	13800	8X4X8.BFT	5,624.99		
8X6X8	1	1	14900	8X6X8.BFT	4,172.71	8X6X8.NFT	7,497.01
8X6X6	1	1	13900	8X6X6.BFT	3,158.23	8X6X6.NFT	6,225.72
8X6X4	1	1	12700	8X6X4.BFT	5,354.01	8X6X4.NFT	6,779.48
8X8X6	1	1	15500	8X6.BFT	2,627.83	8X6.NFT	5,817.44
8X8X4	1	1	14400	8X4.BFT	3,157.73	8X4.NFT	5,930.02
10X8X8	1	1	23600	10X8X8.BFT	6,639.43	10X8X8.NFT	11,281.97
10X8X10	1	1	24900	10X8X10.BFT	9,587.39		
12X12X4	1	1	34100	12X4.BFT	9,879.02		
10X10X12	1	1	34200	10X12.BFT	10,300.21	10X12.NFT	18,088.62
10X10X8	1	1	24900	10X8.BFT	6,007.18	10X8.NFT	11,281.97
10X10X6	1	1	22900	10X6.BFT	6,986.24	10X6.NFT	11,290.27
10X10X4	1	1	22000	10X4.BFT	6,822.58	10X4.NFT	11,331.07
12X10X10	1	1	34200	12X10X10.BFT	3,390.33		
12X12X10	1	1	36700	12X10.BFT	10,397.67	12X10.NFT	17,108.45
12X12X8	1	1	36700	12X8.BFT	10,547.86	12X8.NFT	17,108.45
12X12X6	1	1	35700	12X6.BFT	8,914.63	12X6.NFT	17,108.45

FLANGED BASE TEES

DESCRIPTION	PCS PER BOX	PCS PER MASTER	WEIGHT PER 100	PART # BLACK	PRICE (US\$) BLACK	PART # GALV.	PRICE (US\$) GALV.
3	1	1	3800	3.BFBT	1,656.74	3X2D.NFT	2,259.71
4	1	1	3400	4.BFBT	1,296.87	3X2.NFT	2,252.21
6	1	1	8300	6.BFBT	3,374.34	4X6.NFT	4,431.55
8	1	1	5900	8.BFBT	1,747.37	4X3.NFT	3,031.72
10	1	1	5500	10.BFBT	4,178.59		
12	1	1	5500	12.BFBT	1,908.27	4X2D.NFT	3,171.73



FLANGED CROSSES

DESCRIPTION	PCS PER BOX	PCS PER MASTER	WEIGHT PER 100	PART # BLACK	PRICE (US\$) BLACK	PART # GALV.	PRICE (US\$) GALV.
2	1	1	3000	2.BFCR	1,791.23		
2-1/2	1	1	4100	2D.BFCR	1,586.78	2D.NFCR	2,858.04
3	1	1	5000	3.BFCR	1,666.16	3.NFCR	2,762.63
4	1	1	8200	4.BFCR	2,176.36	4.NFCR	3,777.54
6	1	1	13400	6.BFCR	4,557.94	6.NFCR	6,155.98
8	1	1	21300	8.BFCR	7,340.82	8.NFCR	9,481.73
10	1	1	33000	10.BFCR	8,708.26	10.NFCR	15,394.99
12	1	1	46000	12.BFCR	13,284.45	12.NFCR	23,332.33



FLANGED REDUCING CROSSES

DESCRIPTION	PCS PER BOX	PCS PER MASTER	WEIGHT PER 100	PART # BLACK	PRICE (US\$) BLACK	PART # GALV.	PRICE (US\$) GALV.
6X4	1	1	11900	6X4.BFCR	3,079.59	6X4.NFCR	5,027.53
8X6	1	1	18400	8X6.BFCR	4,761.92	8X6.NFCR	7,771.75

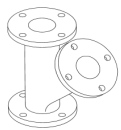

FLANGED LATERAL

DESCRIPTION	PCS PER BOX	PCS PER MASTER	WEIGHT PER 100	PART # BLACK	PRICE (US\$) BLACK	PART # GALV.	PRICE (US\$) GALV.
2-1/2	1	1	3400	2D.BFLAT	2,232.24	2D.NFLAT	3,285.08
3	1	1	4500	3.BFLAT	2,387.84	3.NFLAT	3,175.22
4	1	1	7700	4.BFLAT	3,117.08	4.NFLAT	4,209.84
6	1	1	13000	6.BFLAT	4,742.15	6.NFLAT	7,185.41
8	1	1	21300	8.BFLAT	7,770.35	8.NFLAT	10,651.51
10	1	1	33500	10.BFLAT	10,031.67	10.NFLAT	17,609.69
12	1	1	51500	12.BFLAT	15,452.94		

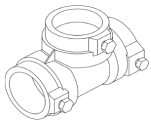

WARDLOX TEES SLIP X SLIP X SLIP

DESCRIPTION	PCS PER BOX	PCS PER MASTER	WEIGHT PER 100	PART # BLACK	PRICE (US\$) BLACK	PART # GALV.	PRICE (US\$) GALV.
1X1X1	12	12	289	1.BWST	93.78	1.NWST	111.29
1-1/4 X 1-1/4 X 1-1/4	12	12	366	1B.BWST	93.78	1B.NWST	113.47
1-1/2 X 1-1/2 X 1-1/2	12	12	388	1D.BWST	95.27	1D.NWST	124.12
2 X 2 X 2	4	4	641	2.BWST	130.85	2.NWST	167.53

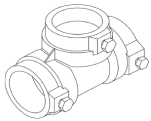

WARDLOX REDUCING OUTLET TEES SLIP X SLIP X SLIP

DESCRIPTION	PCS PER BOX	PCS PER MASTER	WEIGHT PER 100	PART # BLACK	PRICE (US\$) BLACK	PART # GALV.	PRICE (US\$) GALV.
2X2X1	8	8	467	2X1.BWST	114.63	2X1.NWST	142.03
2X2X1-1/4	5	5	529	2X1B.BWST	114.63	2X1B.NWST	142.03
2X2X1-1/2	5	5	593	2X1D.BWST	114.63	2X1D.NWST	142.03

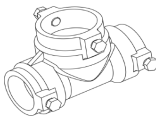

WARDLOX BULLHEAD TEES SLIP X SLIP X SLIP

DESCRIPTION	PCS PER BOX	PCS PER MASTER	WEIGHT PER 100	PART # BLACK	PRICE (US\$) BLACK	PART # GALV.	PRICE (US\$) GALV.
1-1/2 X 1-1/2 X 2	5	5	535	1DX2.BWST	114.63	1DX2.NWST	142.03

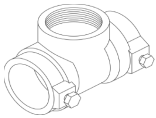

WARDLOX REDUCING OUTLET TEES SLIP X SLIP X THREAD

DESCRIPTION	PCS PER BOX	PCS PER MASTER	WEIGHT PER 100	PART # BLACK	PRICE (US\$) BLACK	PART # GALV.	PRICE (US\$) GALV.
1X1X1/2	20	20	200	1XD.BWT	64.28	1XD.NWT	79.28
1X1X3/4	20	20	196	1XE.BWT	64.28	1XE.NWT	84.04
1X1X1	20	20	174	1.BWT	64.28	1.NWT	84.04
1-1/4X1-1/4X1/2	15	15	249	1BXD.BWT	64.28	1BXD.NWT	84.04
1-1/4X1-1/4X3/4	15	15	256	1BXE.BWT	64.28	1BXE.NWT	79.28
1-1/4X1-1/4X1	15	15	240	1BX1.BWT	64.28	1BX1.NWT	84.04
1-1/2X1-1/2X1/2	15	15	298	1DXD.BWT	68.08	1DXD.NWT	84.71
1-1/2X1-1/2X3/4	10	10	292	1DXE.BWT	68.08	1DXE.NWT	89.79
1-1/2X1-1/2X1	10	10	285	1DX1.BWT	68.08	1DX1.NWT	73.73
2X2X1/2	9	9	402	2XD.BWT	83.36	2XD.NWT	104.00
2X2X3/4	9	9	393	2XE.BWT	83.36	2XE.NWT	110.24
2X2X1	9	9	366	2X1.BWT	83.36	2X1.NWT	110.24

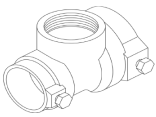

WARDLOX REDUCING RUN & OUTLET TEES SLIP X SLIP X THREAD

DESCRIPTION	PCS PER BOX	PCS PER MASTER	WEIGHT PER 100	PART # BLACK	PRICE (US\$) BLACK	PART # GALV.	PRICE (US\$) GALV.
1-1/4X1X1/2	15	15	233	1BX1XD.BWT	68.76	1BX1XD.NWT	84.71
1-1/4X1X3/4	15	15	240	1BX1XE.BWT	56.44		
1-1/4X1X1	15	15	236	1BX1X1.BWT	68.76	1BX1X1.NWT	79.73
1-1/2X1-1/4X1/2	10	10	276	1DX1BXD.BWT	72.95	1DX1BXD.NWT	95.62
1-1/2X1-1/4X3/4	10	10	288	1DX1BXE.BWT	72.95	1DX1BXE.NWT	95.62
1-1/2X1-1/4X1	10	10	272	1DX1BX1.BWT	72.95	1DX1BX1.NWT	78.53
2X1-1/2X1/2	9	9	381	2X1DXD.BWT	88.23	2X1DXD.NWT	109.41
2X1-1/2X3/4	9	9	372	2X1DXE.BWT	88.23	2X1DXE.NWT	109.41
2X1-1/2X1	9	9	360	2X1DX1.BWT	88.23	2X1DX1.NWT	115.97

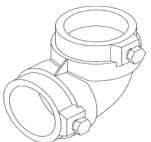

WARDLOX 90° ELBOWS SLIP X SLIP

DESCRIPTION	PCS PER BOX	PCS PER MASTER	WEIGHT PER 100	PART # BLACK	PRICE (US\$) BLACK	PART # GALV.	PRICE (US\$) GALV.
1	20	20	206	1.BWL	68.62	1.NWL	73.73
1-1/4	15	15	253	1B.BWL	80.24	1B.NWL	84.05
1-1/2	10	10	290	1D.BWL	87.95	1D.NWL	113.53
2	6	6	415	2.BWL	103.93	2.NWL	134.86



**WARDLOX ADAPTER
ELBOWS SLIP X
THREAD**

DESCRIPTION	PCS PER BOX	PCS PER MASTER	WEIGHT PER 100	PART # BLACK	PRICE (US\$) BLACK	PART # GALV.	PRICE (US\$) GALV.
1X1/2	25	25	150	1XD.BWL	81.88	1XD.NWL	107.22
1X3/4	25	25	138	1XE.BWL	81.88	1XE.NWL	107.22
1X1	25	25	160	1X1.BWL	81.88	1X1.NWL	107.22
1-1/4X1/2	15	15	207	1BXD.BWL	84.72	1BXD.NWL	114.12
1-1/4X3/4	15	15	199	1BXE.BWL	84.72	1BXE.NWL	107.65
1-1/4X1	15	15	188	1BX1.BWL	84.72	1BX1.NWL	107.65
1-1/2X1/2	10	10	248	1DXD.BWL	87.17	1DXD.NWL	120.55
1-1/2X3/4	10	10	236	1DXE.BWL	87.17	1DXE.NWL	120.55
1-1/2X1	10	10	238	1DX1.BWL	87.17	1DX1.NWL	120.55
2X1/2	9	9	302	2XD.BWL	89.86	2XD.NWL	125.68
2X3/4	9	9	323	2XE.BWL	89.86	2XE.NWL	118.59
2X1	9	9	288	2X1.BWL	89.86	2X1.NWL	125.68

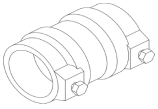

**WARDLOX
COUPLINGS
SLIP X SLIP**

DESCRIPTION	PCS PER BOX	PCS PER MASTER	WEIGHT PER 100	PART # BLACK	PRICE (US\$) BLACK	PART # GALV.	PRICE (US\$) GALV.
1X1	25	25	154	1.BWC	61.44	1.NWC	80.01
1-1/4X1-1/4	15	15	227	1B.BWC	61.44	1B.NWC	65.69
1-1/2X1-1/2	15	15	261	1D.BWC	77.26	1D.NWC	78.99
2X2	10	10	360	2.BWC	77.26	2.NWC	104.37

**WARDLOX
GASKETS
SLIP X SLIP**

DESCRIPTION	PCS PER BOX	PCS PER MASTER	WEIGHT PER 100	PART # BLACK	PRICE (US\$) BLACK	PART # GALV.	PRICE (US\$) GALV.
1	25	25	2.9			1.WG	17.62
1-1/4	25	25	3			1B.WG	20.62
1-1/2	25	25	3.1			1D.WG	24.49
2	1	1	3.2			2.WG	25.89

**WARDLOX BOLT/
SOCKETS**

DESCRIPTION	PCS PER BOX	PCS PER MASTER	WEIGHT PER 100	PART # BLACK	PRICE (US\$) BLACK	PART # GALV.	PRICE (US\$) GALV.
3/8 Square Head	1500	1500	4	WB	7.31		

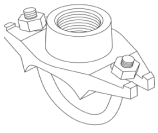

**TEELOX
MECHANICAL
BRANCH
CONNECTOR**

DESCRIPTION	PCS PER BOX	PCS PER MASTER	WEIGHT PER 100	PART # BLACK	PRICE (US\$) BLACK	PART # GALV.	PRICE (US\$) GALV.
1-1/4X1/2	25	25	98	1BXD.BTLX	14.96	1BXD.NTLX	28.52
1-1/4X3/4	25	25	99	1BXE.BTLX	14.96	1BXE.NTLX	28.52
1-1/4X1	25	25	108	1BXI.BTLX	18.66	1BXI.NTLX	30.06
1-1/2X1/2	25	25	98	1DXD.BTLX	14.96	1DXD.NTLX	30.06
1-1/2X3/4	25	25	99	1DXE.BTLX	14.96	1DXE.NTLX	30.06
1-1/2X1	25	25	108	1DXI.BTLX	18.66	1DXI.NTLX	30.06
2X1/2	25	25	96	2XD.BTLX	14.96	2XD.NTLX	30.06
2X3/4	25	25	85	2XE.BTLX	14.96	2XE.NTLX	30.06
2X1	25	25	99	2XI.BTLX	18.66	2XI.NTLX	31.39
2-1/2X1/2	25	25	121	2DXD.BTLX	14.96	2DXD.NTLX	35.06
2-1/2X3/4	25	25	120	2DXE.BTLX	14.96	2DXE.NTLX	35.06
2-1/2X1	25	25	111	2DXI.BTLX	18.66	2DXI.NTLX	57.13

SPECIFICATIONS

DESCRIPTION	A	B	C
1-1/4X1/2	2	1-1/2	1-3/16
1-1/4X3/4	2-1/16	1-1/2	1-3/16
1-1/4X1	2-1/8	1-1/2	1-3/16
1-1/2X1/2	2	1-1/2	1-3/16
1-1/2X3/4	2-1/16	1-1/2	1-3/16
1-1/2X1	2-1/8	1-1/2	1-3/16
2X1/2	2-5/16	1-13/16	1-3/16
2X3/4	2-3/8	1-13/16	1-3/16
2X1	2-7/16	1-13/16	1-3/16
2-1/2X1/2	2-9/16	2-1/16	1-3/16
2-1/2X3/4	2-11/16	2-1/8	1-3/16
2-1/2X1	2-3/4	2-1/8	1-3/16

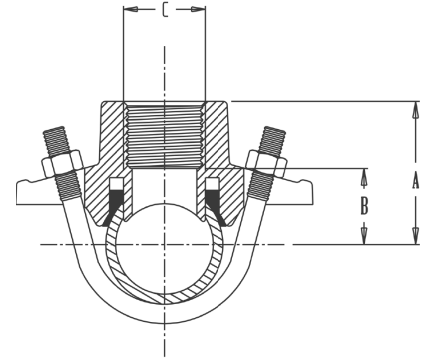

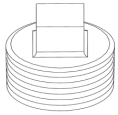

STEEL SQUARE HEAD PLUGS

DESCRIPTION	PCS PER BOX	PCS PER MASTER	WEIGHT PER 100	PART # BLACK	PRICE (US\$) BLACK	PART # GALV.	PRICE (US\$) GALV.
1/8"	100	600	2	A.BSP	* 0.65	A.NSP	* 0.66
1/4"	100	600	4	B.BSP	* 0.85	B.NSP	* 0.93
3/8"	75	450	6	C.BSP	* 1.18	C.NSP	* 1.22
1/2"	50	300	12	D.BSSP	* 1.97	D.NSSP	* 2.22
3/4"	50	200	18	E.BSSP	* 2.79	E.NSSP	* 3.19

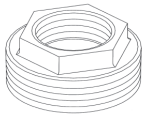

STEEL HEXAGON BUSHINGS

DESCRIPTION	PCS PER BOX	PCS PER MASTER	WEIGHT PER 100	PART # BLACK	PRICE (US\$) BLACK	PART # GALV.	PRICE (US\$) GALV.
1/4" X 1/8"	25	150	2	BXA.BSB	* 1.81	BXA.NSB	1.87
3/8" X 1/8"	25	150	5	CXA.BSB	* 2.14	CXA.NSB	* 2.32
3/8" X 1/4"	25	150	4	CXB.BSB	* 2.14	CXB.NSB	2.32
1/2" X 1/8"	25	150	8	DXA.BSB	* 3.83	DXA.NSB	3.72
1/2" X 1/4"	25	150	7	DXB.BSB	* 3.34	DXB.NSB	* 3.72
1/2" X 3/8"	25	150	6	DXC.BSB	* 3.34	DXC.NSB	* 3.72
3/4" X 1/8"	50	200	20	EXA.BSB	* 5.19	EXA.NSB	* 5.82
3/4" X 1/4"	50	200	16	EXB.BSB	* 5.19	EXB.NSB	* 5.82
3/4" X 3/8"	50	200	14	EXC.BSB	* 5.19	EXC.NSB	* 5.82
3/4" X 1/2"	50	200	10	EXD.BSB	* 5.19	EXD.NSB	* 5.82
1" X 1/8"	25	100	35	1XA.BSB	* 5.65	1XA.NSB	* 6.14
1" X 1/4"	25	100	31	1XB.BSB	* 5.65	1XB.NSB	* 6.51
1" X 3/8"	25	100	30	1XC.BSB	* 5.65	1XC.NSB	* 6.51
1" X 1/2"	25	100	25	1XD.BSB	* 5.65	1XD.NSB	* 6.51
1" X 3/4"	25	100	15	1XE.BSB	* 5.65	1XE.NSB	* 6.51

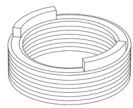

STEEL FLUSH BUSHINGS

DESCRIPTION	PCS PER BOX	PCS PER MASTER	WEIGHT PER 100	PART # BLACK	PRICE (US\$) BLACK	PART # GALV.	PRICE (US\$) GALV.
1/4" X 1/8"	25	150	1	BXA.BFB	1.92	BXA.NFB	2.00
3/8" X 1/4"	25	150	1	CXB.BFB	2.22	CXB.NFB	2.52
1/2" X 1/8"	25	150	5	DXA.BFB	4.79		
1/2" X 1/4"	25	150	3	DXB.BFB	5.08	DXB.NFB	6.09
1/2" X 3/8"	25	150	2	DXC.BFB	5.08	DXC.NFB	6.09
3/4" X 1/4"	25	150	8	EXB.BFB	7.12	EXB.NFB	8.54
3/4" X 3/8"	25	150	7	EXC.BFB	7.12	EXC.NFB	8.54
3/4" X 1/2"	25	150	5	EXD.BFB	* 7.12	EXD.NFB	* 8.54

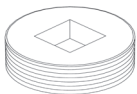

STEEL HEX SOCKET PLUGS

DESCRIPTION	PCS PER BOX	PCS PER MASTER	WEIGHT PER 100	PART # BLACK	PRICE (US\$) BLACK	PART # GALV.	PRICE (US\$) GALV.
1/8"	100	600	1	A.BSHSP	* 0.65	A.NSHSP	* 0.66
1/4"	100	600	2	B.BSHSP	* 0.85	B.NSHSP	* 0.87
3/8"	100	600	3	C.BSHSP	* 1.18	C.NSHSP	* 1.22
1/2"	100	600	7	D.BSHSP	* 1.97	D.NSHSP	* 2.09
3/8"	300	300	10	E.BSHSP	* 2.63	E.NSHSP	* 3.01



STEEL SQUARE HEAD COUNTERSUNK PLUGS

DESCRIPTION	PCS PER BOX	PCS PER MASTER	WEIGHT PER 100	PART # BLACK	PRICE (US\$) BLACK	PART # GALV.	PRICE (US\$) GALV.
1/4"	100	600	2	B.BCTP	* 0.85	B.NCTP	* 0.93
3/8"	75	450	2	C.BCTP	1.18	C.NCTP	1.22

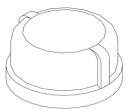

STEEL CAPS

DESCRIPTION	PCS PER BOX	PCS PER MASTER	WEIGHT PER 100	PART # BLACK	PRICE (US\$) BLACK	PART # GALV.	PRICE (US\$) GALV.
1/8"	50	300	3	A.BSCAP	* 1.61	A.NSCAP	* 1.69
1/4"	40	240	7	B.BSCAP	* 2.09	B.NSCAP	* 2.24
3/8"	40	240	9	C.BSCAP	* 3.11	C.NSCAP	* 3.39
1/2"	50	200	12	D.BSCAP	* 4.87	D.NSCAP	* 4.87
3/4"	25	150	16	E.BSCAP	* 10.28	E.NSCAP	* 11.37

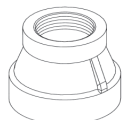

STEEL REDUCING COUPLINGS

DESCRIPTION	PCS PER BOX	PCS PER MASTER	WEIGHT PER 100	PART # BLACK	PRICE (US\$) BLACK	PART # GALV.	PRICE (US\$) GALV.
1/4" X 1/8"	25	150	9	BXA.BSC	* 9.11	BXA.NSC	* 11.42

