

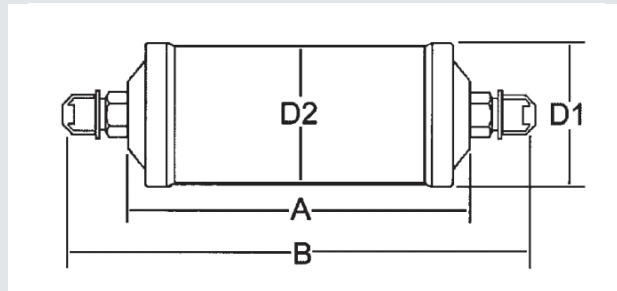

Features:

- Design Pressure (DP) / Maximum abnormal pressure (MAP): 700 psig
- Maximum working temperature: 160°F/70°C
- Compatible with all CFC, HCFC, HFC and HFO refrigerants and oils, and refrigerants requiring XH-11 desiccant
- UL/cUL Listed, Conforms to Pressure Equipment Directive 2014/68/EU
- Solid core design
- High retention filter for removal of particulate as small as 25 microns
- High pressure shell and connections
- Powder paint finish approved for marine applications
- 100% copper connection for solder models



Part Number	Model	Des Size (in)	Cu In	A (in)	B (in)	D1 (in)	D2 (in)	Wt (lb)	Liquid Capacity (tons)						Water Capacity (drops)											
									R1	R2	R3	R4	R5	R6	R134a		R404A		R507		R22		R407C		R410A	
									4	5	0	2	7	0	75°F	125°F	75°F	125°F	75°F	125°F	75°F	125°F	75°F	125°F	75°F	125°F
A 18184	FL-032	3 1/4		2.57	4.29	1.85	1.69	0.44	2	1	1	2	2	2	82	70	87	78	87	77	80	71	74	52	59	51
A 18185	FL-033	3 3/8		2.57	4.81	1.85	1.69	0.54	3	3	2	4	4	4	82	70	87	78	87	77	80	71	74	52	59	51
A 18186	FL-052	5 1/4		2.94	4.66	2.32	2.10	0.57	2	1	1	2	2	2	157	131	166	146	167	145	152	132	137	90	103	90
A 18187	FL-053	5 3/8		2.94	5.18	2.32	2.10	0.66	4	3	3	4	4	4	157	131	166	146	167	145	152	132	137	90	103	90
A 18188	FL-082	8 1/4		3.98	5.71	2.32	2.10	0.75	2	1	1	2	2	2	255	212	269	237	271	235	246	215	222	145	166	144
A 18189	FL-083	8 3/8		3.98	6.22	2.32	2.10	0.85	4	3	3	4	4	4	255	212	269	237	271	235	246	215	222	145	166	144
A 18190	FL-084	8 1/2		3.98	6.54	2.32	2.10	0.92	8	6	6	8	8	8	255	212	269	237	271	235	246	215	222	145	166	144
A 18191	FL-162	16 1/4		4.33	6.05	3.12	2.92	1.48	2	1	1	2	2	2	473	402	498	444	501	439	459	405	419	296	330	291
A 18192	FL-163	16 3/8		4.33	6.57	3.12	2.92	1.52	4	3	3	5	4	4	473	402	498	444	501	439	459	405	419	296	330	291
A 18193	FL-164	16 1/2		4.33	6.89	3.12	2.92	1.59	9	7	7	10	9	10	473	402	498	444	501	439	459	405	419	296	330	291
A 18194	FL-165	16 5/8		4.33	7.25	3.12	2.92	1.70	12	9	9	13	13	14	473	402	498	444	501	439	459	405	419	296	330	291
A 18195	FL-303	30 3/8		7.33	9.57	3.15	3.00	3.20	4	3	3	5	4	4	949	813	999	893	1006	885	925	817	846	607	673	595
A 18196	FL-304	30 1/2		7.33	9.89	3.15	3.00	3.27	9	7	7	10	10	10	949	813	999	893	1006	885	925	817	846	607	673	595
A 18197	FL-305	30 5/8		7.33	10.25	3.15	3.00	3.36	13	10	10	15	14	15	949	813	999	893	1006	885	925	817	846	607	673	595
A 18801	FL-306	30 3/4		7.33	10.17	3.15	3.00	1.44	12	11	11	15	15	17	949	813	999	893	1006	885	925	817	846	607	673	595
A 18198	FL-413	41 3/8		7.35	9.59	3.65	3.50	4.12	5	3	3	5	5	5	1279	1095	1346	1204	1355	1193	1246	1101	1140	819	908	802
A 18199	FL-414	41 1/2		7.35	9.91	3.65	3.50	3.98	10	7	7	11	10	11	1279	1095	1346	1204	1355	1193	1246	1101	1140	819	908	802
A 18200	FL-415	41 5/8		7.35	10.27	3.65	3.50	4.47	15	11	11	17	16	16	1279	1095	1346	1204	1355	1193	1246	1101	1140	819	908	802

Water capacity data rated according to AHRI 710 standards.



Features:

- Design Pressure (DP) / Maximum abnormal pressure (MAP): 700 psig
- Maximum working temperature: 160°F/70°C
- Contact factory or visit website for compatibility with CFC, HCFC, HFC and HFO refrigerants and oils
- UL/cUL Listed, Conforms to Pressure Equipment Directive 2014/68/EU
- Solid core design, composed of 70% activated alumina/ 30% molecular sieves for exceptional moisture and acid removal
- High retention filter for removal of particulate as small as 25 microns
- Dual access fitting for precise pressure drop measurements
- Powder paint finish approved for marine applications

Flare Connection

Part Number	Model	Dessicant Cu In	Size (in)	A (in)	B (in)	D1 (in)	D2 (in)	Wt (lb)	Nominal Capacity (tons) Evaporator Temp 40°F		
									R134a	R404A, R507	R22, R407C, R410A
A 18856	FDf-083-TT	8	3/8	3.98	6.22	2.32	2.1	0.54	1.2	1.3	1.8
A 18857	FDf-084-TT	8	1/2	3.98	6.54	2.32	2.1	0.54	1.5	2.3	2.8
A 18858	FDf-085-TT	8	5/8	3.98	6.9	2.32	2.1	0.55	2.7	3.6	4.3
A 17225	FDf-164-TT	16	1/2	4.33	6.89	3.12	2.92	1.63	1.8	2.5	3.2
A 17226	FDf-165-TT	16	5/8	4.33	7.25	3.12	2.92	1.50	2.8	3.9	4.4
A 18860	FDf-166-TT	16	3/4	4.33	7.17	3.12	2.92	0.95	3.3	4.8	5.7

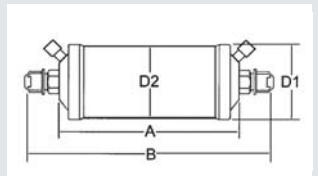

Solder Connection

Part Number	Model	Dessicant Cu In	Size (in)	A (in)	B (in)	C (in)	D1 (in)	D2 (in)	Wt (lb)	Nominal Capacity (tons) Evaporator Temp 40°F		
										R134a	R404A, R507	R22, R407C, R410A
A 18844	FDS-083-TT	8	3/8	3.98	4.70	5.43	2.32	2.10	0.43	1.2	1.3	1.8
A 18845	FDS-084-TT	8	1/2	3.98	4.84	5.71	2.32	2.10	0.43	1.5	2.3	2.8
A 18846	FDS-085-TT	8	5/8	3.98	4.92	5.87	2.32	2.10	0.43	2.7	3.6	4.3
A 17224	FDS-164-TT	16	1/2	4.33	5.20	6.06	3.12	2.92	1.50	1.8	2.5	3.2
A 17227	FDS-165-TT	16	5/8	4.33	5.28	6.22	3.12	2.92	1.52	2.8	3.9	4.4
A 17228	FDS-166-TT	16	3/4	4.33	5.35	6.69	3.12	2.92	1.56	3.3	4.8	5.7
A 17229	FDS-167-TT	16	7/8	4.33	5.19	6.77	3.12	2.92	1.59	4.1	5.5	6.4
A 17230	FDS-169-TT	16	1 1/8	4.33	5.16	6.81	3.11	3.00	1.45	4.8	6.6	7.6
A 17300	FDS-305-TT	30	5/8	7.34	8.29	9.22	3.11	3.00	3.08	3.1	4.2	5.0
A 17301	FDS-306-TT	30	3/4	7.34	8.52	9.70	3.11	3.00	3.10	3.8	5.4	6.2
A 17302	FDS-307-TT	30	7/8	7.34	8.36	9.78	3.11	3.00	3.13	4.3	6.2	7.2
A 17231	FDS-309-TT	30	1 1/8	7.34	8.17	9.81	3.11	3.00	3.27	5.7	7.5	8.8
A 17232	FDS-3011-TT	30	1 3/8	7.34	8.31	10.25	3.11	3.00	6.8	9.2	10.7	
A 17233	FDS-3013-TT	30	1 5/8	7.34	8.39	10.57	3.11	3.00	1.45	8.2	11.0	12.8
A 18889	FDS-415-TT	41	5/8	7.36	8.31	9.25	3.65	3.50	1.88	3.6	5.0	5.9
A 18890	FDS-416-TT	41	3/4	7.36	8.54	9.72	3.65	3.50	1.88	4.7	6.3	7.3
A 18891	FDS-417-TT	41	7/8	7.36	8.38	9.80	3.65	3.50	1.88	5.2	7.3	8.5
A 18892	FDS-419-TT	41	1 1/8	7.36	8.19	9.84	3.65	3.50	1.88	6.4	8.8	10.2
A 18893	FDS-4111-TT	41	1 3/8	7.36	8.33	10.27	3.65	3.50	1.88	7.6	10.3	12.0
A 18894	FDS-4113-TT	41	1 5/8	7.36	8.41	10.59	3.65	3.50	1.88	9.0	12.3	14.0

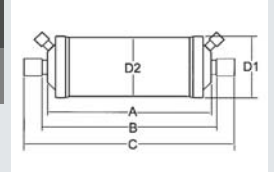



Features:

- Design Pressure (DP) / Maximum abnormal pressure (MAP): 700 psig
- Maximum working temperature: 160°F/70°C
- Compatible with all CFC, HCFC, HFC and HFO refrigerants and oils, and refrigerants requiring XH-11 desiccant
- UL/cUL Listed, Conforms to Pressure Equipment Directive 2014/68/EU
- Solid core design
- High retention filter for removal of particulate as small as 25 microns
- High pressure shell and connections
- Powder paint finish approved for marine applications
- 100% copper connection for solder models

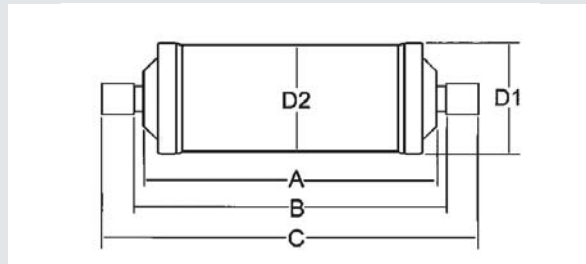

Part Number	Model	Des Size (in)	Cu In	A (in)	B (in)	C (in)	D1 (in)	D2 (in)	Wt (lb)	Liquid Capacity (tons)						Water Capacity (drops)											
										R	R	R	R	R	R	R134a		R404A		R507		R22		R407C		R410A	
										1	4	5	2	4	4	75°F	125°F	75°F	125°F	75°F	125°F	75°F	125°F	75°F	125°F	75°F	125°F
A 18598	SD-032	3 1/4		2.57	3.30	4.03	1.85	1.69	0.42	2	1	1	2	2	2	82	70	87	78	87	77	80	71	74	52	59	51
A 18599	SD-033	3 3/8		2.57	3.30	4.03	1.85	1.69	0.43	4	3	3	4	4	4	82	70	87	78	87	77	80	71	74	52	59	51
A 18654	SD-052	5 1/4		2.94	3.67	4.40	2.32	2.10	0.54	2	1	1	2	2	2	157	131	166	146	167	145	152	132	137	90	103	90
A 18655	SD-053	5 3/8		2.94	3.67	4.40	2.32	2.10	0.56	4	3	3	4	4	4	157	131	166	146	167	145	152	132	137	90	103	90
A 18656	SD-082	8 1/4		2.94	4.70	5.43	2.32	2.10	0.73	2	1	1	2	2	2	255	212	269	237	271	235	246	215	222	145	166	144
A 18657	SD-083	8 3/8		2.94	4.70	5.43	2.32	2.10	0.74	4	3	3	5	4	4	255	212	269	237	271	235	246	215	222	145	166	144
A 18658	SD-084	8 1/2		2.94	4.84	5.71	2.32	2.10	0.76	8	6	6	9	8	8	255	212	269	237	271	235	246	215	222	145	166	144
A 18699	SD-163	16 3/8		4.33	5.06	5.79	3.12	2.92	1.42	5	3	3	5	5	5	473	402	498	444	501	439	459	405	419	296	330	291
A 18700	SD-164	16 1/2		4.33	5.19	6.06	3.12	2.92	1.46	10	7	7	10	10	10	473	402	498	444	501	439	459	405	419	296	330	291
A 18701	SD-165	16 5/8		4.33	5.28	6.22	3.12	2.92	1.50	12	10	10	14	13	14	473	402	498	444	501	439	459	405	419	296	330	291
A 18702	SD-166	16 3/4		4.33	5.51	6.69	3.12	2.92	1.54	13	11	10	15	14	16	473	402	498	444	501	439	459	405	419	296	330	291
A 18703	SD-167	16 7/8		4.33	5.35	6.77	3.12	2.92	1.58	12	11	11	15	15	17	473	402	498	444	501	439	459	405	419	296	330	291
A 18741	SD-303	30 3/8		7.33	8.06	8.79	3.15	3.00	3.24	5	3	3	5	4	5	949	813	999	893	1006	885	925	817	846	607	673	595
A 18742	SD-304	30 1/2		7.33	8.20	9.07	3.15	3.00	3.10	10	7	7	11	10	11	949	813	999	893	1006	885	925	817	846	607	673	595
A 18743	SD-305	30 5/8		7.33	8.28	9.22	3.15	3.00	2.97	14	11	11	16	15	16	949	813	999	893	1006	885	925	817	846	607	673	595
A 18800	SD-306	30 3/4		7.33	8.52	9.70	3.15	3.00	3.20	13	11	11	15	15	16	949	813	999	893	1006	885	925	817	846	607	673	595
A 18744	SD-307	30 7/8		7.33	8.36	9.78	3.15	3.00	3.01	19	15	14	21	20	22	949	813	999	893	1006	885	925	817	846	607	673	595
A 18745	SD-309	30 1 1/8		7.33	8.16	9.81	3.15	3.00	3.26	24	20	19	28	27	30	949	813	999	893	1006	885	925	817	846	607	673	595
A 18746	SD-413	41 3/8		7.35	8.08	8.81	3.65	3.50	4.13	5	4	3	6	5	5	1279	1095	1346	1204	1355	1193	1246	1101	1140	819	908	802
A 18747	SD-414	41 1/2		7.35	8.22	9.09	3.65	3.50	4.02	10	8	8	11	11	12	1279	1095	1346	1204	1355	1193	1246	1101	1140	819	908	802
A 18748	SD-415	41 5/8		7.35	8.30	9.24	3.65	3.50	4.05	16	12	12	17	16	17	1279	1095	1346	1204	1355	1193	1246	1101	1140	819	908	802
A 18749	SD-417	41 7/8		7.35	8.38	9.80	3.65	3.50	4.41	19	15	15	22	21	23	1279	1095	1346	1204	1355	1193	1246	1101	1140	819	908	802
A 18823	SD-419	41 1 1/8		7.35	8.18	9.83	3.65	3.50	1.83	24	19	18	27	26	28	1279	1095	1346	1204	1355	1193	1246	1101	1140	819	908	802

Water capacity data rated according to AHRI 710 standards.