

Service Equipment - Pedestals

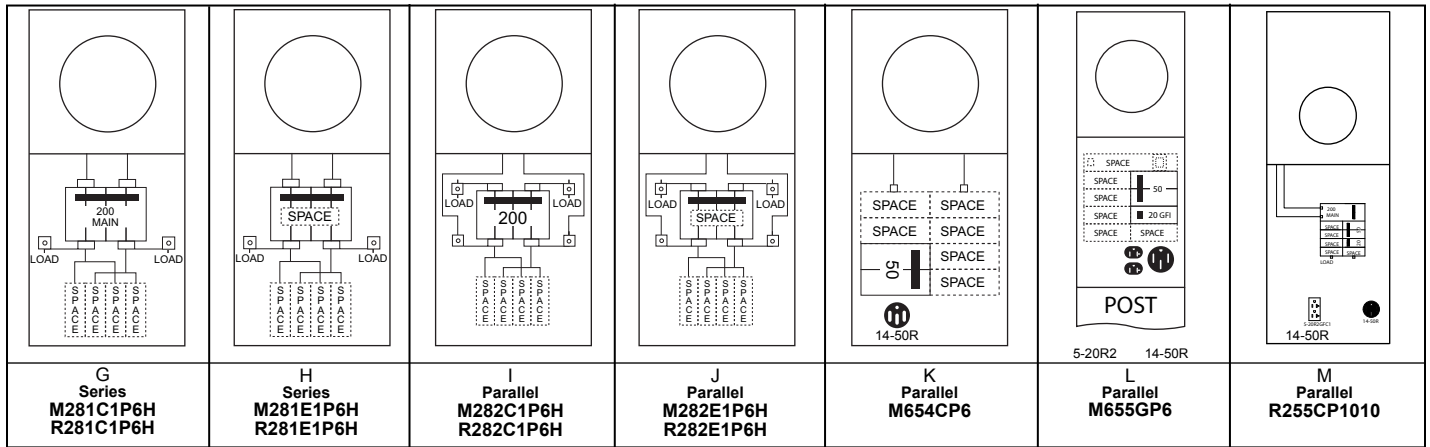

200A - Metered

Service Equipment

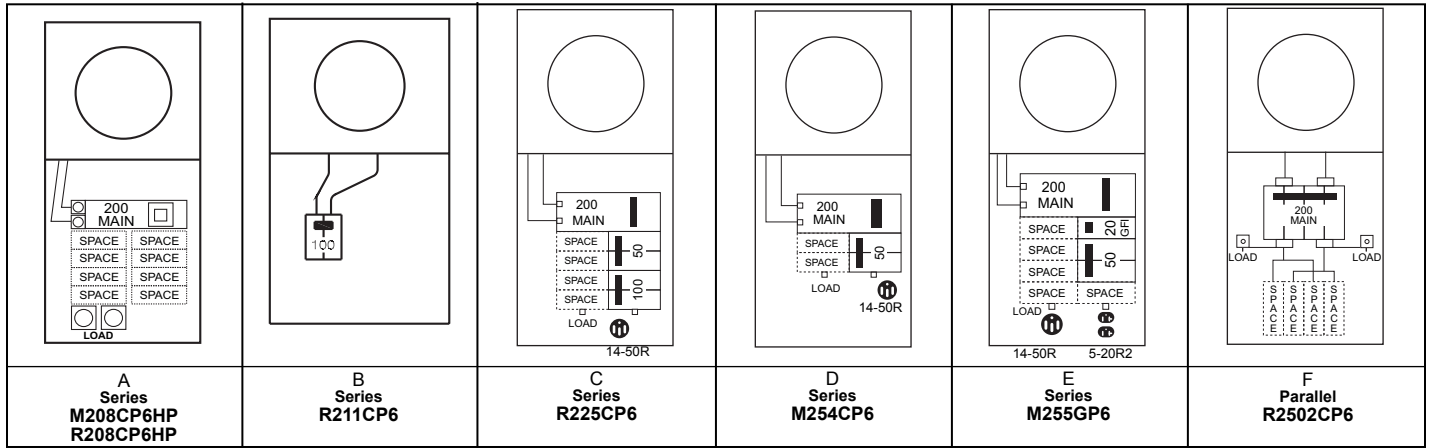

Inline & Head Post

FIG.	MODEL NUMBER		INSTALLED BREAKER	SPACES	WIRE RANGE*	CABINET SIZE	LOAD CENTER		UNIT WT.	STD. PKG.	UL
	RINGTYPE	RINGLESS					TOP	BOTTOM			
A	M208CP6HP	R208CP6HP	CB2200B	8	S	14HP	LC1212PC		85	1	Y
B	—	R211CP6	CB2100	0	S	9PT	PC2LC		53	1	Y
C	—	R225CP6 ¹	CB2200B CB2100, CB250	4	S	14PT	LC1212PC		88	1	Y
D	M254CP6 ¹	—	CB2200B, CB250	2	S	14PT	LC88PC		96	1	Y
E	M255GP6 ¹	—	CB2200B CB250, GF1120	5	S	14PT	LC1212PC		87	1	Y
F	—	R2502CP6	CB4200H	4	BM	9PT	LCTL	LCBS	53	1	Y
G	M281C1P6H ^{2,3}	R281C1P6H ³	CB4200H	4	S	6H	LCTNL	LCBS	68	1	Y
H	M281E1P6H	R281E1P6H	—	5	S	6H	LCTNL	LCBS	67	1	Y
I	M282C1P6H ^{2,4}	R282C1P6H	CB4200H	4	S	6H	LCTNL	LCBS	69	1	Y
J	M282E1P6H ²	R282E1P6H	—	5	S	6H	LCTNL	LCBS	68	1	Y
K	M654CP6 ¹	—	CB250	6	S	14PT	LC88PC		85	1	Y
L	M655GP6 ¹	—	CB250, GF1120	9	S	14PT	LC1212PC		85	1	Y
M	—	R225CP6010	CB2200B, CB250, CB120	5	S	14PT	LC1212PC		88	1	N

¹ Rated as Temporary Site Service Equipment

² Available w/ GFCI Receptacle installed – add “010” after model number

³ Available in Ring Type w/ stud termination and copper wire - M281C1S6HC, R281C1S6HC

⁴ Available in Ring Type w/ stud termination - M281C1S6H & M282C1S6H

³ Available in Ring Type w/ stud termination and copper wire - M281C1S6HC, R281C1S6HC

⁴ Available in Ring Type w/ copper wire - M282C1P6HC

* Wire Range Table page 33

Technical Data

MODEL NUMBER*	HUB OPENING	REPLACEMENT PARTS		CABINET SIZE	ENCLOSURE STYLE page 28	CABINET DIMENSIONS			KNOCKOUT FIGURE page 29	AIC
		METER SOCKET	POST LUGS			HEIGHT	WIDTH	DEPTH		
						A	B	C		
MS251C	Y	MW200M	—	17 X 26	E	26-1/4"	17-1/2"	5-1/2"	10	10,000
MS252C	Y	MW200M	—	17 X 26	E	26-1/4"	17-1/2"	5-1/2"	10	10,000
MS252E014	Y	*	—	14 X 31	E	14-3/4"	31-5/16"	5-7/8"	7B	10,000
MS45500C	N	265A5264P2	—	31 X 33	E	33-1/10"	30-1/2"	6-1/10"	P. 32	22,000
MS45508C	N	265A5264P2	—	31 X 33	E	33-1/10"	30-1/2"	6-1/10"	P. 32	22,000
R100C	Y	MSR100930	—	9 X 30	C	30"	9-3/4"	5-3/16"	3	10,000
R100T	Y	MSR100930	—	9 X 30	C	30"	9-3/4"	5-3/16"	3	10,000
R101C	Y	MSR100930	—	9 X 30	C	30"	9-3/4"	5-3/16"	3	10,000
R101CB2	Y	MW200R	—	14 X 26	D	26-1/4"	14-3/4"	4-9/16"	6	10,000
R101CB2LK	Y	MW200R	—	14 X 26	D	26-1/4"	14-3/4"	4-9/16"	6	10,000
R101CB2010	Y	MW200R	—	14 X 26	D	26-1/4"	14-3/4"	4-9/16"	6	10,000
R101CB6	N	MSR100P9	LT100B250	9PT				See page 30		10,000
R101CB6HP	N	MSR100P9	LT200B350	9HP				See page 30		10,000
R101CP6	N	MSR100P9	LT100S250	9PT				See page 30		10,000
R101CP6HP	N	MSR100P9	LT200S350	9HP				See page 30		10,000
R102CB2	Y	MW200R	—	14 X 26	D	26-1/4"	14-3/4"	4-9/16"	6	10,000
R102CB2LK	Y	MW200R	—	14 X 26	D	26-1/4"	14-3/4"	4-9/16"	6	10,000
R102E	Y	MSR100930	—	9 X 30	C	29-1/2"	9-1/4"	5-3/16"	1	10,000
R102EN	Y	MSR100930	—	9 X 30	C	29-1/2"	9-1/4"	5-3/16"	1	10,000
R181CB1	Y	MSRS	—	14 X 28	D	28-1/2"	14-3/10"	4-4/5"	6	10,000
R200T	Y	MW200R	—	14 X 38	C	38-3/8"	14-3/4"	6-3/8"	8	10,000
R208CP6HP	N	MW200R	LT200S350	14HP				See page 30		10,000
R208CR2A	Y (2)	MW200R	—	14 X 28	C	28-5/8"	14-3/4"	6-3/8"	8	10,000
R208CR2A034	Y	265A5264P8	—	14 X 28	C	28-5/8"	14-3/4"	6-3/8"	8	10,000
R211CP6	N	MSRS	—	*				See page 30		10,000
R225CP6	N	MW200R	LT200S350	14PT						10,000
R2502CP6	N	MSRS	—	*	*	*	*	*	*	10,000
R256EB1A	Y	198B8601G70	—	14 X 26	D	26-1/4"	14-3/4"	4-9/16"	6	10,000
R256EB1018A	Y	198B8601G70	—	14 X 26	D	26-1/4"	14-3/4"	4-9/16"	6	10,000
R256EB1NA	Y	198B8601G70	—	14 X 26	D	26-1/4"	14-3/4"	4-9/16"	6	10,000
R280T	Y	MW200R	—	9 X 32	C	32-1/4"	9-3/4"	5-11/16"	4	10,000
R280TP6HP	N	MW200R	LT200S350	9HP				See page 30		10,000
R281C1	Y	MSRS	—	9 X 30	D	30-1/4"	9-5/16"	4-3/4"	12	22,000
R281C1034	Y	265A5264P8	—	14 X 32	D	32-1/2"	14-1/2"	5-7/16"	15	22,000
R281C1B6H	N	MSRP	LT200B350	6H				See page 31		22,000
R281C1B6H034	N	265A5264P8	LT200B350	6H034				See page 31		22,000
R281C1P6H	N	MSRP	LT200S350	6H				See page 31		22,000
R281C1P6H034	N	265A5264P8	LT200S350	6H034				See page 31		22,000
R281C1S6HC	N	MSRP	LT200SS	6H				See page 31		22,000
R281CB1	Y	MSRS	—	14 X 28	D	28-5/8"	14-3/8"	4-3/4"	13	22,000
R281CB1034	Y	265A5264P8	—	14 X 28	D	28-5/8"	14-3/8"	4-3/4"	13	22,000
R281CB1LK	Y	MSRS	—	14 X 28	D	28-5/8"	14-3/8"	4-3/4"	13	22,000
R281E1B6H	N	MSRP	LT200B350	6H				See page 31		22,000
R281E1B6H034	N	265A5264P8	LT200B350	6H034				See page 31		22,000
R281E1P6H	N	MSRP	LT200S350	6H				See page 31		22,000
R281E1P6H034	N	265A5264P8	LT200S350	6H034				See page 31		22,000
R281EB1	Y	MSRS	—	14 X 28	D	28-5/8"	14-3/8"	4-3/4"	13	22,000
R281EB1034	Y	265A5264P8	—	14 X 28	D	28-5/8"	14-3/8"	4-3/4"	13	22,000
R282C1B6H	N	MSRP	LT200B350	6H				See page 31		22,000
R282C1P6H	N	MSRP	LT200S350	6H				See page 31		22,000
R282CB1	Y	MSRS	—	14 X 28	D	28-5/8"	14-3/8"	4-3/4"	13	22,000
R282CB1LK	Y	MSRS	—	14 X 28	D	28-5/8"	14-3/8"	4-3/4"	13	22,000
R282E1B6H	N	MSRP	LT200B350	6H				See page 31		22,000
R282E1P6H	N	MSRP	LT200S350	6H				See page 31		22,000
R282EB1	Y	MSRS	—	14 X 28	D	28-5/8"	14-3/8"	4-3/4"	13	22,000
R460CP6034	N	265A5264P10	*	14PT				See page 30		22,000

* Not all models listed; contact local representative for other models and details.

Data subject to change without notice.

Service Equipment